

Dodge County Board of Supervisors
January 21, 2020 – 7:00 p.m.
Administration Building - Juneau, Wisconsin

The January Session of the Dodge County Board of Supervisors was called to order by Chairman Russell Kottke at 7:00 p.m.

The Board rose to say the Pledge of Allegiance.

Roll call was taken by the Clerk with all Supervisors being in attendance with the exception of Supervisors Behl, Schaefer, Schraufnagel and Sheahan-Malloy who had previously asked to be excused.

Chairman Kottke called for approval of the minutes. A motion was made by Supervisor Nickel and seconded by Supervisor Greshay to approve the minutes of the December 17, 2019, session of the County Board meeting as recorded, and dispense with the reading of the minutes. The motion passed by acclamation with no negative votes cast, and was so ordered by the Chairman.

Communications on File

Karen J. Gibson, County Clerk, reported there were no communications on file.

Special Orders of Business

Chairman Kottke called the First Order of Business: Confirm Appointment made by County Board Administrator, James Mielke. Appoint Scott Smith to the position of Dodge County Highway Safety Coordinator effective January 14, 2020. Scott Smith will serve at the pleasure of the County Administrator. A motion to accept the appointment was made by Supervisor Maly and seconded by Supervisor Miller. The motion passed by acclamation with no negative votes cast, thereby approving the appointment.

Chairman Kottke called upon Marie Witzel, 4-H/Youth Development Educator who named the 2019 4-H Key Award winners: Kendra Gillett, Marshall McGauley and Faith Rinzel. Kendra Gillett, Marshall McGauley (via video as he was unable to attend) and Faith Rinzel (via video as she was unable to attend) addressed the County Board of Supervisors, telling them about their many 4-H experiences and also thanking the board and citizens of Dodge County for their support of the 4-H program. Chairman Kottke congratulated Ms. Gillett and presented her with a commendation certificate recognizing her 4-H key award achievement. Ms. Witzel presented Ms. Gillett with a letter from Governor Tony Evers' Office, a certificate of special senatorial recognition from Senator Ronald Johnson and a citation from the State of Wisconsin from Representative Jon Plumer.

Chairman Kottke called upon Amy Nehls, Emergency Management Director who introduced Dana Sechler, Vice President of Strategic Management & Consulting. Mr. Sechler gave a presentation on the Dodge County EMS Study. He outlined the Ambulance System and EMS Operations Evaluation, Review, Findings and Recommendations prepared by Strategic Management & Consulting. Questions by Supervisors Derr and J. Schmitt answered by Mr. Sechler. Comment by Supervisor J. Schmitt.

The following Resolutions and Report were read by the Clerk and acted upon by the Board:

Resolution No. 19-60 Amend Town of Emmet Zoning Ordinance – Windwood LLC Property – Town of Emmet – Supervisor Allen Behl. A motion for adoption was made by Supervisor Berres and seconded by Supervisor D. Schmidt. Question by Supervisor Houchin answered by Supervisor Marsik. The vote was cast with 27 ayes and 1 no, thereby adopting the Resolution.

Ayes: Benter, Kottke, Macheel, J. Schmitt, Marsik, Bennett, Greshay, Kriewald, Guckenberger, Fink, Muche, Kemmel, Bischoff, Caine, Berres, Houchin, Roesch, Frohling, D. Schmidt, Hoekstra, Nickel, Maly, Hilbert, Miller, Burnett, Derr, Glewen. Total 27.

No: Bobholz. Total 1.

Absent: Schaefer, Schraufnagel, Behl, Sheahan-Malloy. Total 4.

Resolution No. 19-61 Resolution Authorizing Labor Agreement Between Dodge County and Dodge County Highway Department, Local 730 – Human Resources and Labor Negotiations Committee. A motion for adoption was made by Supervisor Marsik and seconded by Supervisor Greshay. Comment by Supervisor D. Schmidt. The vote was cast with all voting in the affirmative, thereby adopting the Resolution.

Resolution No. 19-62 Resolution Authorizing the Construction and Internal Borrowing for the Reeseville Highway Shop – Highway Committee. A motion for adoption was made by Supervisor Caine and seconded by Supervisor Frohling. Supervisor Frohling made a motion to amend Resolution 19-62 by striking the words “and interest” on Page 2, line 34 and on Page 3, line 20 and adding a No. 6 to Page 3 to read: The Dodge County Highway Department shall budget for annual interest payments in each of the following years: 2021, 2022, 2023, 2024 and 2025. The motion to amend was seconded by Supervisor Caine. Kimberly Nass, Corporation Counsel advised the Board that she prepared a revised resolution with the amendment which was being placed on their desks. Question by Supervisor J. Schmitt answered by Chairman Kottke, Kimberly Nass, Corporation Counsel and Supervisor Frohling. The vote was cast with all voting in the affirmative, thereby adopting the motion to amend.

Question by Supervisor J. Schmitt answered by Brian Field, Highway Commissioner. Supervisor J. Schmitt made a motion to amend Resolution 19-62 by changing the amount of \$3,468,317 to \$3,559,311 on Page 2, lines 12, 20 and 23 and on Page 3, lines 4, 6, 9 and 30. Exhibits “B” & “C” were also amended to reflect said change. The motion to amend was seconded by Supervisor Maly. Kimberly Nass, Corporation Counsel distributed another revised resolution containing Supervisor Schmitt’s amendment. Questions by Supervisors Glewen and Derr answered by Brian Field, Highway Commissioner and Supervisor J. Schmitt. Comments by Brian Field, Highway Commissioner and Supervisors J. Schmitt, Caine, Maly, Guckenberger and Greshay. The vote was cast with 23 ayes and 5 noes, thereby adopting the motion to amend

Ayes: Benter, Kottke, Bobholz, Macheel, J. Schmitt, Marsik, Bennett, Kriewald, Guckenberger, Fink, Kemmel, Bischoff, Caine, Berres, Houchin, Frohling, D. Schmidt, Hoekstra, Nickel, Maly, Miller, Burnett, Glewen. Total 23.

Noes: Greshay, Muche, Roesch, Hilbert, Derr. Total 5.

Absent: Schaefer, Schraufnagel, Behl, Sheahan-Malloy. Total 4.

The vote was cast on Resolution 19-62 as amended, with all voting in the affirmative, thereby adopting the Resolution as amended.

Report No. 1 Ordinance No. 1040 – Amend Land Use Code – Waldemar Schlieve – Town of Hustisford – Land Resources and Parks Committee. A motion for adoption was made by Supervisor Muche and seconded by Supervisor Guckenberger. The vote was cast with all voting in the affirmative, thereby adopting the Report and Ordinance.

The Clerk noted the following had been placed on the Supervisor’s desks: Winter 2020 Aging and Disability Resource Center Newsletter, Memo dated January 21, 2020, from the External Audit Review Oversight Committee: Joseph Marsik, Chair, David Frohling, Russell Kottke, MaryAnn Miller and Dan Hilbert regarding the operational and financial review of the Dodge County Sheriff’s Department, Memo dated January 21, 2020 from Kimberly Nass, Corporation Counsel regarding Wisconsin Counties Association Legal Opinion Regarding County Sheriff Authority over Personnel Matter, Memo dated January 21, 2020 from Sarah Hinze, Human Resources Director regarding Resolution #19-61 Authorizing Labor Agreement between Dodge County and Dodge County Highway Union Local 730 and Ambulance System and EMS Operations Evaluation, Review, Findings, and Recommendations prepared by Strategic Management & Consulting. The Chair ordered these be placed on file.

At 8:42 p.m. Supervisor Frohling made a motion to recess until Tuesday, February 25, 2020 at 7:00 p.m. Supervisor Frohling reminded the Board that the February meeting is the fourth Tuesday of February due to the February 18, 2020 Spring Primary Election. D. Schmidt seconded the motion. The motion passed by acclamation, with no negative votes cast, and was so ordered by the Chairman.

Disclaimer: The above minutes may be approved, amended or corrected at the next meeting.

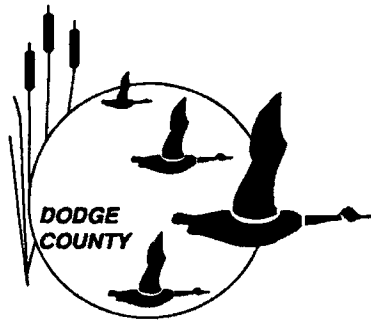

ADMINISTRATION DEPARTMENT

JAMES MIELKE, COUNTY ADMINISTRATOR

127 East Oak Street, Juneau, Wisconsin, 53039 (920) 386-4251

**County Project and Issue Update
Volume 59 February 2020**

ERP Project: The Dodge County Project Team continues to work with the Tyler implementation team to review Tickets / Open Cases and discuss areas for further training. As the go-live is now in week 8, the end users with hands on working experience are becoming more familiar with the system's capabilities.

Training has been scheduled in April for larger departments related to the budgeting module, followed by the remaining departments in June. The budget training timeline was purposefully scheduled in the April – June timeframe to provide an opportunity for department heads to have hands on experience prior to starting the budget module.

Clearview Executive Director Recruitment: First Round interviews are scheduled for Friday, February 21st. A total of six applicants have been invited to participate in the first round. The applicant pool did not include an internal candidate(s). The date of second interviews will be determined upon the completion of the first round of interviews.

The interview panel consists of: Health Facilities Chair Larry Bischoff, Clearview Administration team members Lori Kurtz; Jackie Kuhl and Heather Hurley. In addition, Sarah Hinze and I will participate in the interview process.

The goal is to present an appointment Resolution sponsored by the Health Facilities Committee to the County Board on March 17th. If the timeline does not enable an appointment Resolution to be presented at the March 17th meeting, the appointment Resolution would be brought forward on April 21st.

Proposed Shared Positions – Jefferson County: Discussions with the Jefferson County Administrator, Human Resource Director and Finance Director have and continue to take place with Sarah Hinze, David Ehlinger, Kim Nass and me regarding the potential for Dodge and Jefferson counties to share two distinct positions: Purchasing Agent and Risk Manager. Currently, Dodge County has a vacant funded Purchasing Agent position and Jefferson County has a vacant, budgeted Risk Manager / Safety Coordinator position.

The concept of shared positions has been reviewed with the Executive, Human Resource and Finance Committees. At this time, a business case document is being created through the combined resources of both counties. Various Jefferson County committees have reviewed the proposed shared positions.

The goal is to bring forward an official recommendation in either March or April. If approved by both counties, the shared positions would enable each county to acquire two skill sets which are not currently available in either county.

Compensation Study: The Job Description Questionnaire phase of the study has been completed. The Job Description Questionnaires will be made available to the McGrath team. Group meetings with employees will be scheduled in March.

INVOICES OVER \$10,000

VENDOR	NAME	DBA	INVOICE	P.O.	INV DATE	CHECK RUN	CHECK NO	INVOICE NET	STS	INVOICE DESCRIPTION	CHECK DATE
211	COUNTY OF TREMPEALEAU		113019		43799	01092020	1,660,363	10,005.15	PD	INPATIENT	1/9/2020
1137	VALERIE SMITH	BLACKBERRY HILL INC	BLACKBERRY MR 2019		43831	01092020	1,660,356	10,075.00	PD	MI - CBRF 12/19	1/9/2020
1241	SHANNON JAMES LLC		12/31/19		43830	012320	1,660,702	10,218.75	PD	CCS 12/19	1/23/2020
211	COUNTY OF TREMPEALEAU	Trempealeau County Health Care Center	KW DEC 2019		43830	012320	1,660,523	10,283.23	PD	INPATIENT 12/19	1/23/2020
394	TOMORROWS CHILDREN INC		394011320201		43843	02012	1,660,499	10,354.00	PD	0008021021	1/15/2020
394	TOMORROWS CHILDREN INC		394011320202		43843	02012	1,660,499	10,354.00	PD	0008021021	1/15/2020
1243	DELL MARKETING LP		10367279320	20000016	43841	02062020	218	10,502.00	PD	MONITOR REPLACEMENTS	2/6/2020
394	TOMORROWS CHILDREN INC		394020520201		43866	02014	1,661,049	10,509.00	PD	0008021021	2/14/2020
394	TOMORROWS CHILDREN INC		394020520202		43866	02014	1,661,049	10,509.00	PD	0008021021	2/14/2020
1431	FAMILY SERVICES OF NORTHEAST WISCONSIN INC		1431011320201		43843	02012	1,660,483	10,550.54	PD	0008020562	1/15/2020
1	ONE TIME VENDOR		FORFEITURE		43833	010620	1,660,350	10,747.50	PD	FORFEITURE TO BE PAID TO US MARSHAL SERVICE ON SPE	1/6/2020
460	COUNTY OF FOND DU LAC		11302019		43808	02062020	1,660,785	10,800.00	PD	ACUTE UNIT SERVICES	2/6/2020
1431	FAMILY SERVICES OF NORTHEAST WISCONSIN INC		1431020520201		43866	02014	1,661,030	10,807.22	PD	0008020562	2/14/2020
294	WESTERN CULVERT & SUPPLY INC		059659		43847	02062020	1,660,987	10,949.00	PD	MATERIALS	2/6/2020
1395	ARAMARK SERVICES INC	ARAMARK CORRECTIONAL SERVICES	200790600-000918		43824	01092020	1,660,352	11,100.41	PD	INMATE MEALS 12/19-12/25	1/9/2020
1395	ARAMARK SERVICES INC	ARAMARK CORRECTIONAL SERVICES	200790600-00920		43831	012320	1,660,505	11,192.78	PD	INMATE MEALS 12/26 - 1/1	1/23/2020
119	WI COUNTIES ASSOCIATION		12052019	20000011	43804	012320	1,660,729	11,312.00	PD	WCA MEMBERSHIP DUES	1/23/2020
1395	ARAMARK SERVICES INC	ARAMARK CORRECTIONAL SERVICES	200790600-000916		43817	01092020	1,660,352	11,448.18	PD	INMATE MEALS 12/12-12/18	1/9/2020
664	WI DEPT OF ADMINISTRATION		MARRIAGE DOG LICENSE		43860	02062020	1,660,992	11,580.03	PD	MARRIAGE DOG LICENSE FEES 2019 DODGE CTY	2/6/2020
700	COMPLETE OFFICE OF WISCONSIN INC	EMMONS BUSINESS INTERIORS	150772		43812	01092020	13	11,837.78	PD	ES FURNITURE	1/9/2020
1395	ARAMARK SERVICES INC	ARAMARK CORRECTIONAL SERVICES	200790600-000914		43810	01092020	1,660,352	11,877.89	PD	INMATE MEALS FOR 12/5-12/11	1/9/2020
162	ARAMARK UNIFORM & CAREER APPAREL GROUP INC	ARAMARK UNIFORM & CAREER APPAREL LLC	200790600-000914		43831	02062020	196	11,877.89	PD	INMATE MEALS 12/5-12/11	2/6/2020
1395	ARAMARK SERVICES INC	ARAMARK CORRECTIONAL SERVICES	200790600-000922		43838	02062020	1,660,763	11,886.97	PD	INMATE MEALS 1/2-1/8/20	2/6/2020
1368	DELTA DENTAL		331234		43838	DD010820	200,070,121	11,927.41	PD	DELTA DENTAL WI ASD PYMT	1/8/2020
684	MATRIX CONSULTING GROUP		19-04 #6		43664	012320	1,660,565	11,931.00	PD	SHERIFF'S OPERAT AND FINANCIAL REVIEW - 7/18/19	1/23/2020
814	CLINICARE CORP	EAU CLAIRE ACADEMY	814011320201		43843	02012	1,660,479	12,041.02	PD	0008020569	1/15/2020
1395	ARAMARK SERVICES INC	ARAMARK CORRECTIONAL SERVICES	200790600-000924		43845	02062020	1,660,764	12,050.56	PD	INMATE MEALS 1/9-1/15/20	2/6/2020
1505	BOND TRUST SERVICES CORPORATION		52511		43860	DD013020	200,130,031	12,075.00	PD	INTEREST PAYMENTS REF #37662	1/30/2020
856	ADULT CARE CONSULTANTS INC		15473;15477-90		43799	012320	102	12,127.50	PD	CCS MEDICATION MANAGEMENT NOV	1/23/2020
34	CAPITAL DATA INC		37427		43816	01092020	12	12,168.50	PD	NETWORK EDGE SWITCH	1/9/2020
91	ENERGY SERVICES INC		1737		43799	01092020	1,660,370	12,388.55	PD	NOVEMBER	1/9/2020
551	IRON RIDGE PUBLIC LIBRARY		LIB 2020		43864	02062020	1,660,818	12,438.00	PD	2020 LIBRARY PAYMENT	2/6/2020
502	CITY OF WATERTOWN		C WTTN CHBK PYMT		43853	02062020	1,660,781	12,446.20	PD	2018 ROLL REFUNDED PP TAX 291-9000-5050-000	2/6/2020
814	CLINICARE CORP	EAU CLAIRE ACADEMY	814020520201		43866	02014	1,661,025	12,464.79	PD	0008020569	2/6/2020
825	OCONOMOWOC DEVELOPMENT TRAINING CENTER OF WI		825011320201		43843	02012	81	12,502.30	PD	0008019479	2/14/2020
1387	OTIS ELEVATOR CO		CMM05050120		43819	012320	1,660,696	12,517.80	PD	ELEVATOR SERVICE/MAINTENANCE	1/23/2020
1341	US BANK		US802072020		43868	DD020720	200,380,088	12,903.75	PD	NON EBC EE/ER CONTRIBUTIONS	2/7/2020
1041	LEXIPOL LLC		32109		43809	012320	1,660,561	12,939.00	PD	ONLINE POLICY MANUAL	1/23/2020
578	TOWN HALL LIBRARY		LIB 2020		43864	02062020	1,660,974	12,988.00	PD	2020 LIBRARY PAYMENT	2/6/2020
825	OCONOMOWOC DEVELOPMENT TRAINING CENTER OF WI		825020520201		43866	02014	326	13,015.66	PD	0008019479	2/14/2020
749	LOMIRA QUAD GRAPHICS COMMUNITY LIBRARY		LIB 2020		43864	02062020	1,660,844	13,300.00	PD	2020 LIBRARY PAYMENT	2/6/2020
1413	MCKESSON MEDICAL SUPPLY		70594984/71253698		43838		0	13,643.98	PD	#645.1641.14-\$2382.72/645.1641.13-\$8442.57/4520.5	
1458	YOUTH VILLAGES		1458020520201		43866	02014	346	13,950.00	PD	0008080185	2/14/2020
1438	FEIL'S CATERING		E191231		43830	012320	129	14,206.01	PD	3,029 MEALS DELIVERED @ \$4.69 EA	1/23/2020
956	CANNON COCHRAN MANAGEMENT SERVICES INC		0080282-IN		43830	01092020	10	14,220.58	PD	CCMSI WORKERS COMP FUND REIMBURSEMENT	1/9/2020
751	NATIONWIDE TRUST COMPANY FSB		NR02072020		43868	02072020	1,661,015	14,264.50	PD	Deferred Compensation	2/7/2020
237	ENVIRONMENTAL SYSTEMS RESEARCH INSTITUTE INC	ESRI INC	93760465		43838		0	14,800.00	PD	LIO - MAINTENANCE AND LICENSES	
744	EMPLOYEE BENEFIT CORPORATION (EBC)		EBC02072020		43868	DD020720	200,380,089	15,170.35	PD	EBC EE/ER CONTRIBUTIONS	2/7/2020
1341	US BANK		US801242020		43854	DD012420	200,240,090	15,174.50	PD	NON EBC EE/ER CONTRIBUTIONS	1/24/2020
751	NATIONWIDE TRUST COMPANY FSB		12292019		43828	01092020	1,660,384	15,180.73	PD	PEHP PAYOUT FOR L.S.	1/9/2020
91	ENERGY SERVICES INC		1762		43830	012320	1,660,540	15,481.38	PD	DECEMBER 2019	1/23/2020
213	YOUTH VILLAGES		213011320201		43843	02012	99	15,500.00	PD	0008057966	1/15/2020
213	YOUTH VILLAGES		213020520201		43866	02014	345	15,500.00	PD	0008057966	2/14/2020
751	NATIONWIDE TRUST COMPANY FSB		NR01242020		43853	012420	1,660,751	15,754.50	PD	DEFERRED COMPENSATION	1/24/2020
751	NATIONWIDE TRUST COMPANY FSB		NR 01-10-20		43839	011020	1,660,469	15,754.50	PD	DEFERRED COMPENSATION	1/24/2020
1368	DELTA DENTAL		336296		43852	DD012220	200,210,142	15,941.54	PD	DELTA DENTAL WI ASD PYMT	1/10/2020
34	CAPITAL DATA INC		37399		43831	01092020	12	16,108.68	PD	PRO SOFTWARE SUPPORT	1/22/2020
1191	HEARTLAND BUSINESS SYSTEMS LLC		354372-H		43839	02062020	1,660,811	16,114.75	PD	FILE DIRECTOR SUPPORT RENEWAL	1/9/2020
746	HUTCHINSON MEMORIAL LIBRARY		LIB 2020		43864	02062020	1,660,815	16,296.00	PD	2020 LIBRARY PAYMENT	2/6/2020
863	ROBERTSON RYAN & ASSOC INC		103409		43817	01092020	29	16,393.48	PD	20-21 PROFESSIONAL LIABILITY POLICY RENEWAL	1/9/2020
751	NATIONWIDE TRUST COMPANY FSB		1152020 C SCHWAB		43853	02062020	1,660,856	16,479.54	PD	PEHP PLAN PAYOUT CAROL SCHWAB	2/6/2020

141	EDWARD H WOLF & SONS INC	242948		43836 01092020	1,660,369	16,721.27	PD	GAS & DIESEL	1/9/2020
141	EDWARD H WOLF & SONS INC	244631		43852 02062020	1,660,799	16,796.42	PD	FUEL	2/6/2020
141	EDWARD H WOLF & SONS INC	244747		43853 02062020	1,660,799	16,894.34	PD	FUEL	2/6/2020
290	CHILEDA INSTITUTE INC	290011320201		43843 02012	48	17,257.08	PD	0008020561	1/15/2020
1368	DELTA DENTAL	338613		43866 DD020520	200,350,041	17,461.84	PD	DELTA DENTAL WI ASO PMT 020320	2/5/2020
1387	OTIS ELEVATOR CO	CMM05016120		43829 012320	1,660,696	17,494.36	PD	ELEVATOR SERVICE/MAINTENANCE	1/23/2020
1289	CADIENT LLC	2019-11954	CADIENT TALENT	43845 02062020	204	17,684.00	PD	KRONOS CADIENT TALENT SERVICE	2/6/2020
290	CHILEDA INSTITUTE INC	290020520201		43866 02014	292	17,822.83	PD	0008020561	2/14/2020
769	BURKE TRUCK & EQUIPMENT INC	26061		43831 01092020	9	17,883.20	PD	BLADES AND FREIGHT	1/9/2020
744	EMPLOYEE BENEFIT CORPORATION (EBC)	EBC01242020		43853 DD012320	200,230,020	18,313.95	PD	EBC EE/ER CONTRIBUTIONS	1/23/2020
723	JUNEAU UTILITIES	700045.00DEC19		43838 012320	1,660,553	18,381.88	PD	ELECTRIC CLV 12/1/19-1/1/20	1/23/2020
1542	MORTON SALT	5402008741		43852	0	18,922.62	PD	ROAD SALT	
1387	OTIS ELEVATOR CO	CMM05350120		43819 02062020	1,660,946	19,015.92	PD	ELEVATOR SERVICE/MAINTENANCE	2/6/2020
1368	DELTA DENTAL	337451		43859 DD012920	200,280,116	19,186.58	PD	DELTA DENTAL WI ASO PYMT 012720	1/29/2020
741	CONSTELLATION ENERGY SERVICES	2791792		43831 012320	1,660,525	19,716.86	PD	GAS CHARGES	1/23/2020
752	SECURIAN LIFE INSURANCE COMPANY	022020		43847 012320	167	20,251.96	PD	LIFE INSURANCE FEBRUARY 2020	1/23/2020
638	WI DEPT OF HEALTH SERVICES	2380 013120	20000062	43831 012320	1,660,733	20,400.00	PD	MONTHLY LICENSED BED ASSESSMENTS	1/23/2020
574	REESEVILLE PUBLIC LIBRARY	LIB 2020		43864 02062020	1,660,957	20,548.00	PD	2020 LIBRARY PAYMENT	2/6/2020
751	NATIONWIDE TRUST COMPANY FSB	01052020-P KACZMARSK		43851 02062020	1,660,857	21,342.72	PD	PEHP PAYOUT PETER KACZMARSKI	2/6/2020
308	JUSTICEPOINT INC	11302019		43811 01092020	1,660,379	22,556.00	PD	CONTRACT PAYMENTS 11/19	1/9/2020
723	JUNEAU UTILITIES	700095		43838 012320	1,660,553	24,125.89	PD	UTILITIES (2019)	1/23/2020
751	NATIONWIDE TRUST COMPANY FSB	01032020 L LOTHEN		43853 02062020	1,660,858	24,168.96	PD	PEHP PLAN PAYOUT LYNN LOTHEN	2/6/2020
215	Lutheran Social Services of WI and Upper Mi	148042		43799 02062020	248	25,246.89	PD	CCS 11/19	2/6/2020
719	SUMMIT FORD	97395	21000004	43830 010220	2	25,474.50	PD	DODGE CARAVAN VIN# 2C4RDGBG6KR786619	1/2/2020
664	WI DEPT OF ADMINISTRATION	PROBATE QTR 4		43838 01092020	1,660,454	26,164.00	PD	PROBATE AND VITAL RECORDS FEES 4TH QTR 2019	1/9/2020
1542	MORTON SALT	5402006699 & 6700		43852	0	28,117.92	PD	SALT / 16170	
97	TRIMIN SYSTEMS INC	050393		43800 01092020	36	28,761.00	PD	MAINTENANCE FOR TRIMIN	1/9/2020
308	JUSTICEPOINT INC	1130198		43811 01092020	1,660,379	30,105.00	PD	CONTRACT PAYMENTS 11/19	1/9/2020
308	JUSTICEPOINT INC	011020DOCJ		43830 012320	1,660,555	30,593.00	PD	CONTRACT PAYMENTS 12/19	1/23/2020
1013	BROWNSVILLE PUBLIC LIBRARY	LIB 2020		43864 02062020	1,660,774	31,970.00	PD	2020 LIBRARY PAYMENT	2/6/2020
549	FOX LAKE PUBLIC LIBRARY	LIB 2020		43864 02062020	1,660,807	32,392.00	PD	2020 LIBRARY PAYMENT	2/6/2020
75	EWALD CHEVROLET BUICK LLC	35585		43858 02062020	221	33,696.50	PD	TRUCK	2/6/2020
75	EWALD CHEVROLET BUICK LLC	35586		43858 02062020	221	33,696.50	PD	TRUCK	2/6/2020
751	NATIONWIDE TRUST COMPANY FSB	01152020-P THOMPSON		43851 012320	1,660,569	37,324.80	PD	PEHP PAYOUT PETER THOMPSON	1/23/2020
308	JUSTICEPOINT INC	OTC DEC 2019		43830 012320	1,660,555	37,774.00	PD	OPIOID GRANT 12/19	1/23/2020
770	GREEN VALLEY ENTERPRISES INC	122382		43830 012320	137	37,916.67	PD	CONTRACTED SERVICES	1/23/2020
567	OCONOMOWOC PUBLIC LIBRARY	LIB 2020		43864 02062020	1,660,861	38,376.00	PD	2020 LIBRARY PAYMENT	2/6/2020
555	KARL JUNGINGER MEMORIAL LIBRARY	LIB 2020		43864 02062020	1,660,830	38,538.00	PD	2020 LIBRARY PAYMENT	2/6/2020
1542	MORTON SALT	5402005532		43852	0	38,673.27	PD	SALT / 16170	
638	WI DEPT OF HEALTH SERVICES	2977 013120	20000062	43831 012320	1,660,733	41,860.00	PD	MONTHLY LICENSED BED ASSESSMENTS	1/23/2020
259	ACHIEVE SOLUTIONS INC	10042	ACHIEVE THERAPY SOLUTIONS	43833 012320	101	45,291.08	PD	MED A, MED B & PVT THERAPIES DEC 19	1/23/2020
1017	HORICON PUBLIC LIBRARY	LIB 2020		43864 02062020	1,660,812	46,105.00	PD	2020 LIBRARY PAYMENT	2/6/2020
582	WAUPUN PUBLIC LIBRARY	LIB 2020		43864 02062020	1,660,985	46,197.00	PD	2020 LIBRARY PAYMENT	2/6/2020
544	COLUMBUS PUBLIC LIBRARY	LIB 2020		43864 02062020	1,660,788	47,033.00	PD	2020 LIBRARY PAYMENT	2/6/2020
453	ANGUS-YOUNG ASSOCIATES INC	54264-6		43839 02062020	1,660,761	50,225.35	PD	REESEVILLE DESIGN/BIDDING DOCU	2/6/2020
561	MAYVILLE PUBLIC LIBRARY	LIB 2020		43864 02062020	1,660,848	50,775.00	PD	2020 LIBRARY PAYMENT	2/6/2020
259	ACHIEVE SOLUTIONS INC	10041	ACHIEVE THERAPY SOLUTIONS	43833 012320	101	59,941.88	PD	CBIC THERAPY CHARGES DEC 19	1/23/2020
863	ROBERTSON RYAN & ASSOC INC	103965		43830 01092020	30	60,666.00	PD	WORKERS COMP EXCESS INSURANCE	1/9/2020
647	STATE OF WISCONSIN	01142020		43844 DD011420	200,130,203	60,996.96	PD	TRANSFER FEES DUE STATE DEC 2019	1/14/2020
589	JACK RUSSELL MEMORIAL COMMUNITY LIBRARY	LIB 2020		43864 02062020	1,660,820	61,916.00	PD	2020 LIBRARY PAYMENT	2/6/2020
588	HUSTISFORD COMMUNITY LIBRARY	LIB 2020		43864 02062020	1,660,813	64,764.00	PD	2020 LIBRARY PAYMENT	2/6/2020
647	STATE OF WISCONSIN	JAN 2020		43875 DD021420	2,004,401	65,044.80	PD	TRANSFER FEES DUE STATE JANUARY 2020	2/6/2020
579	WATERTOWN PUBLIC LIBRARY	LIB 2020		43864 02062020	1,660,982	69,901.00	PD	2020 LIBRARY PAYMENT	2/6/2020
554	JUNEAU PUBLIC LIBRARY	LIB 2020		43864 02062020	1,660,827	72,595.00	PD	2020 LIBRARY PAYMENT	2/6/2020
112	Family Youth Interaction Zone	DEC19FYI	Family Youth Interaction Community	43830 012320	1,660,542	77,258.25	PD	CCS 12/19	1/23/2020
643	WI DEPT OF REVENUE	12-16-31-2019		43845 WIRE_001	200,140,089	78,652.81	PD	STATE TAX DODGE COUNTY	1/15/2020
1124	WELLPATH LLC	INV0060060		43832 012320	186	79,009.84	PD	2/1/20-2/29/20 MEDICAL SERVICES	1/23/2020
643	WI DEPT OF REVENUE	WD2142020		43875 DD021420	200,440,126	82,835.65	PD	STATE TAX - DODGE COUNTY	2/14/2020
1542	MORTON SALT	5402007652, 53 & 54		43852	0	88,145.11	PD	ROAD SALT	
643	WI DEPT OF REVENUE	WD13120		43861 DD013120	200,300,141	92,200.03	PD	STATE TAX DODGE CO	1/31/2020
1341	US BANK	US8 01-10-20		43840 DD011020	200,100,037	101,518.64	PD	NON-EBC EE/ER CONTRIBUTIONS	1/10/2020
1505	BOND TRUST SERVICES CORPORATION	52512		43860 DD013020	200,130,031	119,825.01	PD	INTEREST PAYMENTS REF #329726	1/30/2020
647	STATE OF WISCONSIN	Dodge County Dec 201		43846 012320	1,660,703	161,898.27	PD	CLERK OF COURTS FEE DUE STATE DEC 2019 DODGE COUNT	1/23/2020

638	WI DEPT OF HEALTH SERVICES		435-000059026	43831	02062020	1,660,994	170,553.75	PD	FAMILY CARE CONTRIBUTION 11.01.19 to 01.31.20	2/6/2020
744	EMPLOYEE BENEFIT CORPORATION (EBC)		EBC 01-10-2020	43840	DD011020	200,100,038	188,108.95	PD	EBC EE/ER CONTRIBUTIONS	1/10/2020
584	BEAVER DAM COMMUNITY LIBRARY		LJB 2020	43864	02062020	1,660,769	266,357.00	PD	2020 LIBRARY PAYMENT	2/6/2020
1341	US BANK		USBANK01102020	43845	DD011520	200,150,105	302,572.77	PD	USBANK PYMT 01-10-2020	1/15/2020
1195	WISCONSIN MUNICIPAL MUTUAL INSURANCE COMPANY	WMMIC	1915	43831	02062020	1,661,000	311,493.00	PD	AUTO GENERAL CYBER LIABILITY INS ERRORS & OMMISSIO	2/6/2020
617	INTERNAL REVENUE SERVICE		02072020	43868	DD020720	200,370,027	399,666.86	PD	FEDERAL TAX PYMT DODGE CO	2/7/2020
617	INTERNAL REVENUE SERVICE		01242020	43854	DD012420	200,230,039	408,139.39	PD	FED TAX PYMT DODGE CO 01/24/2020	1/24/2020
617	INTERNAL REVENUE SERVICE		FED PYMT 01-10-20	43840	DD011020	200,090,081	441,246.49	PD	FED TAX PYMT 01-10-2020	1/10/2020
1519	VOGEL TRAFFIC SERVICES INC	EZ LINER I	066596	43831	02062020	1,660,980	449,228.00	PD	PAINT TRUCK	2/6/2020
636	WI DEPT OF EMPLOYEE TRUST FUNDS		DEC 2019	43861	DD013120	200,290,112	476,330.98	PD	WRS - DODGE COUNTY	1/31/2020
1314	DEAN HEALTH PLAN		005504934	43809	010220	1	749,004.89	PD	JANUARY 2020 HEALTH INSURANCE	1/2/2020
1314	DEAN HEALTH PLAN		005561571	43851	02062020	216	752,203.76	PD	FEBRUARY 2020 HEALTH INSURANCE	2/6/2020

8,398,266.63

CHECKS OVER \$10,000

VENDOR	NAME	DBA	INVOICE	P.O.	INV DATE	CHECK RUN	CHECK NO	INVOICE NET	DUE DATE	STS	INVOICE DESCRIPTION	CHECK DATE
1314	DEAN HEALTH PLAN		005504934		12/10/2019	010220		749,004.89	1/1/2020	PD	JANUARY 2020 HEALTH INSURANCE	43832
719	SUMMIT FORD		9T395	21000004	12/31/2019	010220	1 Total	749,004.89				
769	BURKE TRUCK & EQUIPMENT INC		26061		1/1/2020	01092020	2 Total	25,474.50	2/1/2020	PD	DODGE CARAVAN VIN# 2C4RDGBG6KR786619	43832
956	CANNON COCHRAN MANAGEMENT SERVICES INC		0080282-IN		12/31/2019	01092020	9 Total	17,883.20	1/20/2020	PD	BLADES AND FREIGHT	43839
34	CAPITAL DATA INC		37427		12/17/2019	01092020	10 Total	14,220.58	1/10/2020	PD	CCMSI WORKERS COMP FUND REIMBURSEMENT	43839
34	CAPITAL DATA INC		36749		12/18/2019	01092020		14,220.58				
34	CAPITAL DATA INC		37999		1/1/2020	01092020		12,168.50	1/18/2020	PD	NETWORK EDGE SWITCH	43839
700	COMPLETE OFFICE OF WISCONSIN INC	EMMONS BUSINESS INTERIORS	150772		12/13/2019	01092020	12 Total	9,021.00	1/17/2020	PD	PROFESSIONAL SERVICES FOR F5	43839
863	ROBERTSON RYAN & ASSOC INC		108409		12/18/2019	01092020		16,108.68	1/20/2020	PD	PRO SOFTWARE SUPPORT	43839
863	ROBERTSON RYAN & ASSOC INC		108406		12/18/2019	01092020		37,298.18				
863	ROBERTSON RYAN & ASSOC INC		109405		1/2/2020	01092020	13 Total	11,837.78	12/23/2019	PD	ES FURNITURE	43839
863	ROBERTSON RYAN & ASSOC INC		103965		12/31/2019	01092020		11,837.78				
97	TRIMIN SYSTEMS INC		050393		12/1/2019	01092020	29 Total	16,393.48	1/17/2020	PD	20-21 PROFESSIONAL LIABILITY POLICY RENEWAL	43839
856	ADULT CARE CONSULTANTS INC		856011320201		1/13/2020	02012		1,200.00	1/17/2020	PD	20-21 K-9 MORTALITY POLICY RENEWAL	43839
856	ADULT CARE CONSULTANTS INC		856011320202		1/13/2020	02012		17,593.48				
290	CHILEDIA INSTITUTE INC		290011320201		1/13/2020	02012	30 Total	3,639.00	1/2/2020	PD	AVIATION POLICY RENEWAL	43839
876	COMMUNITY CARE RESOURCES		876011320201		1/13/2020	02012		60,666.00	1/10/2020	PD	WORKERS COMP EXCESS INSURANCE	43839
876	COMMUNITY CARE RESOURCES		876011320202		1/13/2020	02012		64,305.00				
876	COMMUNITY CARE RESOURCES		876011320203		1/13/2020	02012		28,761.00	12/11/2019	PD	MAINTENANCE FOR TRIMIN	43839
876	COMMUNITY CARE RESOURCES		876011320204		1/13/2020	02012		28,761.00				
876	COMMUNITY CARE RESOURCES		876011320205		1/13/2020	02012		6,466.29	1/15/2020	PD	0008081642	43845
876	COMMUNITY CARE RESOURCES		876011320206		1/13/2020	02012		6,466.29	1/15/2020	PD	0008081642	43845
876	COMMUNITY CARE RESOURCES		876011320207		1/13/2020	02012		12,932.58				
876	COMMUNITY CARE RESOURCES		876011320208		1/13/2020	02012		17,257.08	1/15/2020	PD	0008020581	43845
876	COMMUNITY CARE RESOURCES		876011320209		1/13/2020	02012		17,257.08				
825	OCONOMOWOC DEVELOPMENT TRAINING CENTER OF WI		825011320201		1/13/2020	02012	40 Total	2,254.94	1/15/2020	PD	0000022566	43845
213	YOUTH VILLAGES		213011320201		1/13/2020	02012		2,254.94	1/15/2020	PD	0000022566	43845
259	ACHIEVE SOLUTIONS INC	ACHIEVE THERAPY SOLUTIONS	10041		1/3/2020	012320		2,254.94	1/15/2020	PD	0000022566	43845
259	ACHIEVE SOLUTIONS INC	ACHIEVE THERAPY SOLUTIONS	10042		1/3/2020	012320		2,254.94	1/15/2020	PD	0000022566	43845
856	ADULT CARE CONSULTANTS INC		15473;15477-90		11/30/2019	012320	51 Total	2,254.94	1/15/2020	PD	0000022566	43845
1438	FEIL'S CATERING		E191231		12/31/2019	012320		20,294.46	1/15/2020	PD	0008019479	43845
770	GREEN VALLEY ENTERPRISES INC		122402		12/31/2019	012320		12,502.30	1/15/2020	PD	0008019479	43845
770	GREEN VALLEY ENTERPRISES INC		122382		12/31/2019	012320		12,502.30				
1173	LISA N BRIGHT		122619		12/26/2019	012320	81 Total	15,500.00	1/15/2020	PD	0008057986	43845
1173	LISA N BRIGHT		010820BRIGHT		1/8/2020	012320		59,941.88	2/2/2020	PD	CBIC THERAPY CHARGES DEC 19	43853
1173	LISA N BRIGHT		011520BRIGHT		1/15/2020	012320		45,291.08	2/2/2020	PD	MED A, MED B & PVT THERAPIES DEC 19	43853
752	SECURIAN LIFE INSURANCE COMPANY		022020		1/17/2020	012320	101 Total	105,232.96				
1124	WELLPATH LLC		INV0060060		1/2/2020	012320		12,127.50	1/29/2020	PD	CCS MEDICATION MANAGEMENT NOV	43853
1124	WELLPATH LLC		INV0060383		1/10/2020	012320		12,127.50				
162	ARAMARK UNIFORM & CAREER APPAREL GROUP INC	ARAMARK UNIFORM & CAREER APPAREL LLC	200790600-000914		1/1/2020	02062020	102 Total	14,206.01	1/1/2020	PD	3,029 MEALS DELIVERED @ \$4.69 EA	43853
1289	CADIENT LLC	CADIENT TALENT	2019-11954		1/15/2020	02062020		14,206.01				
1609	DAYBREAK INC		0719-90-010		7/31/2019	02062020	129 Total	495.34	1/30/2020	PD	KLEINMANN/ MACHKOVICH HOURS/ BATH DEC 2019	43853
1609	DAYBREAK INC		0819-90-010		8/31/2019	02062020		97,916.67	1/30/2020	PD	CONTRACTED SERVICES	43853
							137 Total	38,412.01				
								2,280.00	1/2/2020	PD	CONTRACTED SERVICES	43853
								3,131.20	1/9/2020	PD	2020 CONTRACT	43853
								4,696.80	1/16/2020	PD	2020 CONTRACT	43853
							150 Total	10,108.00				
								20,251.96	1/24/2020	PD	LIFE INSURANCE FEBRUARY 2020	43853
								79,009.84	2/1/2020	PD	2/1/20-2/29/20 MEDICAL SERVICES	43853
								1,034.11	1/30/2020	PD	MAT GRANT	43853
							186 Total	80,049.95				
								11,877.89	1/11/2020	PD	INMATE MEALS 12/5-12/11	43867
								11,877.89				
								17,684.00	2/14/2020	PD	KRONOS CADIENT TALENT SERVICE	43867
							204 Total	17,684.00				
								6,283.08	8/30/2019	PD	CBRF & 516 PROGRAM	43867
								6,283.08	9/30/2019	PD	CBRF & 516 PROGRAM	43867

1609	DAYBREAK INC	0919-30-010		9/30/2019	02062020	215	6,080.40	10/30/2019	PD	CBRF & 516 PROGRAM	43867
1609	DAYBREAK INC	1019-30-010		10/31/2019	02062020	215	6,283.08	11/30/2019	PD	CBRF & 516 PROGRAM	43867
1609	DAYBREAK INC	1119-30-010		11/30/2019	02062020	215	6,080.40	12/30/2019	PD	CBRF & 516 PROGRAM	43867
1609	DAYBREAK INC	1219-30-010		12/31/2019	02062020	215	6,283.08	1/30/2020	PD	CBRF & 516 PROGRAM	43867
						215 Total	37,293.12				
1314	DEAN HEALTH PLAN	005561571		1/21/2020	02062020	216	752,203.76	2/1/2020	PD	FEBRUARY 2020 HEALTH INSURANCE	43867
						216 Total	752,203.76				
1243	DELL MARKETING LP	10367279320	20000016	1/11/2020	02062020	218	10,502.00	2/10/2020	PD	MONITOR REPLACEMENTS	43867
						218 Total	10,502.00				
75	EWALD CHEVROLET BUICK LLC	35585		1/28/2020	02062020	221	33,696.50	2/7/2020	PD	TRUCK	43867
75	EWALD CHEVROLET BUICK LLC	35586		1/28/2020	02062020	221	33,696.50	2/7/2020	PD	TRUCK	43867
						221 Total	67,393.00				
1104	KRIETE TRUCK CENTER MILWAUKEE	374200A		1/8/2020	02062020	242	502.74	2/7/2020	PD	PARTS	43867
1104	KRIETE TRUCK CENTER MILWAUKEE	374102A		1/8/2020	02062020	242	242.08	2/7/2020	PD	PARTS	43867
1104	KRIETE TRUCK CENTER MILWAUKEE	CM374102A		1/9/2020	02062020	242	[12.35]	2/8/2020	PD	FREIGHT CREDIT	43867
1104	KRIETE TRUCK CENTER MILWAUKEE	374342A		1/9/2020	02062020	242	668.78	2/8/2020	PD	PARTS	43867
1104	KRIETE TRUCK CENTER MILWAUKEE	353724F		1/9/2020	02062020	242	838.08	2/8/2020	PD	PARTS	43867
1104	KRIETE TRUCK CENTER MILWAUKEE	374541A		1/13/2020	02062020	242	175.93	2/12/2020	PD	FLOOR MATS	43867
1104	KRIETE TRUCK CENTER MILWAUKEE	374428A		1/10/2020	02062020	242	172.84	2/9/2020	PD	PARTS	43867
1104	KRIETE TRUCK CENTER MILWAUKEE	374480A		1/10/2020	02062020	242	403.20	2/9/2020	PD	BATTERIES	43867
1104	KRIETE TRUCK CENTER MILWAUKEE	374237A		1/13/2020	02062020	242	624.70	2/12/2020	PD	PARTS	43867
1104	KRIETE TRUCK CENTER MILWAUKEE	374504A		1/13/2020	02062020	242	39.88	2/12/2020	PD	PARTS	43867
1104	KRIETE TRUCK CENTER MILWAUKEE	374545A		1/13/2020	02062020	242	592.59	2/12/2020	PD	PARTS	43867
1104	KRIETE TRUCK CENTER MILWAUKEE	374546A		1/13/2020	02062020	242	592.59	2/12/2020	PD	SENSOR	43867
1104	KRIETE TRUCK CENTER MILWAUKEE	CM374237A		1/14/2020	02062020	242	[22.33]	2/13/2020	PD	PARTS RETURN	43867
1104	KRIETE TRUCK CENTER MILWAUKEE	374689A		1/15/2020	02062020	242	127.47	2/14/2020	PD	PARTS	43867
1104	KRIETE TRUCK CENTER MILWAUKEE	374769A		1/15/2020	02062020	242	267.00	2/14/2020	PD	PARTS	43867
1104	KRIETE TRUCK CENTER MILWAUKEE	374838A		1/16/2020	02062020	242	318.15	2/15/2020	PD	PARTS	43867
1104	KRIETE TRUCK CENTER MILWAUKEE	374765A		1/16/2020	02062020	242	27.76	2/15/2020	PD	PARTS	43867
1104	KRIETE TRUCK CENTER MILWAUKEE	374764A		1/16/2020	02062020	242	230.81	2/15/2020	PD	PARTS	43867
1104	KRIETE TRUCK CENTER MILWAUKEE	374831A		1/16/2020	02062020	242	449.88	2/15/2020	PD	PARTS	43867
1104	KRIETE TRUCK CENTER MILWAUKEE	374488A		1/13/2020	02062020	242	105.14	2/12/2020	PD	PARTS	43867
1104	KRIETE TRUCK CENTER MILWAUKEE	374778A		1/15/2020	02062020	242	84.42	2/14/2020	PD	PARTS	43867
1104	KRIETE TRUCK CENTER MILWAUKEE	373891A		1/16/2020	02062020	242	14.80	2/15/2020	PD	PARTS	43867
1104	KRIETE TRUCK CENTER MILWAUKEE	CM374942A		1/16/2020	02062020	242	[229.10]	2/15/2020	PD	PARTS CREDIT	43867
1104	KRIETE TRUCK CENTER MILWAUKEE	354442F		1/18/2020	02062020	242	694.23	2/17/2020	PD	PARTS	43867
1104	KRIETE TRUCK CENTER MILWAUKEE	354443F		1/18/2020	02062020	242	194.18	2/17/2020	PD	PARTS	43867
1104	KRIETE TRUCK CENTER MILWAUKEE	354445F		1/18/2020	02062020	242	213.65	2/17/2020	PD	PARTS	43867
1104	KRIETE TRUCK CENTER MILWAUKEE	374871A		1/16/2020	02062020	242	351.86	2/15/2020	PD	FLOOR MATS	43867
1104	KRIETE TRUCK CENTER MILWAUKEE	374933A		1/17/2020	02062020	242	520.20	2/16/2020	PD	BATTERIES	43867
1104	KRIETE TRUCK CENTER MILWAUKEE	CM374933A		1/17/2020	02062020	242	[117.00]	2/16/2020	PD	CORE CREDIT	43867
1104	KRIETE TRUCK CENTER MILWAUKEE	374996A		1/20/2020	02062020	242	1,472.47	2/19/2020	PD	PARTS	43867
1104	KRIETE TRUCK CENTER MILWAUKEE	375000A		1/20/2020	02062020	242	213.65	2/19/2020	PD	WIPER MOTOR	43867
1104	KRIETE TRUCK CENTER MILWAUKEE	374985A		1/20/2020	02062020	242	862.18	2/19/2020	PD	PARTS	43867
1104	KRIETE TRUCK CENTER MILWAUKEE	373485AX1		1/20/2020	02062020	242	81.09	2/19/2020	PD	PART	43867
						242 Total	10,641.67				
215	Lutheran Social Services of WI and Upper MI	148042		11/30/2019	02062020	248	25,246.89	1/29/2020	PD	CCS 11/19	43867
						248 Total	25,246.89				
887	TYLER TECHNOLOGIES	045-288495		1/1/2020	02062020	273	7,000.00	2/14/2020	PD	ERP CONV STD INVNTY 50% 2019 BUDGET 1814.5818.01	43867
887	TYLER TECHNOLOGIES	045-281775		1/1/2020	02062020	273	2,000.00	2/14/2020	PD	ERP GENERAL FORMS 2019 BUDGET 1814.5818.01	43867
887	TYLER TECHNOLOGIES	045-288246		1/1/2020	02062020	273	4,700.00	2/14/2020	PD	PROJECT MGMT FOR NOV 2019 CHARGES ERP 1814.5818.01	43867
						273 Total	15,700.00				
856	ADULT CARE CONSULTANTS INC	856020520201		2/5/2020	02014	283	5,325.18	2/13/2020	PD	0008081642	43875
856	ADULT CARE CONSULTANTS INC	856020520202		2/5/2020	02014	283	5,325.18	2/13/2020	PD	0008081642	43875
						283 Total	10,650.36				
290	CHILEDA INSTITUTE INC	290020520201		2/5/2020	02014	292	17,822.83	2/13/2020	PD	0008020561	43875
						292 Total	17,822.83				
876	COMMUNITY CARE RESOURCES	876020520201		2/5/2020	02014	295	2,254.94	2/13/2020	PD	0000022566	43875
876	COMMUNITY CARE RESOURCES	876020520202		2/5/2020	02014	295	2,254.94	2/13/2020	PD	0000022566	43875
876	COMMUNITY CARE RESOURCES	876020520203		2/5/2020	02014	295	2,254.94	2/13/2020	PD	0000022566	43875
876	COMMUNITY CARE RESOURCES	876020520204		2/5/2020	02014	295	2,254.94	2/13/2020	PD	0000022566	43875
876	COMMUNITY CARE RESOURCES	876020520205		2/5/2020	02014	295	2,254.94	2/13/2020	PD	0000022566	43875
876	COMMUNITY CARE RESOURCES	876020520206		2/5/2020	02014	295	2,254.94	2/13/2020	PD	0000022566	43875
876	COMMUNITY CARE RESOURCES	876020520207		2/5/2020	02014	295	1,484.80	2/13/2020	PD	0000022566	43875
876	COMMUNITY CARE RESOURCES	876020520208		2/5/2020	02014	295	2,152.96	2/13/2020	PD	0000022566	43875
876	COMMUNITY CARE RESOURCES	876020520209		2/5/2020	02014	295	1,484.80	2/13/2020	PD	0000022566	43875
876	COMMUNITY CARE RESOURCES	8760205202010		2/5/2020	02014	295	2,152.96	2/13/2020	PD	0000022566	43875
876	COMMUNITY CARE RESOURCES	8760205202011		2/5/2020	02014	295	2,254.94	2/13/2020	PD	0000022566	43875

876	COMMUNITY CARE RESOURCES		8760205202012		2/5/2020	02014	295	2,301.44	2/13/2020	PD	0000022566	43875	
876	COMMUNITY CARE RESOURCES		8760205202013		2/5/2020	02014	295	668.16	2/13/2020	PD	0000022566	43875	
876	COMMUNITY CARE RESOURCES		8760205202014		2/5/2020	02014	295	668.16	2/13/2020	PD	0000022566	43875	
876	COMMUNITY CARE RESOURCES		8760205202015		2/5/2020	02014	295	2,301.44	2/13/2020	PD	0000022566	43875	
							295 Total	28,999.30					
825	OCONOMOWOC DEVELOPMENT TRAINING CENTER OF WI		825020520201		2/5/2020	02014	326	13,015.66	2/13/2020	PD	0008019479	43875	
							326 Total	13,015.66					
213	YOUTH VILLAGES		213020520201		2/5/2020	02014	345	15,500.00	2/13/2020	PD	0008057966	43875	
							345 Total	15,500.00					
1458	YOUTH VILLAGES		1458020520201		2/5/2020	02014	346	13,950.00	2/13/2020	PD	0008080185	43875	
							346 Total	13,950.00					
1	ONE TIME VENDOR		FORFEITURE		1/3/2020	010620		1,660,350	10,747.50	1/6/2020	PD	FORFEITURE TO BE PAID TO US MARSHAL SERVICE ON SPE	43836
							1,660,350 Total	10,747.50					
1395	ARAMARK SERVICES INC	ARAMARK CORRECTIONAL SERVICES	200790600-000914		12/11/2019	01092020		1,660,352	11,877.89	1/10/2020	PD	INMATE MEALS FOR 12/5-12/11	43839
1395	ARAMARK SERVICES INC	ARAMARK CORRECTIONAL SERVICES	200790600-000916		12/18/2019	01092020		1,660,352	11,448.18	1/17/2020	PD	INMATE MEALS 12/12-12/19	43839
1395	ARAMARK SERVICES INC	ARAMARK CORRECTIONAL SERVICES	200790600-000918		12/25/2019	01092020		1,660,352	11,100.41	1/16/2020	PD	INMATE MEALS 12/19-12/25	43839
							1,660,352 Total	34,426.48					
1137	VALERIE SMITH	BLACKBERRY HILL INC	BLACKBERRY MR 2019		1/1/2020	01092020		1,660,356	10,075.00	1/15/2020	PD	MI - CBRF 12/19	43839
							1,660,356 Total	10,075.00					
211	COUNTY OF TREMPEALEAU	Trempealeau County Health Care Center	113019		11/30/2019	01092020		1,660,363	10,005.15	12/30/2019	PD	INPATIENT	43839
							1,660,363 Total	10,005.15					
141	EDWARD H WOLF & SONS INC		242948		1/6/2020	01092020		1,660,369	16,721.27	1/16/2020	PD	GAS & DIESEL	43839
							1,660,369 Total	16,721.27					
91	ENERGY SERVICES INC		1737		11/30/2019	01092020		1,660,370	12,388.55	12/30/2019	PD	NOVEMBER	43839
							1,660,370 Total	12,388.55					
308	JUSTICEPOINT INC		2287		1/1/2020	01092020		1,660,379	3,270.50	1/16/2020	PD	INMATE ELECTRONIC MONITORING - NOVEMBER	43839
308	JUSTICEPOINT INC		11802019		12/11/2019	01092020		1,660,379	22,556.00	12/27/2019	PD	CONTRACT PAYMENTS 11/19	43839
308	JUSTICEPOINT INC		11802019A		12/11/2019	01092020		1,660,379	3,840.00	12/27/2019	PD	NEWAHEC PREVENTION GRANT	43839
308	JUSTICEPOINT INC		2286		11/30/2019	01092020		1,660,379	468.00	12/15/2019	PD	ELECTRONIC MONITORING	43839
308	JUSTICEPOINT INC		113019B		12/12/2019	01092020		1,660,379	30,105.00	12/27/2019	PD	CONTRACT PAYMENTS 11/19	43839
							1,660,379 Total	60,239.50					
751	NATIONWIDE TRUST COMPANY FSB		12292019		12/29/2019	01092020		1,660,384	15,180.73	12/30/2019	PD	PEHP PAYOUT FOR LS.	43839
							1,660,384 Total	15,180.73					
664	WI DEPT OF ADMINISTRATION		PROBATE QTR 4		1/8/2020	01092020		1,660,454	26,164.00	1/8/2020	PD	PROBATE AND VITAL RECORDS FEES 4TH QTR 2019	43839
							1,660,454 Total	26,164.00					
751	NATIONWIDE TRUST COMPANY FSB		NR 01-10-20		1/9/2020	011020		1,660,469	15,754.30	1/10/2020	PD	DEFERRED COMPENSATION	43840
							1,660,469 Total	15,754.30					
814	CLINICARE CORP	EAU CLAIRE ACADEMY	814011320201		1/13/2020	02012		1,660,479	12,041.02	1/15/2020	PD	0008020569	43845
							1,660,479 Total	12,041.02					
1431	FAMILY SERVICES OF NORTHEAST WISCONSIN INC		1431011320201		1/13/2020	02012		1,660,483	10,550.54	1/15/2020	PD	0008020562	43845
							1,660,483 Total	10,550.54					
394	TOMORROWS CHILDREN INC		394011320201		1/13/2020	02012		1,660,499	10,354.00	1/15/2020	PD	0008021021	43845
394	TOMORROWS CHILDREN INC		394011320202		1/13/2020	02012		1,660,499	10,354.00	1/15/2020	PD	0008021021	43845
							1,660,499 Total	20,708.00					
722	ALLIANT ENERGY		807734		1/8/2020	012320		1,660,504	1,441.07	1/18/2020	PD	GAS BILL	43853
722	ALLIANT ENERGY		010920813030000		1/1/2020	012320		1,660,504	7,661.48	1/19/2020	PD	UTILITIES	43853
722	ALLIANT ENERGY		9180379037		12/17/2019	012320		1,660,504	103.38	12/27/2019	PD	11/17-12/17 GAS FOR IMPOUND BUILDING	43853
722	ALLIANT ENERGY		20191213-4074440000		1/1/2020	012320		1,660,504	65.22	1/2/2020	PD	ELECTRICITY - DERGE PARK - 2019 (7866.5222)	43853
722	ALLIANT ENERGY		20191213-2789700000		1/1/2020	012320		1,660,504	186.69	1/2/2020	PD	ELECTRICITY - DERGE PARK - 2019 - (7866.5222)	43853
722	ALLIANT ENERGY		20191213-6126630000		1/1/2020	012320		1,660,504	170.75	1/2/2020	PD	ELECTRICITY - DERGE PARK - 2019 - (7866.5222)	43853
722	ALLIANT ENERGY		12152020		1/15/2020	012320		1,660,504	490.22	1/25/2020	PD	GAS CHARGES	43853
722	ALLIANT ENERGY		12172020		1/17/2020	012320		1,660,504	2,746.50	1/27/2020	PD	GAS PAYMENT	43853
722	ALLIANT ENERGY		20200113-2789700000		1/13/2020	012320		1,660,504	107.94	1/23/2020	PD	ELECTRIC - DERGE	43853
722	ALLIANT ENERGY		20200113-6126630000		1/3/2020	012320		1,660,504	38.09	1/13/2020	PD	ELECTRIC - DERGE PARK	43853
722	ALLIANT ENERGY		20200113-4074440000		1/13/2020	012320		1,660,504	41.61	1/23/2020	PD	ELECTRIC - DERGE	43853
722	ALLIANT ENERGY		70054		1/1/2020	012320		1,660,504	1,704.89	1/23/2020	PD	GAS TRANSPORT	43853
722	ALLIANT ENERGY		257085		1/1/2020	012320		1,660,504	177.97	1/23/2020	PD	GAS	43853
722	ALLIANT ENERGY		102624		1/1/2020	012320		1,660,504	1,303.66	1/23/2020	PD	GAS	43853
722	ALLIANT ENERGY		469324		1/1/2020	012320		1,660,504	2,558.91	1/23/2020	PD	GAS	43853
722	ALLIANT ENERGY		694331		1/1/2020	012320		1,660,504	836.35	1/23/2020	PD	GAS	43853
							1,660,504 Total	19,634.73					
1395	ARAMARK SERVICES INC	ARAMARK CORRECTIONAL SERVICES	200790600-00920		1/1/2020	012320		1,660,505	11,192.78	1/31/2020	PD	INMATE MEALS 12/26 - 1/1	43853
							1,660,505 Total	11,192.78					
211	COUNTY OF TREMPEALEAU	Trempealeau County Health Care Center	KW DEC 2019		12/31/2019	012320		1,660,523	10,283.23	1/30/2020	PD	INPATIENT 12/19	43853
							1,660,523 Total	10,283.23					
741	CONSTELLATION ENERGY SERVICES		2791792		1/1/2020	012320		1,660,525	19,716.86	1/22/2020	PD	GAS CHARGES	43853
741	CONSTELLATION ENERGY SERVICES		2791777		1/10/2020	012320		1,660,525	5,195.55	1/20/2020	PD	NATURAL GAS CHARGES DEC 19 ACCT ID BG-1574	43853
							1,660,525 Total	24,912.41					
91	ENERGY SERVICES INC		1762		12/31/2019	012320		1,660,540	15,481.38	1/30/2020	PD	DECEMBER 2019	43853
							1,660,540 Total	15,481.38					
112	Family Youth Interaction Zone	Family Youth Interaction Community	October 2019		1/1/2020	012320		1,660,542	2,436.75	1/16/2020	PD	CST MENTORING 10/19	43853

112	Family Youth Interaction Zone	Family Youth Interaction Community	128119A8		1/1/2020 012320	1,660,542	627.00	1/16/2020 PD	DEC CST MENTORING	43853
112	Family Youth Interaction Zone	Family Youth Interaction Community	128119HM		1/1/2020 012320	1,660,542	840.75	1/16/2020 PD	DEC CST MENTORING	43853
112	Family Youth Interaction Zone	Family Youth Interaction Community	123119CG		1/1/2020 012320	1,660,542	470.25	1/16/2020 PD	DEC CST MENTORING	43853
112	Family Youth Interaction Zone	Family Youth Interaction Community	DEC19 STANDARD MENTO		1/1/2020 012320	1,660,542	2,764.50	1/16/2020 PD	MENTORSHIP 12/19	43853
112	Family Youth Interaction Zone	Family Youth Interaction Community	DEC19FYI		12/31/2019 012320	1,660,542	77,258.25	1/15/2020 PD	CCS 12/19	43853
						1,660,542 Total	84,397.50			
723	JUNEAU UTILITIES		700049.00DEC19		1/8/2020 012320	1,660,553	3,803.99	1/18/2020 PD	WATER/SEWER/FIRE PROTECTION CLV 12/1/19-1/1/20	43853
723	JUNEAU UTILITIES		106020.06DEC19		1/8/2020 012320	1,660,553	334.29	1/18/2020 PD	ELECTRIC/WATER/SEWER/FIRE CGH 12/1/19-1/1/20	43853
723	JUNEAU UTILITIES		700049.00DEC19		1/8/2020 012320	1,660,553	35.55	1/18/2020 PD	ELECTRIC CLV GARAGES 12/1/19-1/1/20	43853
723	JUNEAU UTILITIES		700035.00DEC19		1/8/2020 012320	1,660,553	162.32	1/18/2020 PD	ELECTRIC TLV 12/1/19-1/1/20	43853
723	JUNEAU UTILITIES		700045.00DEC19		1/8/2020 012320	1,660,553	18,381.88	1/18/2020 PD	ELECTRIC CLV 12/1/19-1/1/20	43853
723	JUNEAU UTILITIES		C-113		1/15/2020 012320	1,660,553	1,273.48	1/25/2020 PD	BOD/SUS SOLIDS/PHOSPHORUS PENALTY DEC 19	43853
723	JUNEAU UTILITIES		J-0543		1/1/2020 012320	1,660,553	552.60	1/23/2020 PD	SEWER PENALTIES	43853
723	JUNEAU UTILITIES		700380.00		1/1/2020 012320	1,660,553	381.17	1/11/2020 PD	FUELING STATION ELECTRIC	43853
723	JUNEAU UTILITIES		700405.00		1/1/2020 012320	1,660,553	2,476.47	1/11/2020 PD	UTILITIES	43853
723	JUNEAU UTILITIES		700410.00		1/1/2020 012320	1,660,553	2,452.09	1/11/2020 PD	UTILITIES	43853
723	JUNEAU UTILITIES		700420		1/8/2020 012320	1,660,553	4,737.13	1/18/2020 PD	UTILITIES (2019)	43853
723	JUNEAU UTILITIES		700425		1/8/2020 012320	1,660,553	552.67	1/28/2020 PD	UTILITIES (2019)	43853
723	JUNEAU UTILITIES		201720		1/8/2020 012320	1,660,553	60.51	1/28/2020 PD	UTILITIES (2019)	43853
723	JUNEAU UTILITIES		700085		1/8/2020 012320	1,660,553	893.60	1/28/2020 PD	UTILITIES (2019)	43853
723	JUNEAU UTILITIES		700055		1/8/2020 012320	1,660,553	7,157.37	1/28/2020 PD	UTILITIES (2019)	43853
723	JUNEAU UTILITIES		700060		1/8/2020 012320	1,660,553	2,072.48	1/28/2020 PD	UTILITIES (2019)	43853
723	JUNEAU UTILITIES		700095		1/8/2020 012320	1,660,553	24,125.89	1/28/2020 PD	UTILITIES (2019)	43853
723	JUNEAU UTILITIES		700100		1/8/2020 012320	1,660,553	8,868.57	1/28/2020 PD	UTILITIES (2019)	43853
723	JUNEAU UTILITIES		700090		1/8/2020 012320	1,660,553	3,071.11	1/28/2020 PD	UTILITIES (2019)	43853
						1,660,553 Total	81,383.17			
308	JUSTICEPOINT INC		011020DOJ		12/31/2019 012320	1,660,555	30,593.00	1/15/2020 PD	CONTRACT PAYMENTS 12/19	43853
308	JUSTICEPOINT INC		OTC DEC 2019		12/31/2019 012320	1,660,555	37,774.00	1/15/2020 PD	OPIOID GRANT 12/19	43853
						1,660,555 Total	68,367.00			
1041	LEXIPOL LLC		32103		12/10/2019 012320	1,660,561	12,939.00	1/24/2020 PD	ONLINE POLICY MANUAL	43853
1041	LEXIPOL LLC		32301		1/1/2020 012320	1,660,561	9,924.00	1/31/2020 PD	LE Policy Manual Update Subscription	43853
						1,660,561 Total	22,863.00			
684	MATRIX CONSULTING GROUP		19-04 86		7/18/2019 012320	1,660,565	11,931.00	8/16/2019 PD	SHERIFF'S OPERAT AND FINANCIAL REVIEW - 7/18/19	43853
						1,660,565 Total	11,931.00			
751	NATIONWIDE TRUST COMPANY FSB		01152020-P THOMPSON		1/21/2020 012320	1,660,569	37,324.80	1/24/2020 PD	PEHP PAYOUT PETER THOMPSON	43853
						1,660,569 Total	37,324.80			
1387	OTIS ELEVATOR CO		CMN05050120		12/20/2019 012320	1,660,696	12,517.80	1/19/2020 PD	ELEVATOR SERVICE/MAINTENANCE	43853
1387	OTIS ELEVATOR CO		CMN05016120		12/30/2019 012320	1,660,696	17,494.35	1/29/2020 PD	ELEVATOR SERVICE/MAINTENANCE	43853
1387	OTIS ELEVATOR CO		CMN65163120		12/20/2019 012320	1,660,696	9,437.52	1/19/2020 PD	ELEVATOR SERVICE/MAINTENANCE	43853
						1,660,696 Total	39,449.68			
1241	SHANNON JAMES LLC		12/31/19		12/31/2019 012320	1,660,702	10,218.75	1/30/2020 PD	CCS 12/19	43853
						1,660,702 Total	10,218.75			
647	STATE OF WISCONSIN		Dodge County Dec 201		1/16/2020 012320	1,660,703	161,898.27	1/22/2020 PD	CLERK OF COURTS FEE DUE STATE DEC 2019 DODGE COUNTY	43853
						1,660,703 Total	161,898.27			
119	WI COUNTIES ASSOCIATION		12052019	20000011	12/5/2019 012320	1,660,729	11,312.00	2/2/2020 PD	WCA MEMBERSHIP DUES	43853
						1,660,729 Total	11,312.00			
638	WI DEPT OF HEALTH SERVICES		5034 013120	20000062	1/1/2020 012320	1,660,733	5,100.00	1/31/2020 PD	MONTHLY LICENSED BED ASSESSMENTS	43853
638	WI DEPT OF HEALTH SERVICES		5026 013120	20000062	1/1/2020 012320	1,660,733	1,700.00	1/31/2020 PD	MONTHLY LICENSED BED ASSESSMENTS	43853
638	WI DEPT OF HEALTH SERVICES		5036 013120	20000062	1/1/2020 012320	1,660,733	1,700.00	1/31/2020 PD	MONTHLY LICENSED BED ASSESSMENTS	43853
638	WI DEPT OF HEALTH SERVICES		5049 013120	20000062	1/1/2020 012320	1,660,733	1,700.00	1/31/2020 PD	MONTHLY LICENSED BED ASSESSMENTS	43853
638	WI DEPT OF HEALTH SERVICES		5050 013120	20000062	1/1/2020 012320	1,660,733	1,700.00	1/31/2020 PD	MONTHLY LICENSED BED ASSESSMENTS	43853
638	WI DEPT OF HEALTH SERVICES		2977 013120	20000062	1/1/2020 012320	1,660,733	41,860.00	1/31/2020 PD	MONTHLY LICENSED BED ASSESSMENTS	43853
638	WI DEPT OF HEALTH SERVICES		2380 013120	20000062	1/1/2020 012320	1,660,733	20,400.00	1/31/2020 PD	MONTHLY LICENSED BED ASSESSMENTS	43853
						1,660,733 Total	74,160.00			
751	NATIONWIDE TRUST COMPANY FSB		NR01242020		1/23/2020 012420	1,660,751	15,754.50	1/24/2020 PD	DEFERRED COMPENSATION	43854
						1,660,751 Total	15,754.50			
453	ANGUS-YOUNG ASSOCIATES INC		68190-5		1/1/2020 02062020	1,660,761	2,920.00	1/31/2020 PD	DODGE COUNTY LEC PROJECT (2019) 1902.5822	43867
453	ANGUS-YOUNG ASSOCIATES INC		54264-6		1/9/2020 02062020	1,660,761	50,225.35	2/8/2020 PD	REESEVILLE DESIGN/BIDDING DOCU	43867
						1,660,761 Total	53,145.35			
1395	ARAMARK SERVICES INC	ARAMARK CORRECTIONAL SERVICES	200790600-000922		1/8/2020 02062020	1,660,763	11,886.97	2/7/2020 PD	INMATE MEALS 1/2-1/8/20	43867
						1,660,763 Total	11,886.97			
1395	ARAMARK SERVICES INC	ARAMARK CORRECTIONAL SERVICES	200790600-000924		1/15/2020 02062020	1,660,764	12,050.56	2/14/2020 PD	INMATE MEALS 1/9-1/15/20	43867
						1,660,764 Total	12,050.56			
584	BEAVER DAM COMMUNITY LIBRARY		LIB 2020		2/3/2020 02062020	1,660,769	266,357.00	2/3/2020 PD	2020 LIBRARY PAYMENT	43867
						1,660,769 Total	266,357.00			
1013	BROWNSVILLE PUBLIC LIBRARY		LIB 2020		2/3/2020 02062020	1,660,774	31,970.00	2/3/2020 PD	2020 LIBRARY PAYMENT	43867
						1,660,774 Total	31,970.00			
502	CITY OF WATERTOWN	C WTTN CHBK PYMT			1/23/2020 02062020	1,660,781	12,446.20	2/3/2020 PD	2018 ROLL REFUNDED PP TAX 291-9000-5050-000	43867
						1,660,781 Total	12,446.20			
460	COUNTY OF FOND DU LAC		11302019		12/9/2019 02062020	1,660,785	10,800.00	2/7/2020 PD	ACUTE UNIT SERVICES	43867
						1,660,785 Total	10,800.00			

150	Cole Oil & Propane	3831985		1/7/2020 02062020	1,660,787	27.22	2/6/2020 PD	FUEL	43867
150	Cole Oil & Propane	3845818		1/8/2020 02062020	1,660,787	55.32	2/7/2020 PD	GAS	43867
150	Cole Oil & Propane	3845819		1/9/2020 02062020	1,660,787	226.73	2/8/2020 PD	FUEL	43867
150	Cole Oil & Propane	3843820		1/12/2002 02062020	1,660,787	3,450.59	2/11/2002 PD	FUEL	43867
150	Cole Oil & Propane	3843821		1/13/2020 02062020	1,660,787	1,010.60	2/12/2020 PD	FUEL	43867
150	Cole Oil & Propane	970543		1/10/2020 02062020	1,660,787	2,821.04	2/9/2020 PD	DIESEL	43867
150	Cole Oil & Propane	972435		1/16/2020 02062020	1,660,787	3,463.29	2/15/2020 PD	DIESEL	43867
					1,660,787 Total	11,054.79			
544	COLUMBUS PUBLIC LIBRARY	LIB 2020		2/3/2020 02062020	1,660,788	47,033.00	2/3/2020 PD	2020 LIBRARY PAYMENT	43867
					1,660,788 Total	47,033.00			
141	EDWARD H WOLF & SONS INC	244747		1/23/2020 02062020	1,660,799	16,894.34	2/2/2020 PD	FUEL	43867
141	EDWARD H WOLF & SONS INC	244631		1/22/2020 02062020	1,660,799	16,796.42	2/1/2020 PD	FUEL	43867
					1,660,799 Total	33,690.76			
549	FOX LAKE PUBLIC LIBRARY	LIB 2020		2/3/2020 02062020	1,660,807	32,392.00	2/3/2020 PD	2020 LIBRARY PAYMENT	43867
					1,660,807 Total	32,392.00			
1191	HEARTLAND BUSINESS SYSTEMS LLC	354361-H		1/9/2020 02062020	1,660,811	370.00	2/8/2020 PD	FD HIGH SPEED DRIVER, ADDON LICENSE & ANNL SFTWR	43867
1191	HEARTLAND BUSINESS SYSTEMS LLC	954372-H		1/9/2020 02062020	1,660,811	16,114.75	2/8/2020 PD	FILE DIRECTOR SUPPORT RENEWAL	43867
					1,660,811 Total	16,484.75			
1017	HORICON PUBLIC LIBRARY	LIB 2020		2/3/2020 02062020	1,660,812	46,105.00	2/3/2020 PD	2020 LIBRARY PAYMENT	43867
					1,660,812 Total	46,105.00			
588	HUSTISFORD COMMUNITY LIBRARY	LIB 2020		2/3/2020 02062020	1,660,813	64,764.00	2/3/2020 PD	2020 LIBRARY PAYMENT	43867
					1,660,813 Total	64,764.00			
746	HUTCHINSON MEMORIAL LIBRARY	LIB 2020		2/3/2020 02062020	1,660,815	16,296.00	2/3/2020 PD	2020 LIBRARY PAYMENT	43867
					1,660,815 Total	16,296.00			
551	IRON RIDGE PUBLIC LIBRARY	LIB 2020		2/3/2020 02062020	1,660,818	12,488.00	2/3/2020 PD	2020 LIBRARY PAYMENT	43867
					1,660,818 Total	12,488.00			
589	JACK RUSSELL MEMORIAL COMMUNITY LIBRARY	LIB 2020		2/3/2020 02062020	1,660,820	61,916.00	2/3/2020 PD	2020 LIBRARY PAYMENT	43867
					1,660,820 Total	61,916.00			
554	JUNEAU PUBLIC LIBRARY	LIB 2020		2/3/2020 02062020	1,660,827	72,595.00	2/3/2020 PD	2020 LIBRARY PAYMENT	43867
					1,660,827 Total	72,595.00			
555	KARL JUNGINGER MEMORIAL LIBRARY	LIB 2020		2/3/2020 02062020	1,660,830	38,538.00	2/3/2020 PD	2020 LIBRARY PAYMENT	43867
					1,660,830 Total	38,538.00			
749	LOMIRA QUAD GRAPHICS COMMUNITY LIBRARY	LIB 2020		2/3/2020 02062020	1,660,844	13,300.00	2/3/2020 PD	2020 LIBRARY PAYMENT	43867
					1,660,844 Total	13,300.00			
561	MAYVILLE PUBLIC LIBRARY	LIB 2020		2/3/2020 02062020	1,660,848	50,775.00	2/3/2020 PD	2020 LIBRARY PAYMENT	43867
					1,660,848 Total	50,775.00			
751	NATIONWIDE TRUST COMPANY FSB	1152020 C SCHWAB		1/23/2020 02062020	1,660,856	16,479.54	1/24/2020 PD	PEHP PLAN PAYOUT CAROL SCWAB	43867
					1,660,856 Total	16,479.54			
751	NATIONWIDE TRUST COMPANY FSB	01052020-P KACZMARSK		1/21/2020 02062020	1,660,857	21,342.72	1/24/2020 PD	PEHP PAYOUT PETER KACZMARSKI	43867
					1,660,857 Total	21,342.72			
751	NATIONWIDE TRUST COMPANY FSB	01092020 L LOTHEN		1/23/2020 02062020	1,660,858	24,168.96	1/24/2020 PD	PEHP PLAN PAYOUT LYNN LOTHEN	43867
					1,660,858 Total	24,168.96			
567	OCONOMOWOC PUBLIC LIBRARY	LIB 2020		2/3/2020 02062020	1,660,861	38,376.00	2/3/2020 PD	2020 LIBRARY PAYMENT	43867
					1,660,861 Total	38,376.00			
1387	OTIS ELEVATOR CO	CMM05350120		12/20/2019 02062020	1,660,946	19,015.52	1/19/2020 PD	ELEVATOR SERVICE/MAINTENANCE	43867
1387	OTIS ELEVATOR CO	CMM65301P819		1/15/2020 02062020	1,660,946	325.17	2/14/2020 PD	SERVICE	43867
					1,660,946 Total	19,340.69			
574	REESEVILLE PUBLIC LIBRARY	LIB 2020		2/3/2020 02062020	1,660,957	20,548.00	2/3/2020 PD	2020 LIBRARY PAYMENT	43867
					1,660,957 Total	20,548.00			
578	TOWN HALL LIBRARY	LIB 2020		2/3/2020 02062020	1,660,974	12,988.00	2/3/2020 PD	2020 LIBRARY PAYMENT	43867
					1,660,974 Total	12,988.00			
1519	VOGEL TRAFFIC SERVICES INC	EZ LINER I	066596	1/1/2020 02062020	1,660,980	449,228.00	1/31/2020 PD	PAINT TRUCK	43867
					1,660,980 Total	449,228.00			
579	WATERTOWN PUBLIC LIBRARY	LIB 2020		2/3/2020 02062020	1,660,982	69,901.00	2/3/2020 PD	2020 LIBRARY PAYMENT	43867
					1,660,982 Total	69,901.00			
582	WAUPUN PUBLIC LIBRARY	LIB 2020		2/3/2020 02062020	1,660,985	46,197.00	2/3/2020 PD	2020 LIBRARY PAYMENT	43867
					1,660,985 Total	46,197.00			
294	WESTERN CULVERT & SUPPLY INC	059640		1/10/2020 02062020	1,660,987	1,889.00	2/9/2020 PD	GUARDRAIL SUPPLIES	43867
294	WESTERN CULVERT & SUPPLY INC	059659		1/17/2020 02062020	1,660,987	10,949.00	2/16/2020 PD	MATERIALS	43867
					1,660,987 Total	12,838.00			
664	WI DEPT OF ADMINISTRATION	MARRIAGE DOG LICENSE		1/30/2020 02062020	1,660,992	11,580.03	2/6/2020 PD	MARRIAGE DOG LICENSE FEES 2019 DODGE CTY	43867
					1,660,992 Total	11,580.03			
688	WI DEPT OF HEALTH SERVICES	435-000059026		1/1/2020 02062020	1,660,994	170,553.75	1/31/2020 PD	FAMILY CARE CONTRIBUTION 11.01.19 to 01.31.20	43867
					1,660,994 Total	170,553.75			
1195	WISCONSIN MUNICIPAL MUTUAL INSURANCE COMPANY	WMMIC	1915	1/1/2020 02062020	1,661,000	311,493.00	1/1/2020 PD	AUTO GENERAL CYBER LIABILITY INS ERRORS & OMMISSIO	43867
					1,661,000 Total	311,493.00			
751	NATIONWIDE TRUST COMPANY FSB	NR02072020		2/7/2020 02072020	1,661,015	14,264.50	2/7/2020 PD	Deferred Compensation	43868
					1,661,015 Total	14,264.50			

814	CLINICARE CORP	EAU CLAIRE ACADEMY	814020520201	2/5/2020	02014	1,661,025	12,464.79	2/13/2020	PD	0008020569	43875
						1,661,025 Total	12,464.79				
1431	FAMILY SERVICES OF NORTHEAST WISCONSIN INC		1431020520201	2/5/2020	02014	1,661,030	10,807.22	2/13/2020	PD	0008020562	43875
						1,661,030 Total	10,807.22				
394	TOMORROWS CHILDREN INC		394020520201	2/5/2020	02014	1,661,049	10,509.00	2/13/2020	PD	0008021021	43875
394	TOMORROWS CHILDREN INC		394020520202	2/5/2020	02014	1,661,049	10,509.00	2/13/2020	PD	0008021021	43875
						1,661,049 Total	21,018.00				
647	STATE OF WISCONSIN		JAN 2020	2/14/2020	DD021420	2,004,401	65,044.80	2/14/2020	PD	TRANSFER FEES DUE STATE JANUARY 2020	43875
						2,004,401 Total	65,044.80				
1368	DELTA DENTAL		331294	1/8/2020	DD010820	200,070,121	11,927.41	1/8/2020	PD	DELTA DENTAL WI ASO PYMT	43838
						200,070,121 Total	11,927.41				
617	INTERNAL REVENUE SERVICE		FED PYMT 01-10-20	1/10/2020	DD011020	200,090,081	441,246.49	1/13/2020	PD	FED TAX PYMT 01-10-2020	43840
						200,090,081 Total	441,246.49				
1341	US BANK		USB 01-10-20	1/10/2020	DD011020	200,100,097	101,518.64	1/11/2020	PD	NON-EBC EE/ER CONTRIBUTIONS	43840
						200,100,097 Total	101,518.64				
744	EMPLOYEE BENEFIT CORPORATION (EBC)		EBC 01-10-2020	1/10/2020	DD011020	200,100,038	188,108.95	1/11/2020	PD	EBC EE/ER CONTRIBUTIONS	43840
						200,100,038 Total	188,108.95				
1505	BOND TRUST SERVICES CORPORATION		52511	1/30/2020	DD013020	200,130,031	12,075.00	1/30/2020	PD	INTEREST PAYMENTS REF #37662	43860
1505	BOND TRUST SERVICES CORPORATION		52512	1/30/2020	DD013020	200,130,031	119,825.01	1/30/2020	PD	INTEREST PAYMENTS REF #329726	43860
						200,130,031 Total	131,900.01				
647	STATE OF WISCONSIN		01142020	1/14/2020	DD011420	200,130,203	60,996.96	1/14/2020	PD	TRANSFER FEES DUE STATE DEC 2019	43844
						200,130,203 Total	60,996.96				
643	WI DEPT OF REVENUE		12-16-31-2019	1/15/2020	WIRE_001	200,140,089	78,652.81	1/15/2020	PD	STATE TAX DODGE COUNTY	43845
643	WI DEPT OF REVENUE		L1617597520	1/15/2020	WIRE_001	200,140,089	10.00	1/15/2020	PD	BUSINESS TAX REGISTRATION	43845
						200,140,089 Total	78,662.81				
1341	US BANK		USBANK01102020	1/15/2020	DD011520	200,150,105	302,572.77	1/16/2020	PD	USBANK PYMT 01-10-2020	43845
						200,150,105 Total	302,572.77				
1368	DELTA DENTAL		336296	1/22/2020	DD012220	200,210,142	15,941.54	1/22/2020	PD	DELTA DENTAL WI ASO PYMT	43852
						200,210,142 Total	15,941.54				
744	EMPLOYEE BENEFIT CORPORATION (EBC)		EBC01242020	1/23/2020	DD012320	200,230,020	18,313.95	1/23/2020	PD	EBC EE/ER CONTRIBUTIONS	43853
						200,230,020 Total	18,313.95				
617	INTERNAL REVENUE SERVICE		01242020	1/24/2020	DD012420	200,230,039	408,139.39	1/24/2020	PD	FED TAX PYMT DODGE CO 01/24/2020	43854
						200,230,039 Total	408,139.39				
1341	US BANK		USB01242020	1/24/2020	DD012420	200,240,090	15,174.50	1/24/2020	PD	NON EBC EE/ER CONTRIBUTIONS	43854
						200,240,090 Total	15,174.50				
1368	DELTA DENTAL		337451	1/29/2020	DD012920	200,280,116	19,186.58	1/29/2020	PD	DELTA DENTAL WI ASO PYMT 012720	43859
						200,280,116 Total	19,186.58				
636	WI DEPT OF EMPLOYEE TRUST FUNDS		DEC 2019	1/31/2020	DD013120	200,290,112	476,330.98	1/31/2020	PD	WRS - DODGE COUNTY	43861
						200,290,112 Total	476,330.98				
643	WI DEPT OF REVENUE		WI013120	1/31/2020	DD013120	200,300,141	92,200.03	1/31/2020	PD	STATE TAX DODGE CO	43861
						200,300,141 Total	92,200.03				
1368	DELTA DENTAL		338613	2/5/2020	DD020520	200,350,041	17,461.84	2/5/2020	PD	DELTA DENTAL WI ASO PMT 020920	43866
						200,350,041 Total	17,461.84				
617	INTERNAL REVENUE SERVICE		02072020	2/7/2020	DD020720	200,370,027	399,666.86	2/7/2020	PD	FEDERAL TAX PYMT DODGE CO	43868
						200,370,027 Total	399,666.86				
1341	US BANK		USB02072020	2/7/2020	DD020720	200,380,088	12,903.75	2/7/2020	PD	NON EBC EE/ER CONTRIBUTIONS	43868
						200,380,088 Total	12,903.75				
744	EMPLOYEE BENEFIT CORPORATION (EBC)		EBC02072020	2/7/2020	DD020720	200,380,089	15,170.35	2/7/2020	PD	EBC EE/ER CONTRIBUTIONS	43868
						200,380,089 Total	15,170.35				
643	WI DEPT OF REVENUE		WI02142020	2/14/2020	DD021420	200,440,126	82,835.65	4/14/2020	PD	STATE TAX - DODGE COUNTY	43875
						200,440,126 Total	82,835.65				
						Grand Total	8,482,226.58				

Resolution Ordering the Establishment of the Beaver Dam Lake District

TO THE HONORABLE BOARD OF SUPERVISORS OF DODGE COUNTY, WISCONSIN,

WHEREAS, the Dodge County Board of Supervisors received a Petition requesting the Dodge County Board of Supervisors establish a Public Inland Lake Protection and Rehabilitation District for Beaver Dam Lake pursuant to Chapter 33, of the *Wisconsin Statutes*, the boundary of such Public Inland Lake Protection and Rehabilitation District being described in Exhibit "A", which is attached hereto and incorporated herein; and,

WHEREAS, the above-described Petition was received by the Dodge County Board of Supervisors on September 10, 2019; and,

WHEREAS, at its meetings on September 17, 2019, the Dodge County Board of Supervisors appointed the Land Resources and Parks Committee for purposes of conducting a public hearing regarding the Petition, as required by § 33.26(1), Wis. Stats., and preparing a report; and,

WHEREAS, such public hearing was held on October 3, 2019, by the Land Resources and Parks Committee; and,

WHEREAS, the Land Resources and Parks Committee, having considered the Petition, the public hearing testimony, the written statements submitted to it, and the requirements of the Chapter 33, of the *Wisconsin Statutes*, has prepared a Report as required by § 33.26(3), Wis. Stats.; and,

WHEREAS, a copy of the Land Resources and Parks Committee Report is attached hereto and incorporated herein as Exhibit "B"; and,

WHEREAS, the Land Resources and Parks Committee finds:

1. That a Petition requesting the formation of a Public Inland Lake Protection and Rehabilitation District for Beaver Dam Lake was received by the Dodge County Board of Supervisors on September 10, 2019;
2. That a public hearing was held on October 3, 2019, at the Dodge County Administration Building to receive testimony and statements regarding the Petition;
3. That the Land Resources and Parks Department and Dodge County Clerk staff determined the total number of valid signatures consisting of at least 51% of landowners in the proposed District is 714, and that 730 valid signatures were presented;

4. That the Petition to form the District was signed by the requisite number of owners as required by § 33.25, Wis. Stats.;
5. That the proposed District is necessary;
6. That public health, comfort, convenience, necessity and public welfare will be promoted by the establishment of the District;
7. That the property to be included in the District as proposed by the Petition will be benefited by the District's establishment; and,
8. That the proposed boundaries of the District are as described on the attached map/sketch, attached hereto and incorporated herein as Exhibit "A";

SO, NOW, THEREFORE, BE IT RESOLVED, by the Dodge County Board of Supervisors that after consideration of the Land Resources and Park Committee's Report and other evidence submitted to the Dodge County Board of Supervisors, the Dodge County Board of Supervisors adopts the following findings:

1. That a Petition requesting the formation of a Public Inland Lake Protection and Rehabilitation District for Beaver Dam Lake was received by the Dodge County Board of Supervisors on September 10, 2019;
2. That a public hearing was held on October 3, 2019, at the Dodge County Administration Building to receive testimony and statements regarding the Petition, which public hearing was conducted in accordance with the required statutory time limits;
3. That the Land Resources and Parks Department and Dodge County Clerk staff determined the total number of valid signatures consisting of at least 51% of landowners in the proposed District is 714, and that 730 valid signatures were presented;
4. That the Land Resources and Parks Committee prepared and submitted a Report, attached hereto as Exhibit "B", as required by § 33.26(3), Wis. Stats., which Report was submitted in accordance with the required statutory time limits;
5. That the Petition to form the District was signed by the requisite number of owners as required by § 33.25, Wis. Stats.;
6. That the proposed District is necessary;
7. That public health, comfort, convenience, necessity and public welfare will be promoted by the establishment of the District;

8. That the property to be included in the District as proposed by the Petition will be benefited by the District's establishment; and,
9. That the proposed boundaries of the District are as described on the attached map/sketch, attached hereto and incorporated herein as Exhibit "A"; and,

BE IT FURTHER RESOLVED, that the Dodge County Board of Supervisors accepts the Report of Land Resources and Parks Committee as presented on December 17, 2019; and,

BE IT FURTHER RESOLVED, that it is ordered by the Dodge County Board of Supervisors, pursuant to Chapter 33, of the *Wisconsin Statutes*, that the Beaver Dam Lake District is hereby organized and established; and,

BE IT FURTHER RESOLVED, that it is ordered by the Dodge County Board of Supervisors, pursuant to Chapter 33, of the *Wisconsin Statutes*, that the boundaries of the Beaver Dam Lake District are hereby established as those described on the attached map/sketch, attached hereto and incorporated herein as Exhibit "A"; and,

BE IT FINALLY RESOLVED, that it is ordered by the Dodge County Board of Supervisors, pursuant to Chapter 33, of the *Wisconsin Statutes*, that the District shall be a body corporate to the extent provided by Chapter 33, of the *Wisconsin Statutes*, and shall be known as the Beaver Dam Lake District.

All of which is respectfully submitted this 18th day of February, 2020.

Dodge County Land Resources and Parks Committee

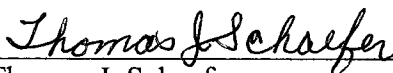

Thomas J. Schaefer

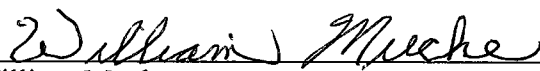

William Muche



Joseph Marsik

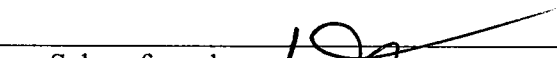

Larry Schraufnagel

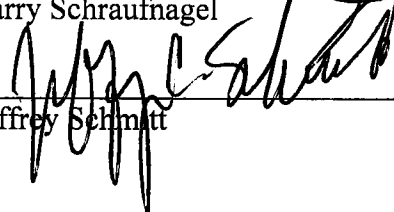

Jeffrey Schmitt

Vote Required: Majority of Members present.

Resolution Summary: Resolution ordering the establishment of the Beaver Dam Lake District.

**Beaver Dam Lake District
Proposed Boundaries
Exhibit A**

The data used to create this map is a compilation of records, information, and data from various city, county and state offices, and other sources. This map is only advisory, does not replace a survey, and may not be used for any legal purpose. Dodge County assumes no liability for any use or misuse of this information.

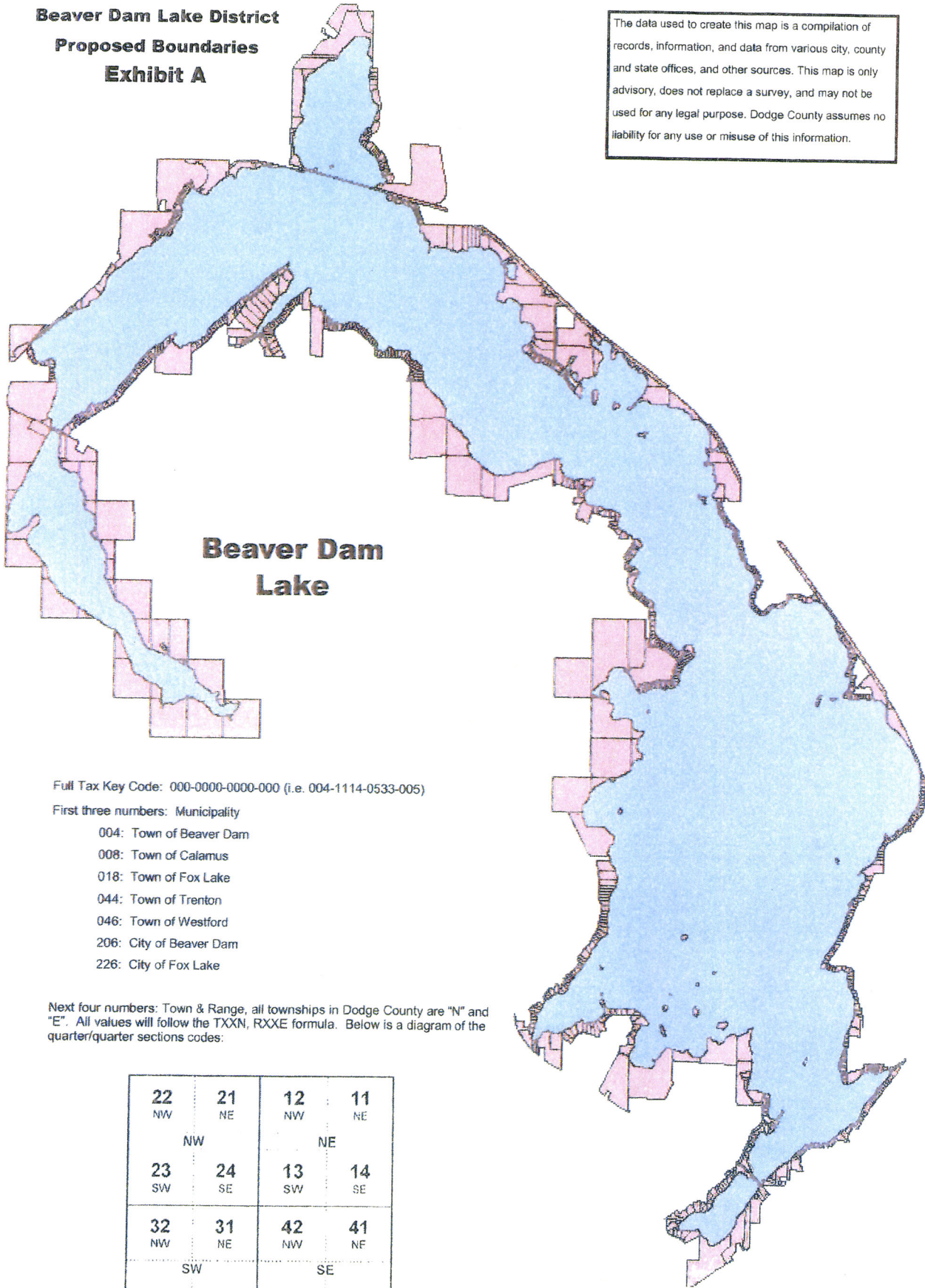

Full Tax Key Code: 000-0000-0000-000 (i.e. 004-1114-0533-005)

First three numbers: Municipality

- 004: Town of Beaver Dam
- 008: Town of Calamus
- 018: Town of Fox Lake
- 044: Town of Trenton
- 046: Town of Westford
- 206: City of Beaver Dam
- 226: City of Fox Lake

Next four numbers: Town & Range, all townships in Dodge County are "N" and "E". All values will follow the TXXN, RXXE formula. Below is a diagram of the quarter/quarter sections codes:

22 NW	21 NE	12 NW	11 NE
NW		NE	
23 SW	24 SE	13 SW	14 SE
SW		SE	
32 NW	31 NE	42 NW	41 NE
SW		SE	
33 SW	34 SE	43 SW	44 SE

Last three numbers: the lot number within that quarter/quarter

TO THE HONORABLE BOARD OF SUPERVISORS OF DODGE COUNTY, WISCONSIN,

WHEREAS, pursuant to Chapter 33 of the *Wisconsin Statutes*, a Petition was submitted to the Dodge County Board of Supervisors by filing same with the Dodge County Clerk on September 10, 2019, requesting the establishment of a Public Inland Lake Protection and Rehabilitation District to be known as the Beaver Dam Lake District; and,

WHEREAS, said Petition states that the proposed District is necessary to deal with the complex resource problems associated with the Beaver Dam Lake, including poor water quality, eroding shorelines, excessive carp, algae outbreaks, periodic excessive growth of invasive aquatic plants, and non-point runoff of sediment and nutrients into the lake; and,

WHEREAS, on September 17, 2019, at a regular meeting of the Dodge County Board of Supervisors, the Land Resources and Parks Committee was appointed by the Dodge County Board of Supervisors to conduct a public hearing on said Petition and prepare a report to the Dodge County Board of Supervisors; and,

WHEREAS, a Public Hearing was conducted on October 3, 2019, at 5:30 p.m., in the First Floor Auditorium, Rooms F, G, H, and I of the Dodge County Administration Building, located at 127 E. Oak Street, Juneau, Wisconsin; and,

WHEREAS, the Dodge County Land Resources and Parks Committee makes the following Report to the Dodge County Board of Supervisors and submits same within three (3) months of the public hearing as required by § 33.26(3), Wis. Stats.;

REPORT

Petition.

On September 10, 2019, a Petition was submitted to the Dodge County Board of Supervisors by filing with the Dodge County Clerk requesting the establishment of an Inland Lake Protection and Rehabilitation District pursuant to § 33.21, Wis. Stats. (Attachment Nos. 1 and 2). As required by § 33.25(2), Wis. Stats., the Petition contains all of the following:

1. Proposed name of the district: Beaver Dam Lake District;
2. A description of the necessity of the proposed district;
3. That public health, comfort, convenience, necessity or public welfare will be promoted by the establishment of the district and the lands proposed to be included in the district will be benefited; and,
4. A map/sketch of the proposed district boundaries and a list of Parcel Identification Numbers (PINs) associated with the lands to be included in the proposed district.

Validation of Signatures.

Upon receipt of the Petition, Dodge County staff began the signature validation process. Karen Gibson, Dodge County Clerk, and David Addison, Land Information Manager, independently

conducted the validation process and met thereafter to review the results. Because the Petition was submitted in 2019, the 2018 tax roll for the affected municipalities was used to identify landowners in the proposed district and determine signature validity. Dodge County staff reported the following:

1. Total number of landowners in the proposed district according to the 2018 tax roll=1,399;
2. Total number of signatures needed to achieve at least 51% of landowners in the proposed district=714;
3. Total number of valid signatures obtained=730; and,
4. The Petition contains the requisite number of valid signatures.

Public Notice.

At its meeting on September 17, 2019, the Land Resources and Parks Committee scheduled the public hearing on the petition for October 3, 2019, at 5:30 p.m. The public hearing date falls within thirty (30) days of receipt of the petition as required by § 33.26(1), Wis. Stats. A public hearing notice was prepared, mailed, and published (Attachment No. 3). On September 20, 2019, the Dodge County Clerk's Office mailed the public hearing notice to landowners in the proposed district, whose name and address appeared on the December, 2018 Dodge County tax roll. The Department of Natural Resources was notified by mail of the public hearing date. Notice of the public hearing, as required by § 33.26(2), Wis. Stats., was published in the Beaver Dam Daily Citizen on September 23, 2019 (Attachment No. 4).

Summary of Written Statements Submitted.

Prior to or on October 3, 2019, the following information was received in the Dodge County Clerk's Office:

1. Written comments from twenty-nine (29) individuals who are opposed to the establishment of the Beaver Dam Lake District.
2. Written comments from thirteen (13) individuals who are in favor of the Beaver Dam Lake District.
3. Written comments from one (1) individual who does not appear to be opposed or in favor of the Beaver Dam Lake District, but instead provided suggestions or questions.
4. The County Clerk received no written requests to withdraw from the petition from landowners who signed the petition. Pursuant to §33.25(5), Wis. Stats., such written notices are required to be filed at least 10 days prior to the date of the public hearing.

Public Hearing Conducted.

On October 3, 2019, at 5:30 p.m., the Public Hearing was conducted by the Dodge County Land Resources and Parks Committee in the Dodge County Administration Building, located at 127 E. Oak Street, Juneau, Wisconsin. Thomas Schaefer, Committee Chair, convened the meeting at approximately 5:30 p.m. After roll call, the Dodge County Corporation Counsel reviewed the role of Dodge County in the process to form a lake district. Thereafter, a presentation was given by Michael Engleson, Wisconsin Lakes Executive Director. Finally, representatives from the Beaver Dam Lake Improvement Association presented the Petition to the Committee. The Committee Chair

then reviewed the procedures for public hearing testimony and declared the public hearing open. Approximately 38 people signed in at the registration table to provide testimony. During the Public Hearing, the Dodge County Clerk called the names of the individuals present wishing to provide testimony. Names were called in the order in which they were received. Approximately 20 registered to speak in favor, 18 requested to speak in opposition, or provided general comments during the public hearing. Not all registrants, however, provided testimony. A court reporter recorded the public hearing testimony and a transcript was prepared (Attachment No. 5). Approximately 125 people attended the public hearing.

The Land Resources and Parks Committee Chair, after it appeared that all members of the public present wishing to comment had been given the opportunity to do so, declared the Public Hearing closed. Meeting minutes of the Land Resources and Parks Committee were prepared. (Attachment No. 5).

Summary of Public Hearing Testimony.

Thirty-eight (38) individuals registered to provide testimony; twenty (20) in favor and eighteen (18) opposed. Testimony of thirty-two (32) public speakers was given. According to the hearing transcript, nineteen (19) speakers testified in support of the formation of the Beaver Dam Lake District. Thirteen (13) speakers testified in opposition to the formation of the Beaver Dam Lake District.

Following are excerpts of testimony in **favor** of the formation of the lake district:

- A lake district is a formal, structured organization with taxing authority and governance set by law; provides structural and financial strength to take on the challenges of the lake;
- Provides for an organized effort to address the increase in phosphorus in the lake which spurs algae growth; public health will be improved when the algae blooms are controlled or eliminated;
- Ability to control or eradicate aquatic invasive species in and around the lake;
- Lake district commissioners provide continuity for the organization unlike volunteer leaders and members of a lake association;
- Ability to improve water quality and natural habitat for fowl and fish;
- Ability to maintain the lake for the enjoyment of those who live around it and for the general public for water recreation such as swimming, boating, jet skiing, water skiing, paddle boarding, kayaking, fishing, enjoying the natural beauty/quality of life;
- Improve the lake and maintain property values;
- A lake district has access to grant opportunities and other sources to fund, in conjunction with tax revenues, water quality initiatives; ability to tap into DNR resources;
- The proposed district includes approximately 800 properties which will provide a reasonable tax base without overburdening lake property owners;
- Property owners within the lake district will have a voice in the management of the lake; voting rights to elect commissioners, set budgets, establish lake management plans and priorities;
- Beaver Dam Chamber of Commerce, on behalf of the business community, supports the lake district as a means to provide a healthy lake which will attract users of the lake for fishing,

boating and recreation; quality of life in the County which may attract new residents to grow the County tax base;

- Healthy lake with improved water quality will maintain and improve property values for all;
- A lake district has the strength to take action to address issues so that all can enjoy the lake; ability to develop and implement lake management plans and projects;
- Promote public health by encouraging water activities/recreation; will attract people to the area, tourism; and,
- Coordinated efforts, working in collaboration with farmers and agricultural associations to address run-off, fertilizers/phosphorus (natural and chemical) entering the lake.

Following are excerpts of testimony **opposed** to the formation of the lake district:

- Don't want another tax; all properties in the area should be included not just those parcels that touch the lake;
- Algae blooms are due to non-point source pollution; fertilizer; run-off from farm fields; bad farming practices like spreading treated sewage on fields;
- Object to the petition process; signatures were not obtained in a timely fashion; petitioners made false promises and engaged in a sales job to get signatures;
- The lake is a marsh and cannot be fixed; lake district will not eliminate the algae, bullheads, carp, weeds;
- Need to address the entire watershed in order to address the water quality;
- City of Beaver Dam storm sewers discharge into the lake; this needs to be addressed to improve water quality; double tax on water discharge;
- Many sources contribute to lake problems, everyone (local community, businesses, general public, lake property owners) benefits from improved water quality and a healthy lake; everyone is responsible for the care of the lake; burden should not just be on lake property owners; lake property taxes are already too high; don't want to pay more taxes; and,
- Another government entity; duplication of government; let the DNR take care of the lake; enforce regulations to improve water quality.

At the conclusion of the Public Hearing, the Beaver Dam Chamber of Commerce submitted a resolution in support of the formation of the lake district (Attachment No. 6).

FINDINGS

Based on a review of the Petition submitted on September 10, 2019, requesting the formation of the Beaver Dam Lake District, the validation process undertaken by staff of the signatures included on the Petition, the Public Hearing testimony offered on October 3, 2019, a review of the complete transcript of the Public Hearing, a review of all timely submitted written statements/comments, the Land Resources and Parks Committee hereby finds that there is sufficient evidence to support the following findings:

1. **The Petition is signed by the requisite number of owners of land in the proposed district.** According to the 2018 tax rolls for the affected taxing districts, there are 1,399 landowners in the proposed district. The total number of signatures needed to achieve at

least 51% of landowners in the proposed district is 714. The total number of valid signatures obtained is 730.

2. **The proposed district is necessary.** The Committee heard testimony describing the limitations of a lake association organization and the benefits of forming a lake district. Testimony was presented indicating that it is now necessary to form a district to overcome the limitations of an association. The district, as a formal, recognized unit of government governed by statute with representation by all property owners within the boundaries, is necessary for the establishment and advancement of the lake management plans and priorities to provide the best opportunity to improve the quality of the lake for the benefit of all. The district will have access to grant and other funding to implement lake management plans and priorities as decided by the owners within the district.
3. **Public health, comfort, convenience, necessity of public welfare will be promoted by the establishment of the proposed district.** The Committee heard testimony describing the benefits to the public health and welfare to be gained by improving water quality, controlling algae blooms by addressing erosion and run-off into the lake and controlling aquatic invasive species. In addition to the benefits to the lake property owners, the general public is benefited by access to a healthy lake for water recreational activities, potential increase in tourism which in turn may benefit local businesses and increase state and local sales tax revenues. There is agreement, even by those opposed, that the lake is degraded. The Committee believes that the formation of the district provides the best opportunity to address water quality, algae blooms, aquatic invasive species and other lake concerns.
4. **The property proposed to be included in the proposed district will be benefited by the establishment of the proposed district.** On the whole, parcels included in the proposed district will benefit by its formation. Property owners within the proposed district are afforded representation to establish plans, priorities and an annual budget to promote improved water quality, fish and wildlife habitats, control aquatic invasive species and to promote collaboration among stakeholders.
5. **The proposed boundaries of the district are as described on the attached map/sketch.** (Attachment No. 7).

RECOMMENDATION

The Land Resources and Parks Committee does hereby recommend to the Dodge County Board of Supervisors that, by County Board Resolution, an Order be issued to establish the Beaver Dam Lake District, and that the district be established with the same boundaries as those proposed in the original Petition to form the Beaver Dam Lake District (Attachment No. 6).

The Land Resources and Parks Committee does further recommend that the Dodge County Board of Supervisors require the district to provide a legal description identifying the district boundaries and lands to be included, consistent with the parcels listed in the Petition.

All of which is respectfully submitted this 17th day of December, 2019.

Dodge County Land Resources and Parks Committee

Thomas J. Schaefer

Thomas J. Schaefer

William M. Muehe

William Muehe

Joseph Marsik

Joseph Marsik

Larry Schraufnager
Jeffrey Schmitt

Jeffrey Schmitt

Placed on File

~~BY DODGE COUNTY BOARD~~
BY DODGE COUNTY BOARD

DEC 17 2019

AYES - NOES -
ABSENT
ABSTAIN

Karen J. Gibson
County Clerk

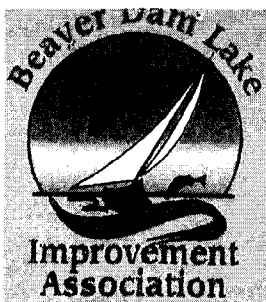

211 South Spring Street
Suite 3
P.O. Box 33
Beaver Dam, WI 53916

Office:
920.356.1200

Website:
www.bdlia.org

Email:
info@bdlia.org

A 501(c)(3) organization.
donations are tax deductible
as allowed by law.



**Happ's
REPAIR CENTER**

**KWIK
TRIP
STORES**

**Rechele's
Food Pride**

Jancy's Notions



**Bayside
SUPPER CLUB**



Montgomery Associates
Resource Solutions... mo-rs.org

Cabela's
WORLD'S PREMIER OUTFITTER

RECEIVED
IN THE OFFICE OF
COUNTY CLERK

SEP 10 2019

DODGE COUNTY, WIS.

September 9, 2019

Ms. Karen Gibson
Dodge County Clerk
127 E Oak St
Juneau WI 53039

Dear Ms. Gibson,

Submitted with this letter are 744 verified petitions supporting the Dodge County Board's establishment of the Beaver Dam Lake District under Chapter 33 of the Wisconsin Statutes. Each signatory is an owner of property within the proposed District as defined in Section 33.01(9)(ar) or the referenced spouse of such an owner.

The petitions are numbered and sorted by township/city in parcel ID order with the exception of petitions 741 - 744 which were received after we sorted by tax parcel and are in a separate folder at the end.

The Beaver Dam Lake Improvement Association conducted an extensive program to inform property owners about the proposed Lake District and solicit support for its formation. That program consisted of three phases:

1. Letters were sent to all property owners with attachments showing the proposed lake district, the reasons for the formation of a district, a petition and a return envelope
2. Eight public meetings were conducted where property owners were invited to get more information on the proposed district as well as ask questions.
3. Twelve Association volunteers visited property owners personally at their Beaver Dam Lake homes.

The effort to establish the District was also discussed in numerous articles in the local newspaper and updates and articles in the Beaver Dam Lake Improvement Associations newsletter, which was mailed to all 1,095 lake parcels. It was also presented at the association's annual meeting and at the monthly board meetings, which are all open to the public. The association membership overwhelmingly supports the formation of the district as indicated by the fact that 94% of members eligible to sign have signed the petition.

Under Section 33.26 the County is charged to consider a Lake District Petition signed by 51 percent of the qualified property owners. A careful review of the 2018 Tax Rolls of the Towns of Fox Lake, Trenton, Calamus, Beaver Dam and Westford and the City of Beaver Dam shows a total of 1381 persons eligible to sign the petition. Of those, we have

Attachment No. 1

Petition - Signature Pages Omitted - Signature Pages on File in the Office of the County Clerk

learned of 23 listed owners are now deceased, leaving a total of 1358 potential petition signatories. The 744 petitions submitted with this letter thus constitute 54.8% of the eligible signatories.

The boundaries of the proposed District include some territory within the City of Beaver Dam. As required under Section 33.24(2) (a), the Beaver Dam City Council approved the inclusion of the portion of the proposed District within its jurisdiction by a Resolution adopted April 16, 2018.

In the meetings with the property owners most agreed that the structure of a lake district provides stronger lake management with all lake owners having an opportunity to participate and gives greater ability to leverage state and federal sources for protecting and improving Beaver Dam Lake.

Our Association is aware that the statutory timetable for proceedings to form the Lake District requires speedy action by the County Board and staff. We stand ready to assist in that process as you request. We appreciate the County's consideration and hope the District can be established promptly and begin its important mission of protecting Beaver Dam Lake for generations to come.

For additional information or if questions please contact me at 920-210-0349 or via email at billboettge@yahoo.com

Sincerely,

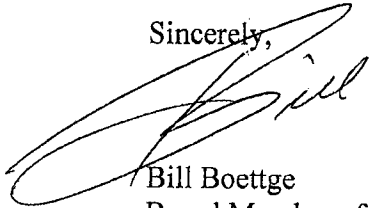
A handwritten signature in black ink, appearing to read "Bill", with a large, sweeping flourish underneath.

Bill Boettge
Board Member of BDLIA

**Beaver Dam Lake District
Proposed Boundaries
Exhibit A**

The data used to create this map is a compilation of records, information, and data from various city, county and state offices, and other sources. This map is only advisory, does not replace a survey, and may not be used for any legal purpose. Dodge County assumes no liability for any use or misuse of this information.

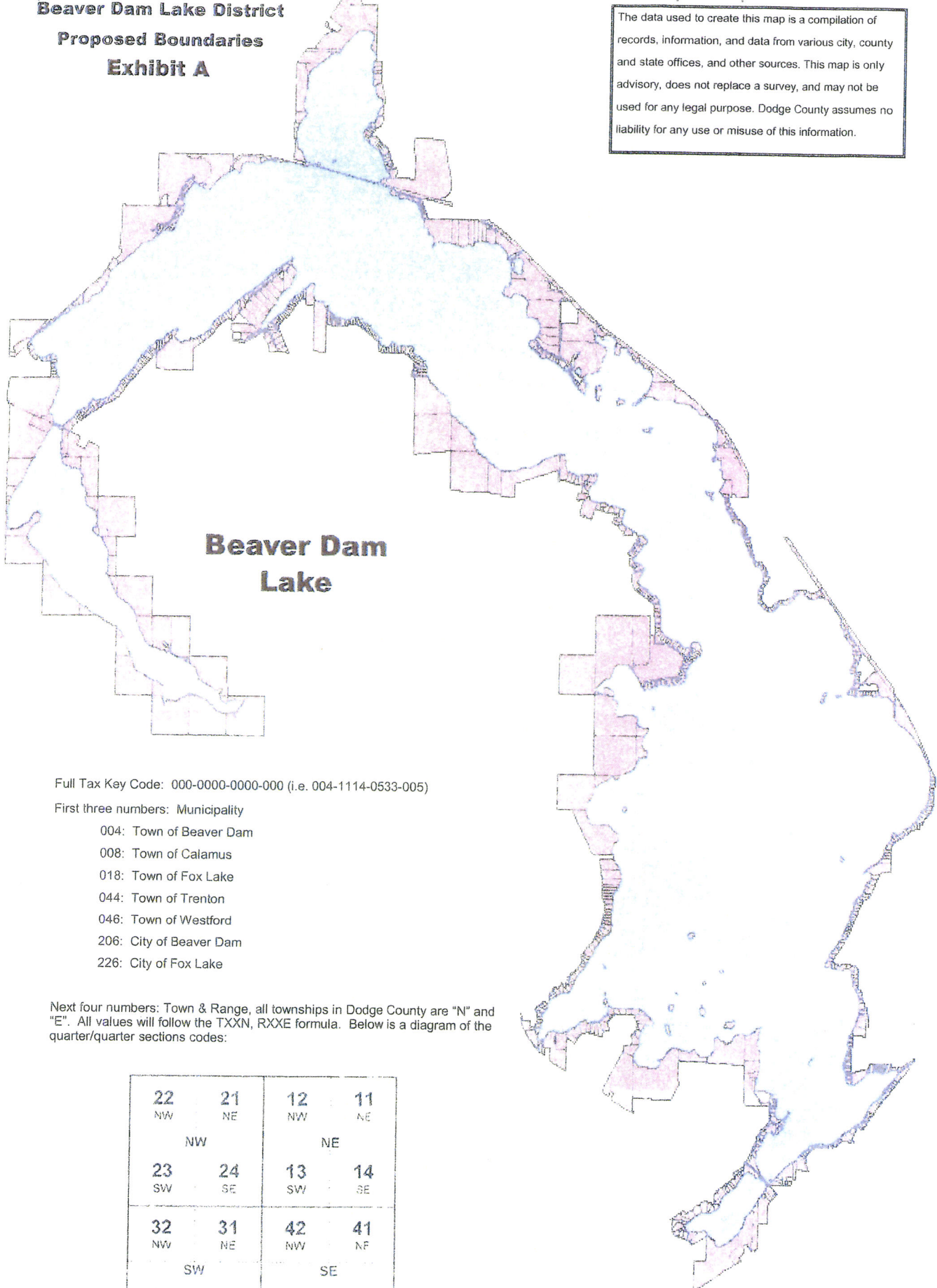

Full Tax Key Code: 000-0000-0000-000 (i.e. 004-1114-0533-005)

First three numbers: Municipality

- 004: Town of Beaver Dam
- 008: Town of Calamus
- 018: Town of Fox Lake
- 044: Town of Trenton
- 046: Town of Westford
- 206: City of Beaver Dam
- 226: City of Fox Lake

Next four numbers: Town & Range, all townships in Dodge County are "N" and "E". All values will follow the TXXN, RXXE formula. Below is a diagram of the quarter/quarter sections codes:

22 NW	21 NE	12 NW	11 NE
NW		NE	
23 SW	24 SE	13 SW	14 SE
SW		SE	
32 NW	31 NE	42 NW	41 NE
SW		SE	
33 SW	34 SE	43 SW	44 SE

Last three numbers: the lot number within that quarter/quarter

TOWN OF BEAVER DAM				00412142022019	TOWN OF WESTFORD									
00411140522000	00411140533004	00412142023008	00412142023019	04612130333000	04612141931000	04612132232001	04612130331003	04612131611004	04612131013006	04612131013008	04612131143010	04612131042013	04612141924017	04612131033004
00411140523000	00411140621004	00412142024008	00412142024019	04612130341000	04612141932000	04612133641001	046121303932003	04612131612004	04612131022006	04612131014008	04612131341010	04612131131013	04612130333018	04612131033005
00411140531000	00411140623004	00412142024008	00411140622020	04612130341000	04612141932000	04612133644001	04612130911003	04612131624004	04612131041006	04612131022008	04612131612010	04612131143013	04612130944018	04612131033006
00411140611000	00411140644004	00412142023008	00412142023020	04612130911000	04612141933000	04612141833001	04612130913003	04612133641004	04612131042006	04612131041008	04612133643010	04612131612013	04612131014018	04612131033007
00411140612000	00411140712004	004121420244008	00412142024020	04612130931000	04612141934000	04612141921001	04612130931003	04612141833004	04612131131006	04612131131008	04612133644010	04612133644013	04612131033018	04612131033008
00411140622000	00411140713004	00411140523009	00411140532021	04612130933000	04612141942000	04612141931001	04612130933003	04612141921004	04612131132006	04612131132008	04612141921013	04612141921013	04612131042018	TOWN OF TRENTON
00411140624000	00411140822004	00411140532009	00411140644021	04612130934000	04612143021000	04612141933001	04612130934003	04612141922004	04612131143006	04612131143008	04612141924010	04612141924013	04612131131018	04412140733000
00411140823000	00412141911004	00411140711009	00411140713021	04612131011000	04612143022000	04612141933001	04612130944003	04612141924004	04612131144006	04612131341008	04612141934010	04612141943013	04612131612018	04412140734000
00412141911000	00412142022004	00412142023009	00412142023021	04612131013000	04612143023000	04612141934001	04612131013003	04612141931004	04612131341006	04612131612008	04612141942010	04612130333014	04612133641018	04412141812000
00412141911000	00412142023004	00412142024009	00411140622022	04612131014000	04612143024000	04612141942001	04612131022003	04612141934004	04612131611006	04612131624008	04612141943010	04612130944014	04612141924018	04412141813000
00412142023000	00412142024004	00412142024009	00411140644022	04612131032000	04612143032000	04612141943001	04612131032003	04612141943004	04612131611006	04612131624008	04612141943010	04612130944014	04612141924018	04412141813000
00412142042000	00412142041004	00412142043009	00411140712022	04612131033000	04612143033000	04612141943001	04612131033003	04612141943004	04612131624006	04612133643008	04612143123010	04612131013014	04612130333019	04412141814000
00412142043000	00412142042004	00412142044009	00412142023022	04612131042000	04612143034000	04612141943001	04612131033003	04612141942004	04612131624006	04612133643008	04612143123010	04612131013014	04612130333019	04412141814000
00412142044000	00412142043004	00411140523010	00411140532023	04612131043000	04612143035000	04612141943001	04612131041003	04612141943004	04612133641006	04612133644008	04612130333011	04612131031014	04612131031019	04412141823000
00412142911000	00412142044004	00411140523010	00411140532023	04612131043000	04612143035000	04612141943001	04612131041003	04612141943004	04612133641006	04612133644008	04612130333011	04612131031014	04612131031019	04412141823000
00412142911000	00412142044004	00411140523010	00411140532023	04612131043000	04612143035000	04612141943001	04612131041003	04612141943004	04612133641006	04612133644008	04612130333011	04612131031014	04612131031019	04412141823000
00412142912000	00411140523005	00411140711010	00411140712023	04612131131000	04612143122000	04612143132001	04612131042003	04612143122004	04612141921006	04612141921008	04612130944011	04612131041014	04612131042019	04412141824000
00412142912000	00411140523005	00411140711010	00411140712023	04612131131000	04612143122000	04612143132001	04612131042003	04612143122004	04612141921006	04612141921008	04612130944011	04612131041014	04612131042019	04412141824000
00412142913000	00411140533005	00412142023010	00412142022023	04612131323000	04612143133000	04612143133001	04612131143003	04612143133004	04612141931006	04612141934008	04612131014011	04612131143014	04612131612019	04412141831000
00412142914000	00411140621005	00412142024010	00412142023023	04612131324000	04612143141000	04612130314002	04612131143003	04612131143004	04612141942006	04612141942008	04612131031011	04612131612014	04612141924019	04412141841000
00411140623001	00411140644005	00412142043010	00411140532024	04612131332000	04612143143000	04612130332002	04612131143003	04612130332005	04612143123006	04612143123008	04612131041011	04612133644014	04612130333020	04412141842000
00411140533001	00411140712005	00411140532011	00411140622024	04612131341000	04612130311001	04612130332002	04612131611003	04612130332005	04612143123006	04612143123008	04612131041011	04612141833014	04612131014020	04412141843000
00411140621001	00411140713005	00411140711011	00412142022024	04612131341000	04612130314001	04612130332002	04612131611003	04612130332005	04612143123006	04612143123008	04612131041011	04612141833014	04612131014020	04412141843000
00412141911001	00411140822005	00412142023011	00412142023024	04612131342000	04612130331001	04612130331002	04612131612003	04612130331005	0461213033007	04612130331009	04612131143011	04612141924014	04612131031020	04412141844000
00412141911001	00411140822005	00412142023011	00412142023024	04612131342000	04612130331001	04612130331002	04612131612003	04612130331005	0461213033007	04612130331009	04612131143011	04612141924014	04612131031020	04412141844000
00412142013001	00412142023005	00412142024011	00411140532025	04612131411000	04612130333001	04612130931002	04612133641003	04612131013005	04612130933007	04612130933009	04612131612011	04612130333015	04612131612020	04412141812001
00412142013001	00412142024005	00412142043011	00412142022025	04612131414000	04612130342001	04612130934002	04612141833003	04612131022005	04612130934007	04612130934009	04612131014009	04612133644011	04612131013015	04412141823001
00412142042001	00412142042005	00411140532012	00412142022026	04612131621000	04612130911001	04612130944002	04612141921003	04612131041005	04612130944007	04612131031009	04612141921011	04612131014015	04612131031021	04412141824001
00412142043001	00412142043005	00411140711012	00412142022027	04612131622000	04612130913001	04612131013002	04612141934003	04612131042005	04612131041009	04612131041009	04612141924011	04612131031015	04612131042021	04412141841001
00412142133001	00412142044005	00412142022012	00412142022028	04612131624000	04612130931001	04612131022002	04612141934003	04612131131005	04612131041009	04612131041009	04612141924011	04612131031015	04612131042021	04412141841001
00411140523002	00411140523006	00412142024012	00412142022029	04612131631000	04612130932001	04612131033002	04612141942003	04612131132005	04612131041009	04612131132009	04612141934011	04612131041015	04612141833021	04412141822002
00411140533002	00411140523006	00411140532013	00412142022030	04612131632000	04612130934001	04612131041002	04612141943003	04612131132005	04612131041009	04612131132009	04612141934011	04612131041015	04612141833021	04412141841002
00411140622002	00411140621006	00412142022013	00412142022031	04612131633000	04612131013001	04612131042002	04612141943003	04612131132005	04612131041009	04612131132009	04612141934011	04612131041015	04612141833021	04412141841002
00411140644002	00411140713006	00412142023013	00412142022032	04612131643000	04612131022001	04612131044002	04612143123003	04612131143005	04612131042007	04612131341009	04612143123011	04612131612015	04612131042022	04412141840018
00411140713002	00411140822006	00412142024013	Town of Celanovus	04612132112000	04612131033001	04612131131002	04612143123003	04612131161005	0461213132007	04612131612009	04612130333012	04612141924015	04612141833022	04412141844020
00411140714002	00412142023006	00411140532014	00811130111000	04612132113000	04612131041001	04612131132002	04612143133003	04612131612005	0461213143007	04612131624009	04612130944012	04612141943015	04612130333023	04412141844021
00412141911002	00412142042006	00411140711014	00811130112000	04612132114000	04612131044001	04612131144002	04612130331004	04612131613005	0461213144007	04612133643009	04612131013012	04612130333016	04612131042023	04412141844022
00412142013002	00412142041006	00412142022014	00811130111001	04612132121000	04612131123001	04612131611002	04612130332004	04612133643005	04612131611007	04612141921009	04612130944012	04612131042016	04612131042023	04412141844023
00412142021002	00412142042006	00412142023014	00811130111003	04612132122000	04612131131001	04612131612002	04612130333004	04612133643005	04612131611007	04612141921009	04612130944012	04612131042016	04612131042023	04412141844024
00412142023002	00412142043006	00412142024014	00811130112003	04612132124000	04612131132001	04612131623002	04612130913004	04612141833005	04612131612007	04612141934009	04612131042012	04612131041016	04612131042024	04412141844025
00412142041002	00412142044006	00412142022015	00811130111004	04612132141000	04612131143001	04612131624002	04612130931004	04612141921005	04612131624007	04612141931009	04612131131012	04612131031016	04612131014025	04412141844026
00412142042002	00411140523007	00412142024015	00811130112004	04612132144000	04612131144001	04612133641002	04612130932004	04612141924005	04612133641007	04612141934009	04612131143012	04612131041016	04612131042025	04412141844027
00412142043002	00411140532007	00411140532015	00811130111005	04612132232000	046121311331001	0								

TOWN OF FOX LAKE			CITY OF BEAVER DAM					
01812130212001	01812130242014	01812131243000	20611140423000	20611140513005	20611140533009	20611140542014	20612142833066	20612143242002
01812130213001	01812130243000	01812131243001	20611140423008	20611140513006	20611140533010	20611140542015	20612142833067	20612143242003
01812130221000	01812130243001	01812131243002	20611140423009	20611140513007	20611140534006	20611140542016	20612142833068	20612143242004
01812130221002	01812130243002	01812131243003	20611140423029	20611140513008	20611140534016	20611140542018	20612142833069	20612143242005
01812130221003	01812130243003	01812131243004	20611140423030	20611140513009	20611140534067	20611140542019	20612142943000	20612143242006
01812130221005	01812130243004	01812131243005	20611140423031	20611140514008	20611140534068	20611140542020	20612142944000	20612143242007
01812130221006	01812130243005	01812131243006	20611140423032	20611140514012	20611140534069	20611140542021	20612142944001	20612143242008
01812130221007	01812130243006	01812131243007	20611140423033	20611140514013	20611140534070	20611140542022	20612142944002	20612143242009
01812130222000	01812130243007	01812131243008	20611140423034	20611140514014	20611140534071	20611140542023	20612142944003	20612143242010
01812130223000	01812130243008	01812131243009	20611140423108	20611140514015	20611140534072	20611140542024	20612142944004	20612143242011
01812130223001	01812130243009	01812131243010	20611140423109	20611140514016	20611140534073	20612142823000	20612142944005	20612143242012
01812130224000	01812130243010	01812131243011	20611140511147	20611140514017	20611140534074	20612142824004	20612143211000	20612143244000
01812130224001	01812130244000	01812131243012	20611140511148	20611140514019	20611140534075	20612142824005	20612143211001	20612143244001
01812130224002	01812130244001	01812131243013	20611140512000	20611140514020	20611140534076	20612142824007	20612143211002	20612143244002
01812130224003	01812130244002	01812131244000	20611140512001	20611140514021	20611140534077	20612142824008	20612143211003	20612143244003
01812130224005	01812130244003	01812131244001	20611140512002	20611140514022	20611140534078	20612142831006	20612143211004	20612143244004
01812130224006	01812130244004	01812131244002	20611140512003	20611140514023	20611140534079	20612142831007	20612143211005	20612143244005
01812130224007	01812130244005	01812131244003	20611140512004	20611140514024	20611140534080	20612142831008	20612143211006	20612143244006
01812130224008	01812130244011	01812131244004	20611140512005	20611140514025	20611140534081	20612142831009	20612143211007	20612143244007
01812130224010	01812130244012	01812131244005	20611140512006	20611140514026	20611140541000	20612142831010	20612143213000	20612143244008
01812130232000	01812130244014	01812131244006	20611140512007	20611140514027	20611140541001	20612142831011	20612143213001	20612143244009
01812130232001	01812130244015	01812131244007	20611140512008	20611140514028	20611140541002	20612142831012	20612143213002	20612143244010
01812130232002	01812130244016	01812131244008	20611140512009	20611140514029	20611140541003	20612142831013	20612143213003	20612143244011
01812130233000	01812131111000	01812131244009	20611140512010	20611140514030	20611140541004	20612142831014	20612143213004	20612143244012
01812130234000	01812131221001	01812131311000	20611140512011	20611140514031	20611140541005	20612142831015	20612143213005	20612143244013
01812130241000	01812131221002	01812131311001	20611140512012	20611140514032	20611140541006	20612142831016	20612143213006	20612143244014
01812130242001	01812131222001	01812131311002	20611140512013	20611140514033	20611140541007	20612142832002	20612143213007	20612143244015
01812130242002	01812131222002	01812131311003	20611140512014	20611140514034	20611140541008	20612142832003	20612143213008	20612143244016
01812130242003	01812131222003	01812131311004	20611140512015	20611140514035	20611140541009	20612142832004	20612143213009	20612143244017
01812130242004	01812131222004	01812131341017	20611140512016	20611140514036	20611140541010	20612142832005	20612143214103	20612143244018
01812130242005	01812131222005	01813133533001	20611140512017	20611140514037	20611140541012	20612142832006	20612143214104	20612143244019
01812130242006	01812131222006	01813133533003	20611140512018	20611140514038	20611140541126	20612142833058	20612143214105	20612143244020
01812130242008	01812131224000	01813133534000	20611140512019	20611140514039	20611140542000	20612142833059	20612143214106	20612143244021
01812130242009	01812131224001		20611140513000	20611140514047	20611140542002	20612142833060	20612143214107	20612143244022
01812130242010	01812131231000		20611140513001	20611140514048	20611140542008	20612142833061	20612143214108	20612143244023
01812130242011	01812131241004		20611140513002	20611140521000	20611140542009	20612142833062	20612143214109	20612143244024
01812130242012	01812131242000		20611140513003	20611140524000	20611140542010	20612142833063	20612143214110	20612143244025
01812130242013	01812131242001		20611140513004	20611140531001	20611140542011	20612142833064	20612143214111	20612143244026
	01812131242002			20611140533008	20611140542013	20612142833065	20612143214112	20612143244027

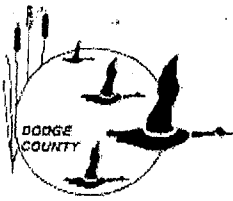

The Dodge County Board of Supervisors

127 East Oak Street, Juneau, Wisconsin 53039

Dodge County Land Resources and Parks Committee Notice of Public Hearing

NOTICE IS HEREBY GIVEN, in accordance with Section 33.26, Wis. Stats., that a public hearing will be conducted by the Dodge County Land Resources and Parks Committee on the Petition for the formation of the Beaver Dam Lake District on Thursday, October 3, 2019, at 5:30 p.m., in the First Floor Auditorium, Rooms F, G, H, and I of the Dodge County Administration Building, 127 E. Oak Street, Juneau, Wisconsin.

At the public hearing, all interested persons may offer objections, criticisms, or suggestions to the necessity of the proposed district as described by the parcel identification numbers attached to this notice, and to the question of whether their property will be benefited by the establishment of such district. Any person wishing to object to the organization of such district may, before the date set for the hearing, file written objections to the formation of such district with the Dodge County Clerk, 1st Floor, Dodge County Administration Building, 127 E. Oak Street, Juneau, WI 53039.

On September 10, 2019, a petition was filed with the Dodge County Clerk requesting the establishment of an inland lake protection and rehabilitation district pursuant to Section 33.21, Wis. Stats. Lands affected by said Petition are parcels contiguous to Beaver Dam lake, being located in the Townships of Fox Lake, Trenton, Calamus, Beaver Dam, and Westford, and the Cities of Beaver Dam and Fox Lake, as generally shown on the sketch of the proposed Beaver Dam Lake District, attached hereto as Exhibit A. The boundaries of the proposed inland lake protection and rehabilitation district are generally described by the following Parcel Identification Numbers reflected on Exhibit B, attached hereto, and incorporated herein.

Dated at Juneau, Wisconsin, September 19, 2019.

Dodge County Land Resources and Parks Committee
Thomas Schaefer, Chairman

**Beaver Dam Lake District
Proposed Boundaries
Exhibit A**

The data used to create this map is a compilation of records, information, and data from various city, county and state offices, and other sources. This map is only advisory, does not replace a survey, and may not be used for any legal purpose. Dodge County assumes no liability for any use or misuse of this information.

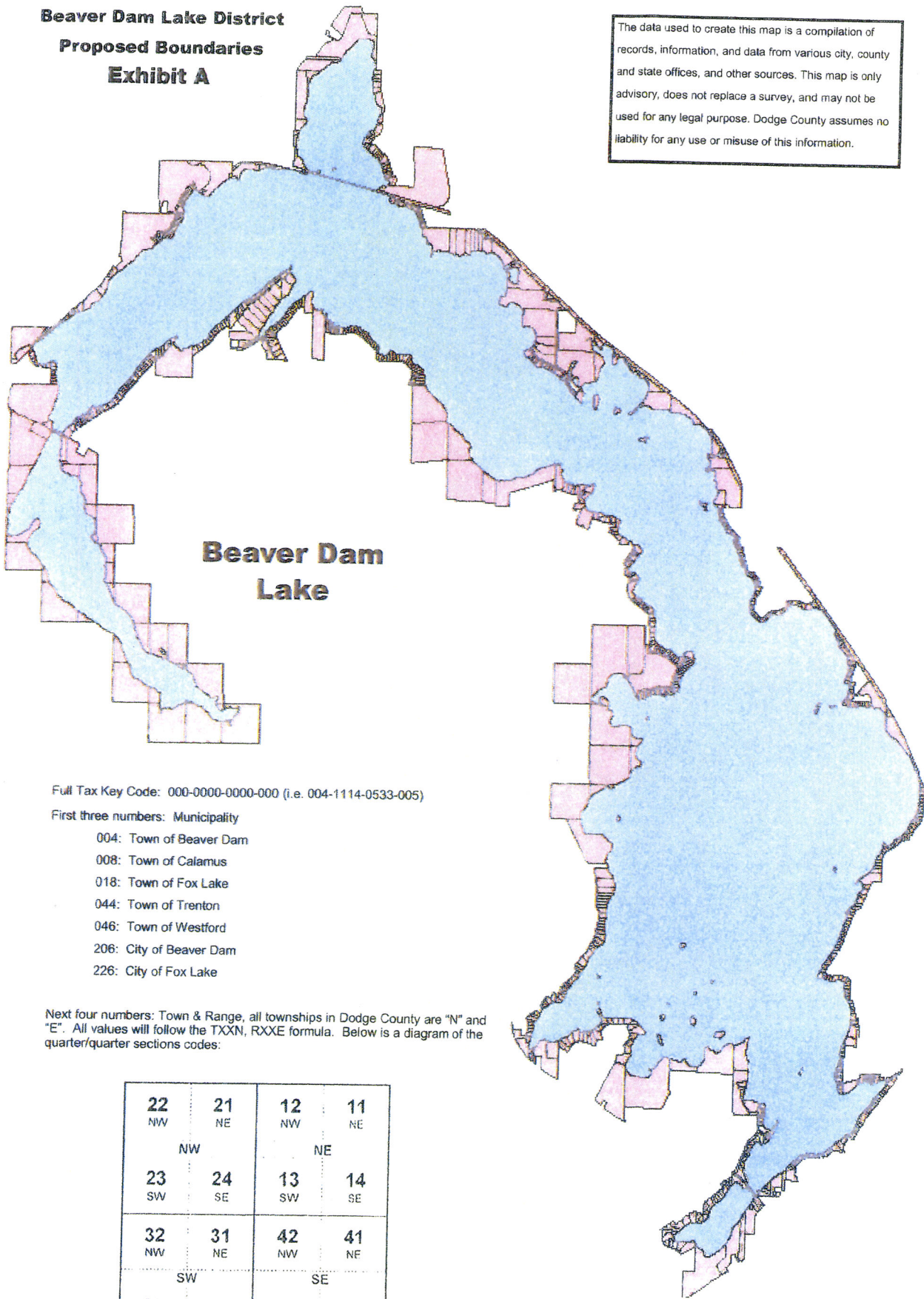

Full Tax Key Code: 000-0000-0000-000 (i.e. 004-1114-0533-005)

First three numbers: Municipality

- 004: Town of Beaver Dam
- 008: Town of Calamus
- 018: Town of Fox Lake
- 044: Town of Trenton
- 046: Town of Westford
- 206: City of Beaver Dam
- 226: City of Fox Lake

Next four numbers: Town & Range, all townships in Dodge County are "N" and "E". All values will follow the TXXN, RXXE formula. Below is a diagram of the quarter/quarter sections codes:

22 NW	21 NE	12 NW	11 NE
NW		NE	
23 SW	24 SE	13 SW	14 SE
SW		SE	
32 NW	31 NE	42 NW	41 NE
SW		SE	
33 SW	34 SE	43 SW	44 SE

Last three numbers: the lot number within that quarter/quarter

TOWN OF BEAVER DAM				TOWN OF WESTFORD											
00411140522000	00411140533004	00412142023008	00412142023019	04612130333000	04612141931000	04612132322001	04612130331003	04612131611004	04612131013006	04612131013008	04612131143010	04612131042013	04612141924017	04612131031004	
00411140523000	00411140621004	00412142024008	00412142024019	04612130341000	04612141932000	04612133641001	04612130332003	04612131612004	04612131022006	04612131014008	04612131341010	04612131310103	04612130333018	04612131031005	
00411140531000	00411140623004	00412142024008	00411140622020	04612130341000	04612141932000	04612133641001	04612130311003	04612131624004	04612131041006	04612131022008	04612131612010	04612131143013	04612130944018	04612131031006	
00411140611000	00411140644004	00412142043008	00412142023020	04612130911000	04612141933000	04612141833001	04612130913003	04612133641004	04612131042006	04612131041008	04612133643010	04612131612013	04612131014018	04612131031007	
00411140612000	00411140712004	00412142044008	00412142024020	04612130911000	04612141934000	04612141921001	04612130911003	04612141833004	04612131042006	04612131041008	04612133643010	04612131612013	04612131014018	04612131031007	
00411140622000	00411140713004	00411140523009	00411140532021	04612130931000	04612141942000	04612141931001	04612130933003	04612141921004	04612131132006	04612131132008	04612131612010	04612141921013	04612131042018	04612131031008	
00411140624000	00411140822004	00411140532009	00411140644021	04612130934000	04612143021000	04612141933001	04612130934003	04612141922004	04612131343006	04612131343008	04612141922010	04612141921013	04612131042018	04612131031009	
00411140823000	00412141911004	00411140711009	00411140713021	04612131011000	04612143022000	04612141933001	04612130934003	04612141922004	04612131343006	04612131343008	04612141922010	04612141921013	04612131042018	04612131031010	
00412141911000	00412142022004	00412142023009	00412142023021	04612131013000	04612143023000	04612141934001	04612131013003	04612141924004	0461213144006	0461213144008	04612141934010	04612141934013	04612131612018	04412140734000	
00412141911000	00412142023004	00412142024009	00411140622022	04612131013000	04612143024000	04612141942001	04612131022003	04612141934004	04612131611006	04612131624008	04612141942010	04612130333014	04612133641018	04412141812000	
00412142023000	00412142024004	00412142042009	00411140644022	04612131032000	04612143032000	04612141943001	04612131033003	04612141942004	04612131624006	04612131624008	04612141943010	04612130944014	04612133641018	04412141813000	
00412142042000	00412142041004	00412142043009	00411140712022	04612131033000	04612143033000	04612141943001	04612131041003	04612141942004	04612133641006	04612133641008	04612143123010	04612131031014	04612130333019	04412141814000	
00412142043000	00412142042004	00412142044009	00412142023022	04612131042000	04612143113000	04612143123001	04612131042003	04612143122004	04612133641006	04612133641008	04612131031014	04612131031019	04612131031019	04412141821000	
00412142043000	00412142043004	00411140523010	00411140523010	04612131131000	04612143122000	04612143132001	04612131044003	04612143123004	04612141921006	04612141924008	04612131041014	04612131031019	04612131031019	04412141823000	
00412142911000	00412142044004	00411140532010	00411140622023	04612131143000	04612143132000	04612143132001	04612131044003	04612143123004	04612141924008	04612130944011	04612131041014	04612131042019	04612141824000	04412141824000	
00412142912000	00411140523005	00411140711010	00411140712023	04612131144000	04612143132000	04612143134001	04612131131003	04612143132004	04612141991008	04612141991008	04612131031011	04612131310104	04612131131019	04412141831000	
00412142913000	00411140533005	00412142023010	00412142022023	04612131323000	04612143133000	04612143143001	04612131143003	04612141933006	04612141934008	04612131014011	04612131143014	04612131612019	04612141834000	04412141834000	
00412142914000	00411140621005	00412142024010	00412142023023	04612131324000	04612143141000	04612130314002	04612131144003	04612141943006	04612141943008	04612131041011	04612131612014	04612141924019	04612141841000	04412141841000	
00411140523001	00411140644005	00412142043010	00411140532024	04612131324000	04612143141000	04612130314002	04612131144003	04612141943006	04612141943008	04612131041011	04612133644014	04612130333020	04612141842000	04412141842000	
00411140533001	00411140712005	00411140532011	00411140622024	04612131341000	04612130311001	04612130332002	04612131341003	04612143122006	04612130333007	04612143123008	04612131310111	04612141833014	04612131014020	04412141843000	
00411140621001	00411140713005	00411140711011	00412142022024	04612131341000	04612130311001	04612130332002	04612131341003	04612143122006	04612130333007	04612143123008	04612131310111	04612141833014	04612131014020	04412141843000	
00412141911001	00411140822005	00412142023011	00412142023024	04612131342000	04612130314001	04612130911002	04612131612003	04612130934005	04612130333007	04612130931009	04612131143011	04612141943014	04612131042020	04412140734001	
00412142013001	00412142023005	00412142024011	00411140532025	04612131342000	04612130331001	04612130911002	04612131624003	04612130944005	04612130931007	04612130933009	04612131612021	04612130933015	04612131612020	04412141812001	
00412142041001	00412142024005	00412142043011	00412142022025	04612131342000	04612130331001	04612130911002	04612131624003	04612130944005	04612130931007	04612130933009	04612131612021	04612130933015	04612131612020	04412141812001	
00412142042001	00412142042005	00411140532012	00412142022026	046121313621000	04612130911001	04612130944002	04612141921003	04612131041005	04612130933007	04612131031009	04612141921011	04612131031015	04612131031021	04412141823001	
00412142043001	00412142043005	00411140711012	00412142022027	046121313621000	04612130911001	04612130944002	04612141921003	04612131041005	04612130933007	04612131031009	04612141921011	04612131031015	04612131031021	04412141824001	
00412142133001	00412142044005	00412142022012	00412142022028	046121313624000	04612130931001	04612131022002	04612141934003	04612131131005	04612131042005	04612131031007	04612141924011	04612131031015	04612131042011	04412141841001	
00411140523002	00411140523006	00412142024012	00412142022029	046121313631000	04612130932001	04612131033002	04612141942003	04612131131005	04612131014007	04612131131009	04612141942011	04612131031015	04612131042011	04412141841001	
00411140533002	00411140532006	00411140532013	00412142022030	046121313632000	04612130934001	04612131041002	04612141943003	04612131143005	04612131014007	04612131131009	04612141942011	04612131031015	04612131042011	04412141841001	
00411140622002	00411140621006	00412142022013	00412142022031	046121313633000	04612131013001	04612131042002	04612141943003	04612131143005	04612131014007	04612131143009	04612141943011	04612131041015	04612131033022	04412141841001	
00411140644002	00411140713006	00412142023013	00412142022032	046121313643000	04612131013001	04612131042002	04612141943003	04612131143005	04612131014007	04612131143009	04612141943011	04612131041015	04612131033022	04412141841001	
00411140713002	00411140822006	00412142024013	Town of Calamus	046121313643000	04612131013001	04612131042002	04612141943003	04612131143005	04612131014007	04612131143009	04612141943011	04612131041015	04612131033022	04412141841001	
00411140714002	00412142023006	00411140532014	00811130111000	046121313643000	04612131013001	04612131042002	04612141943003	04612131143005	04612131014007	04612131143009	04612141943011	04612131041015	04612131033022	04412141841001	
00412141911002	00412142024006	00411140711014	00811130112000	046121313643000	04612131013001	04612131042002	04612141943003	04612131143005	04612131014007	04612131143009	04612141943011	04612131041015	04612131033022	04412141841001	
00412142013002	00412142041006	00412142022014	00811130111001	046121313643000	04612131013001	04612131042002	04612141943003	04612131143005	04612131014007	04612131143009	04612141943011	04612131041015	04612131033022	04412141841001	
00412142021002	00412142042006	00412142023014	00811130111003	046121313643000	04612131013001	04612131042002	04612141943003	04612131143005	04612131014007	04612131143009	04612141943011	04612131041015	04612131033022	04412141841001	
00412142023002	00412142043006	00412142024014	00811130112003	046121313643000	04612131013001	04612131042002	04612141943003	04612131143005	04612131014007	04612131143009	04612141943011	04612131041015	04612131033022	04412141841001	
00412142041002	00412142044006	00412142022015	00811130111004	046121313643000	04612131013001	04612131042002	04612141943003	04612131143005	04612131014007	04612131143009	04612141943011	04612131041015	04612131033022	04412141841001	
00412142042002	00411140523007	00412142024015	00811130112004	046121313643000	04612131013001	04612131042002	04612141943003	04612131143005	04612131014007	04612131143009	04612141943011	04612131041015	04612131033022	04412141841001	
00412142043002	00411140523007	00411140532015	00811130111005	046121313643000	04612131013001	04612131042002	04612141943003	04612131143005	04612131014007	04612131143009	04612141943011	04612131041015	04612131033022	04412141841001	
00412142044															

TOWN OF FOX LAKE			CITY OF BEAVER DAM					
01812130212001	01812130242014	01812131243000	20611140423000	20611140513005	20611140533009	20611140542014	20612142833066	20612143242002
01812130213001	01812130243000	01812131243001	20611140423008	20611140513006	20611140533010	20611140542015	20612142833067	20612143242003
01812130221000	01812130243001	01812131243002	20611140423009	20611140513007	20611140534006	20611140542016	20612142833068	20612143242004
01812130221002	01812130243002	01812131243003	20611140423029	20611140513008	20611140534016	20611140542018	20612142833069	20612143242005
01812130221003	01812130243003	01812131243004	20611140423030	20611140513009	20611140534067	20611140542019	20612142943000	20612143242006
01812130221005	01812130243004	01812131243005	20611140423031	20611140514008	20611140534068	20611140542020	20612142944000	20612143242007
01812130221006	01812130243005	01812131243006	20611140423032	20611140514012	20611140534069	20611140542021	20612142944001	20612143242008
01812130221007	01812130243006	01812131243007	20611140423033	20611140514013	20611140534070	20611140542022	20612142944002	20612143242009
01812130222000	01812130243007	01812131243008	20611140423034	20611140514014	20611140534071	20611140542023	20612142944003	20612143242010
01812130223000	01812130243008	01812131243009	20611140423108	20611140514015	20611140534072	20611140542024	20612142944004	20612143242011
01812130223001	01812130243009	01812131243010	20611140423109	20611140514016	20611140534073	20612142823000	20612142944005	20612143242012
01812130224000	01812130243010	01812131243011	20611140511147	20611140514017	20611140534074	20612142824004	20612143211000	20612143244000
01812130224001	01812130244000	01812131243012	20611140511148	20611140514019	20611140534075	20612142824005	20612143211001	20612143244001
01812130224002	01812130244001	01812131243013	20611140512000	20611140514020	20611140534076	20612142824007	20612143211002	20612143244002
01812130224003	01812130244002	01812131244000	20611140512001	20611140514021	20611140534077	20612142824008	20612143211003	20612143244033
01812130224005	01812130244003	01812131244001	20611140512002	20611140514022	20611140534078	20612142831006	20612143211004	20612143244034
01812130224006	01812130244004	01812131244002	20611140512003	20611140514023	20611140534079	20612142831007	20612143211005	20612143244035
01812130224007	01812130244005	01812131244003	20611140512004	20611140514024	20611140534080	20612142831008	20612143211006	20612143244036
01812130224008	01812130244011	01812131244004	20611140512005	20611140514025	20611140534081	20612142831009	20612143211007	20612143244037
01812130224010	01812130244012	01812131244005	20611140512006	20611140514026	20611140541000	20612142831010	20612143213000	20612143244074
01812130232000	01812130244014	01812131244006	20611140512007	20611140514027	20611140541001	20612142831011	20612143213001	20612143244094
01812130232001	01812130244015	01812131244007	20611140512008	20611140514028	20611140541002	20612142831012	20612143213002	20612143244095
01812130232002	01812130244016	01812131244008	20611140512009	20611140514029	20611140541003	20612142831013	20612143213003	20612143244105
01812130233000	01812131111000	01812131244009	20611140512010	20611140514030	20611140541004	20612142831014	20612143213004	
01812130234000	01812131221001	01812131311000	20611140512011	20611140514031	20611140541005	20612142831015	20612143213005	
01812130241000	01812131221002	01812131311001	20611140512012	20611140514032	20611140541006	20612142831016	20612143213006	
01812130242001	01812131222001	01812131311002	20611140512013	20611140514033	20611140541007	20612142832002	20612143213007	
01812130242002	01812131222002	01812131311003	20611140512014	20611140514034	20611140541008	20612142832003	20612143213008	
01812130242003	01812131222003	01812131311004	20611140512015	20611140514035	20611140541009	20612142832004	20612143213009	
01812130242004	01812131222004	01812131341017	20611140512016	20611140514036	20611140541010	20612142832005	20612143214103	
01812130242005	01812131222005	01813133533001	20611140512017	20611140514037	20611140541012	20612142832006	20612143214104	
01812130242006	01812131222006	01813133533003	20611140512018	20611140514038	20611140541126	20612142833058	20612143214105	
01812130242008	01812131224000	01813133534000	20611140512019	20611140514039	20611140542000	20612142833059	20612143214106	
01812130242009	01812131224001		20611140513000	20611140514047	20611140542002	20612142833060	206121432141040	
01812130242010	01812131231000		20611140513001	20611140514048	20611140542008	20612142833061	206121432141041	
01812130242011	01812131241004		20611140513002	20611140521000	20611140542009	20612142833062	206121432141042	
01812130242012	01812131242000		20611140513003	20611140524000	20611140542010	20612142833063	206121432141043	
01812130242013	01812131242001		20611140513004	20611140531001	20611140542011	20612142833064	206121432141044	
	01812131242002			20611140533008	20611140542013	20612142833065	206121432141045	

Capital Newspapers Proof of Publication Affidavit

Ad #: 3767746 Price: \$700.39 Ad ID: hrg with map and parcels

*Retain this portion for your records.
Please do not remit payment until you receive your advertising invoice.*

Mail to:

OFFICE OF DODGE COUNTY
Karen Gibson
127 EAST OAK STREET
JUNEAU, WI 53039

RECEIVED
IN THE OFFICE OF

SEP 25 2019

DODGE COUNTY CLERK

STATE OF WISCONSIN }
Dodge County } ss.

Rebecca McBride

being duly sworn, doth depose and say that
he (she) is an authorized representative of
Capital Newspapers, publishers of

PDAC

Daily Citizen

a newspaper, in the city of Beaver Dam, in said County and State,
and that an advertisement of which the annexed is a true
copy, taken from said paper, was published therein on
September 23rd, 2019

(Seal)

(Signed) Rebecca McBride
(Title) Principal Clerk

Subscribed and sworn to before me on **SEP 23 2019**

KATHERINE J PORTZEN
Notary Public
State of Wisconsin

Katherine J Portzen
Notary Public, Wisconsin

My Commission expires

DEC 13 2019

Attachment No. 4
Proof of Publication

1
2
3
4
5
6
7
8
9
10
11
12
13
14
15
16
17
18
19
20
21
22
23
24
25

THE DODGE COUNTY BOARD OF SUPERVISORS
SPECIAL LAND RESOURCES AND
PARKS COMMITTEE MEETING

PUBLIC HEARING ON BEAVER DAM
LAKE DISTRICT PETITION
OCTOBER 3, 2019

APPEARANCES:

CORPORATION COUNSEL:

Ms. Kimberly Nass

COMMITTEE MEMBERS:

- MR. WILLIAM MUCHE
- MR. THOMAS SCHAEFER, Chairman
- MR. JOSEPH MARSIK
- MR. JEFFREY SCHMITT

OCT 03 2019

8:00pm KS
DODGE COUNTY, WIS.

Beaver Dam Chamber of Commerce Board Resolution

Whereas, in order to ensure a healthy aqua ecosystem within Beaver Dam Lake and its watershed; and

Whereas, Beaver Dam Lake is an important recreational resource, diverse animal and fish habitat and aesthetic asset for homeowners, local citizens and visitors; and

Whereas, Beaver Dam Lake is a fundamental part of the community, its history and its future; and

Whereas, the responsibility and coordination of managing a lake requires adequate funding and oversight;

Now, therefore, be it resolved, we, the Beaver Dam Chamber of Commerce's Board of Directors, support the initiative to create a Beaver Dam Lake Improvement District for the responsible management of Beaver Dam Lake.

Proclaimed this date, February 28, 2018.

Chamber Board Chairman *(Chief Volunteer Leader)*

Chamber President *(Chief Paid Staff)*

Mission: We promote engagement and collaboration for our community and membership.



**Resolution Authorizing the Purchase and Financing of the
2020 Computer and Infrastructure Refresh Project**

TO THE HONORABLE BOARD OF SUPERVISORS OF DODGE COUNTY, WISCONSIN,

WHEREAS, the Dodge County Information Technology Committee (“Committee”) has considered the current County Department computers and information technology server/network infrastructure and the maintenance and upgrades needed to prevent data loss, enhance user productivity and provide data and system securities; and,

WHEREAS, as proposed by the Information Technology Department (“IT Department”), the Committee has considered the following department and infrastructure upgrades: life-cycle refresh of department computers within the Dodge County Administration Building, Sheriff’s Office, and also infrastructure refresh of servers and core networking hardware (“2020 Computer and Infrastructure Refresh Project”); and,

WHEREAS, the IT Department recommends a 4-year replacement cycle for County Department computers, and in the Fall of 2019, the IT Department inventoried County Department computers and determined that one hundred three (103) computers and related equipment require replacement, listed on a document entitled *List of Department Computer Equipment*, attached hereto as Exhibit “A”, at a total cost, excluding interest, not to exceed \$152,339.24 with the cost spread over four (4) years of \$39,739.28 per year; and,

WHEREAS, in the Fall of 2019, the IT Department evaluated Dodge County’s server and core-networking infrastructure and determined that various system hardware require replacement, listed on a document entitled *List of Servers and Network Hardware*, attached hereto as Exhibit “B”, at a total cost, excluding interest, not to exceed \$491,808.60 with the cost spread over four (4) years of approximately \$128,293.40 per year; and,

WHEREAS, the 2020 Computer and Network Infrastructure Refresh Project includes all hardware listed on the attached exhibits, warranty on all equipment, installation, and financing costs; and,

WHEREAS, the 2020 IT Department Budget has \$185,000 to fund the 2020 Computer and Infrastructure Refresh Project; and,

WHEREAS, the IT Department has explored funding sources and financing options for the 2020 Computer and Infrastructure Refresh Project, requested pricing from four different technology leasing and financing lenders as follows:

2020 FINANCING PROPOSALS	Finance Type	Interest Rate	Payment Terms	Annual Rate Factor 4-Years	Percentage of Total Interest Costs	First Payment Year
Lender #1 – American Capital	Purchase Finance to Own	2.873%	4 years	0.26086	4.3%	2020
Lender #2 – HP Financing	Purchase Finance to Own	3.06%	4 years	0.26290	4.5%	2020
Lender #3 – DELL Financing	Purchase Finance to Own	Not available	4 years	0.26805	7.2%	2020
Lender #4 – Vantage	Purchase Finance to Own	Not available	4 years	0.27780	11%	2020

; and,

1 **WHEREAS**, the IT Department presented its lease-to-own proposal to refresh department
2 computers and network hardware and the various financing options to the Committee at its meeting on
3 January 7, 2020, and also on February 4, 2020; and,
4

5 **WHEREAS**, the Committee recommends authorization of the 2020 Computer and Infrastructure
6 Refresh Project in a total principal amount not to exceed \$644,147.84, and a 4-year lease-to-own agreement
7 with American Capital to spread the costs over four (4) years of approximately \$168,032.68 per year; and,
8

9 **WHEREAS**, the Dodge County Finance Committee, at its meeting on February 17, 2020,
10 considered the financing proposal for the 2020 Computer and Infrastructure Refresh Project at a total
11 principal amount not to exceed \$644,147.84 and recommends entering into a 4-year financing agreement
12 with American Capital with the requirement that the IT Department budget sufficient amounts in its annual
13 budgets in 2021, 2022 and 2023 to cover the expenditures required by the agreement;
14

15 **SO, NOW, THEREFORE, BE IT RESOLVED**, by the Dodge County Board of Supervisors that
16 it hereby adopts the recommendations of the Information Technology Committee and the Finance
17 Committee, and authorizes the 2020 Computer and Infrastructure Refresh Project; and,
18

19 **BE IT FURTHER RESOLVED**, by the Dodge County Board of Supervisors that the County
20 Administrator and County Clerk are authorized to execute a financing agreement presented by American
21 Capital containing the following terms:
22

23 Purchase Finance Term:	lease-to-own with dollar-buy-out
24 Total Principal Amount:	\$644,147.84
25 Annual Lease-to-Own Payment:	\$168,032.67
26 Number of Payments:	four (4) total payments (2020, 2021, 2022, & 2023)
27 Total Lease Payments Amount:	\$672,130.68
28 Interest Rate:	2.873%
29 Total Interest Portion:	\$27,982.84

30
31 **BE IT FURTHER RESOLVED**, that the IT Department is directed to budget sufficient funds in
32 its department budget in 2021, 2022, and 2023 for the repayment of the financing agreement; and,
33

34 **BE IT FINALLY RESOLVED**, that the County Administrator and County Clerk are authorized to
35 execute the necessary agreements for the 2020 Computer and Infrastructure Refresh Project.
36

All of which is respectfully submitted this 25th day of February, 2020.

Dodge County Information Technology Committee:

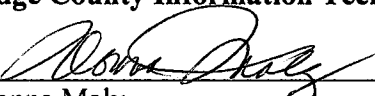

Donna Maly

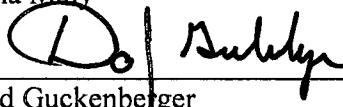

David Guckenberger



Timothy Kemmel

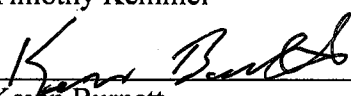

Kevin Burnett

Mary Bobholz

Dodge County Finance Committee:

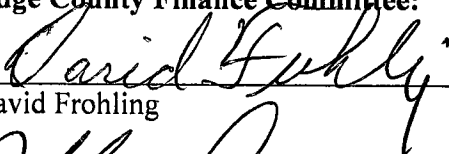

David Frohling



Jeffrey Cain



Thomas Schaefer

Ed Benter

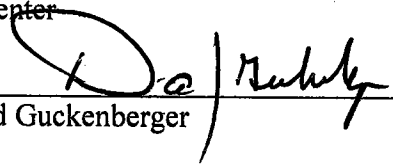

David Guckenberger

FISCAL NOTE: Sufficient funds are budgeted within Bus Unit 1811 (Information Technology) (JD Edwards) for this purpose. A budget amendment is anticipated in the future to reclassify a portion of the expenditures from capital to non-capital to be consistent with Dodge County's capitalization threshold policy. Finance Committee review date: February 17, 2020. Chair initials: 

Vote Required: Two-thirds of the voting members present.

Resolution Summary: Resolution authorizing the purchase and financing of the 2020 Computer and Infrastructure Refresh Project.

List of Department Computer Equipment

LIST OF PURCHASE LEASE-TO-OWN FINANCE ITEMS

2020 COMPUTERS

- (8) Microsoft Surface Book
- (32) Dell OptiPlex 3070 SFF Desktop
- (16) Dell Latitude 3400 14" Laptop
- (18) Dell Latitude 3500 15.6" Laptop
- (9) Dell Latitude 7200 2-in-1 Tablet
- (8) Dell Precision 3630 Tower
- (43) Dell D6000 Docking Station
- (132) Dell Monitor 22"
- (12) Panasonic Toughbook CF-31

TOTAL = \$152,339.24

List of Servers and Network Hardware

LIST OF PURCHASE LEASE-TO-OWN FINANCE ITEMS

2020 INFRASTRUCTURE

- (9) Blade Servers (qty-3 Chassis)
- (8) Core-Networking
- (1) Disaster-Recovery Storage (3.84TB)
- (1) Cyber-Recovery (.8TB)

TOTAL = \$491,808.60

2
3 **Authorizing a General Fund Transfer and the Purchase and**
4 **Installation of Transfer Switches for the Dodge County Detention Facility**
5

6 TO THE HONORABLE BOARD OF SUPERVISORS OF DODGE COUNTY, WISCONSIN,
7

8 **WHEREAS**, the Dodge County Building Committee (“Committee”) has been informed that
9 two transfer switches at the Dodge County Detention Facility are failing and have become
10 unreliable in operation; and,
11

12 **WHEREAS**, the Committee has discussed the need to expedite replacement of the transfer
13 switches; and,
14

15 **WHEREAS**, the Dodge County Physical Facilities Department (“Department”) has
16 requested proposals and quotations based on transfer switch size and availability and the availability
17 of labor for the installation; and,
18

19 **WHEREAS**, a quote, in the amount of \$35,600, for the purchase of two Kohler transfer
20 switch systems (Model Nos. KBS-DMTA-0800S and KBS-DMTA-0400S) has been received from
21 Total Energy Systems, LLC, of DePere, Wisconsin, and a proposal in an amount not to exceed
22 \$48,950 for the removal of existing transfer switches, installation of the new switches, and minor
23 construction has been received from KW Electric, Inc., of Plymouth, Wisconsin; and,
24

25 **WHEREAS**, at its meeting on February 6, 2020, the Committee reviewed the proposals and
26 recommended proceeding with the purchase and installation of the transfer switches; and,
27

28 **WHEREAS**, due to the unexpected deterioration and unreliability of the existing transfer
29 switches, the Department did not budget funds in its 2020 Physical Facilities Budget to cover the
30 cost of this purchase and installation; and,
31

32 **WHEREAS**, the Committee proposes to fund the purchase and installation of the transfer
33 switches as follows:
34

- 35 1. \$50,000 from the Jail Assessment Fund; and,
36
37 2. Balance, not to exceed \$34,550, as a General Fund Transfer; and,
38

39 **WHEREAS**, at its meeting on February 17, 2020, the Dodge County Finance Committee
40 also reviewed the proposals, and has determined that there are sufficient Dodge County funds in the
41 Jail Assessment Fund and the Unassigned General Fund available to fund the purchase and
42 installation of the transfer switches, in an amount not to exceed \$84,550; and,
43

44 **WHEREAS**, the Finance Committee recommends to the Dodge County Board of
45 Supervisors that the Dodge County Board of Supervisors authorize the use of \$50,000 from the Jail
46 Assessment Fund, and the remaining amount from the Unassigned General Fund, in an amount not
to exceed \$34,550;

1
2 **SO, NOW, THEREFORE, BE IT RESOLVED**, that the Dodge County Board of
3 Supervisors hereby approves the proposals for the purchase and installation of the transfer switches
4 at the Dodge County Detention Facility, and authorizes the use of Dodge County funds as
5 recommended by the Finance Committee, in an amount not to exceed \$84,550 to fund the proposals
6 for the purchase and installation of the transfer switches at the Dodge County Detention Facility;
7 and,
8

9 **BE IT FINALLY RESOLVED**, by the Dodge County Board of Supervisors, that the Dodge
10 County Finance Director is directed to (a) allocate \$50,000 of the costs to the Jail Assessment Fund,
11 and, (b) transfer funds from the Unassigned General Fund, in an amount not to exceed \$34,550, to
12 the 2020 Physical Facilities Budget to cover the funding of the proposals for the purchase and
13 installation of the transfer switches at the Dodge County Detention Facility.

All of which is respectfully submitted this 25th day of February, 2020.

Dodge County Building Committee:

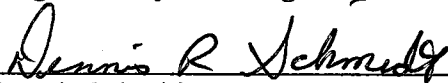
Dennis Schmidt

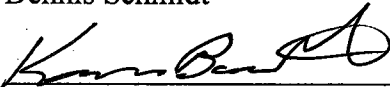

Mark Roesch

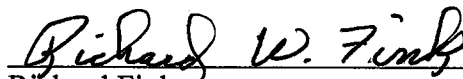

Kevin Burnett

Richard Fink

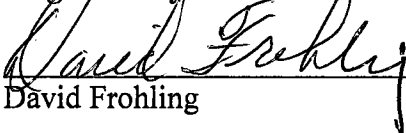
Cathy Houchin

Dodge County Finance Committee:

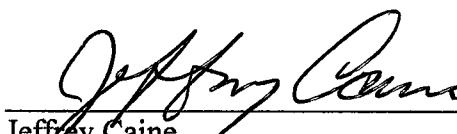

David Frohling

Jeffrey Caine

David Guckenberger



Thomas J. Schaefer

Ed Benter

FISCAL NOTE: *The Jail Assessment Fund has an anticipated fund balance at 12-31-2019 of \$155,502 and thus has available equity to cover the \$50,000 expenditure portion. The Jail Assessment Fund currently does not currently have a related fund balance policy. The Unassigned General Fund balance is sufficient to allow for this transfer. Finance Committee review date: February 17, 2020. Chair initials: *

Vote Required: 2/3 Majority of Members Elect.

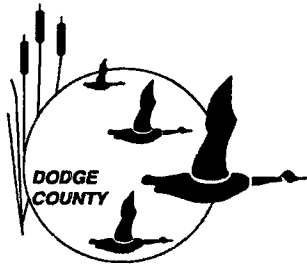
Resolution Summary: A resolution authorizing a general fund transfer and purchase and installation of transfer switches.



ADMINISTRATION DEPARTMENT

JAMES MIELKE, COUNTY ADMINISTRATOR

127 East Oak Street, Juneau, Wisconsin, 53039 (920) 386-4251

To: Dodge County Board Supervisors
From: Jim Mielke 
Date: February 18, 2020

Re: Resolution 19-66 Dodge County Law Enforcement Center Repurposing Project

Background:

September 2018: The 2019 – 2023 Capital Improvement Plan, (Resolution 18-40) listed two projects related to Pod J. The projects included: *Razing Pod J, \$125,000*. Followed by, *Equipment Garage / Storage Facility \$2,000,000*.

August 2019: Dodge County entered into a contract with Angus Young (Janesville) for architectural and engineering services related to the Law Enforcement Center Repurposing Project. Mr. Steven Genin is the Angus Young lead for the project.

August 19, 2019: Angus Young provided a report – *Feasibility Study – Equipment Storage and Training*. The report contain Budget Estimates for the Lower Level Renovation, with a project budget of \$502,500. A second budget estimate was provided to add a new garage door to the 1977 portion of the building, estimate of \$57,700. A third document was provided related to the construction of a new storage building to be located within the Juneau Highway Department yard. The budget estimate was \$843,400.

August 27, 2019: Itemized project budget proposal prepared for the Dodge County Board. Proposed total budget including contingency was set at \$850,000.

Sept 2019: Budget increased to \$940,000.

October 2019: The 2020 – 2024 Capital Improvement Plan (Resolution 19-47) listed the *Law Enforcement Center Equipment Garage / Storage Facility, \$940,000*.

December 2019 - Project Bidding: A Class II Bid Notice was published in December 2019 with a Bid due date of January 30, 2020. The Bid Notice included reference to a Mandatory pre-bid walk through scheduled for January 9, 2020. According to Russ Freber, 62 individuals representing general and sub-contractors were present on January 9th. As a result of the large turnout, a second walk through for general and subcontractors was held on January 16th.

January 30, 2020 Bid Opening: Bids were opened and read aloud by County Clerk Karen Gibson. A total of seven (7) General Contractors submitted bids. The Bid package included the Base Bid and five alternates. A summary of the bid results is attached.

February 6, 2020 Building Committee Meeting:

The Building Committee reviewed the project on February 6th. Mr. Genin of Angus Young was present to review the bidding process and results. He apologized to the Committee on behalf of Angus Young for underestimating the project cost estimate. Mr. Genin distributed his analysis documenting the Angus Young Cost Estimate and the low base bid received from the recommended project contractor. After discussion, the consensus of the Committee is to focus the project on the Base Bid, plus Alternates 1, 2, and 3.

In coordination with Corporation Counsel Kim Nass and Finance Director David Ehlinger, two Resolutions were presented. Each Resolution included the Base Bid, plus Alternates 1, 2, 3 for a total project budget of \$1,581,899 (includes contingency of 10%)

One Resolution funds the project through an Internal Borrowing carrying an interest rate of 1.9% with debt principal payments in years 2021 – 2025.

The second Resolution funds the project through the use of Unassigned Sales Tax Fund Balance.

The Building Committee signed both Resolutions with the understanding that one Resolution will be eliminated through action of the Dodge County Finance Committee.

February 17, 2020 Finance Committee Meeting: Angus Young Project Manager, Steven Genin appeared before the Finance Committee to review the project and the results of the January 30th project bid opening.

Questions were presented by the Committee regarding the original project estimate compared to the actual bid results. Mr. Genin referenced the February 6th Low Bid Analysis document. Following the discussion, the Finance Committee voted 3-1 (Supervisor Guckenberger - No) (Supervisor Benter – Excused) to recommend project funding be through the use of an internal borrowing; and the Committee will not take a position related to the project.

Enclosure:

- Angus Young Feasibility Study – Equipment Storage & Training August 19, 2019
- Angus Young Budget Estimates – August 19, 2020
- Proposal to County Board from the Building Committee – August 27, 2019
- January 30, 2020 Bid Results
- Angus Young - Dodge County Law Enforcement Vehicle Storage Project – Base Bid Estimate vs Low Bid Analysis dated February 6, 2020
- Dodge County Building Committee Minutes (draft) February 6, 2020

Lower Level Renovation

\$ 502,500

The summarizes the improvements included in the attached cost estimate:

- Site – new water laterals from street fire suppression; natural gas and electrical utilities.
- Demolition – removal of all interior improvements including walls; mechanical, electrical and plumbing systems.
- Interiors – build interior walls; cast concrete topping over floor; add garage catch basin and trench drain; epoxy floors in SWAT and Range room; paint new interior walls, acoustical ceilings in SWAT and Range room; insulated interior doors; gun cleaning counter and base.
- Fire suppression – new industrial coverage fire suppression system; fire extinguishers;
- Mechanical – make-up air unit and exhaust for vehicle storage area; heating and air-conditioning SWAT and Range rooms.
- Plumbing - garage catch basin and trench drain.
- Electrical – new service; distribution panels; transfer switch for emergency power from existing generator; convenience outlets and lighting.
- Fees and Development Expenses – general contractor fees including general conditions, overhead and profit and bonding expenses; construction contingency; development expenses for architectural, engineering and State review fees.

First Floor Interior Demolition

\$ 103,000

- Demolition – removal of all interior improvements including walls; mechanical, electrical and plumbing systems.
- Fees and Development Expenses – general contractor fees including general conditions, overhead and profit and bonding expenses; and contingency.

Add New Garage Door

\$ 57,700

The summarizes the improvements included in the attached cost estimate:

- Site – excavation and retaining walls for grade change to new door; new driveway from street to new garage door; exterior lighting.
- Demolition – removal of 12" cast-in-place concrete wall for new door opening.
- Exterior Enclosure – build new wall between man door and overhead door; new 16' x 9' insulated overhead door with opener; new 3' x 7' insulated man door.

- Electrical – power to new door operator and wiring of door controllers.
- Fees and Development Expenses – general contractor fees including general conditions, overhead and profit and bonding expenses; construction contingency; development expenses for architectural, engineering and State review fees.

New Storage Building

\$843,400

The summarizes the improvements included in the attached cost estimate:

- Site – general site excavation; storm water management pond; extending water lateral; natural gas and electrical utilities; driveways; concrete aprons and bollards at exterior doors; landscaping (typically required within the City) and finished grading and seeding.
- Exterior Envelope – 100' x 60' pre-engineered metal building structure; pre-cast insulated concrete base 48" above floor at perimeter; 3" insulated metal wall panel exterior; standing seam metal roof system with R-38 batt roof insulation; (2) insulated man doors; and (2) 16' x 14' insulated overhead doors.
- Interiors – build interior block walls for Swat, Range room, furnace room and toilet room; 6" concrete floor; garage catch basin and trench drain; epoxy floors in SWAT and Range room; paint new interior walls; gypsum wallboard ceilings in SWAT, Range room, furnace and toilet room; insulated interior doors; gun cleaning counter and base.
- Fire suppression – new industrial coverage fire suppression system; fire extinguishers;
- Mechanical – make-up air unit and exhaust for vehicle storage area; heating and air-conditioning SWAT, Range room and toilet room.
- Plumbing - garage catch basin and trench drain; toilet and lavatory in toilet room, hose bibs in garage area.
- Electrical – new service; distribution panels; convenience outlets and lighting.
- Fees and Development Expenses – general contractor fees including general conditions, overhead and profit and bonding expenses; construction contingency; development expenses for architectural, engineering and State review fees.

First Floor Renovation

\$ 1,248,500

The summarizes the improvements included in the attached cost estimate:

- Demolition – removal of all interior improvements including walls; mechanical, electrical and plumbing systems. Costs have been included in the item above 'First Floor Interior Demolition'.
- Exterior Envelope - construct new stair tower and infill opening from demolition of adjacent building with fixed glazed window.
- Interiors – build interior block and metal stud and GWB walls; interior finishes include painted walls; new floor finishes; acoustical, vapor resistant lay-in and printed concrete ceilings; interior doors; trim; minimal casework; and, personnel lockers.
- Fire suppression – new industrial coverage fire suppression system; fire extinguishers;
- Mechanical – roof mounted HVAC equipment with VAV boxes and controls; and, exhaust system for toilet and locker rooms.
- Plumbing – domestic water and wastewater systems; toilets; urinal and handwash sinks; electric water coolers; emergency eyewash stations; floor drain; showers, water softener system; and hot water heater.
- Electrical – convenience outlets; power to mechanical equipment; lighting; and data/telecommunications wiring.
- Fees and Development Expenses – general contractor fees including general conditions, overhead and profit and bonding expenses; construction contingency; development expenses for architectural, engineering and State review fees.

Revd 2/16/19

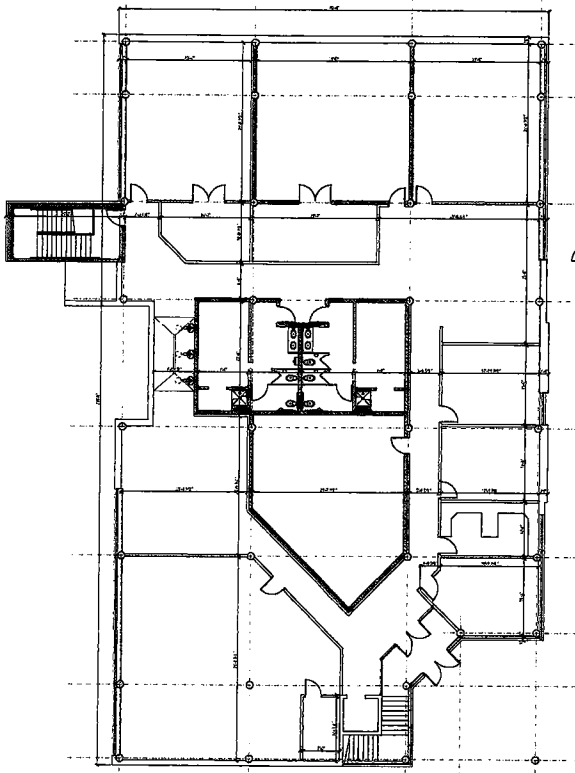

FIRST FLOOR PLAN
SCALE: 1/8" = 1'-0"

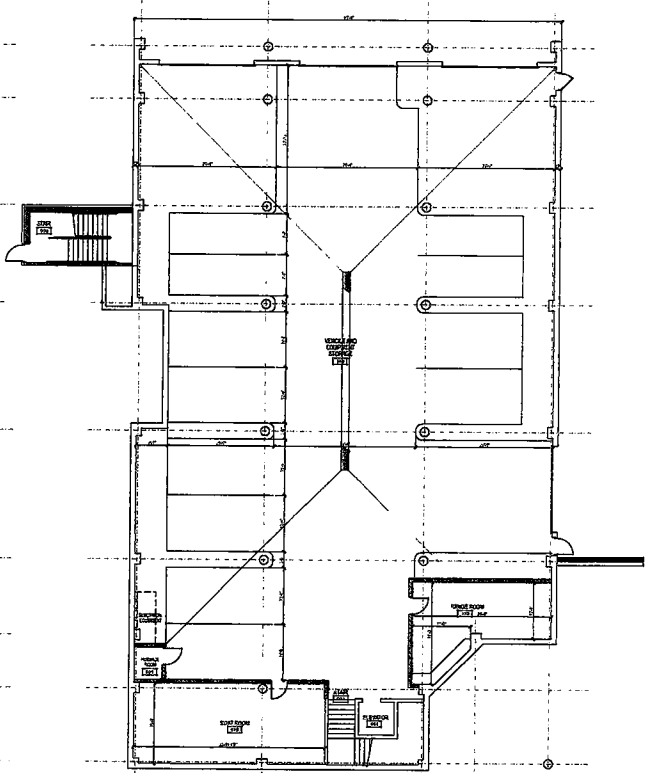

LOWER LEVEL FLOOR PLAN
SCALE: 1/8" = 1'-0"

CONTRACT NO. 19-001
DATE: 2/16/19

ALL RIGHTS RESERVED BY THE ARCHITECT. NO PART OF THIS DOCUMENT IS TO BE REPRODUCED OR TRANSMITTED IN ANY FORM OR BY ANY MEANS, ELECTRONIC OR MECHANICAL, INCLUDING PHOTOCOPYING, RECORDING, OR BY ANY INFORMATION STORAGE AND RETRIEVAL SYSTEM, WITHOUT THE WRITTEN PERMISSION OF THE ARCHITECT.

PROJECT: DODGE COUNTY LAW ENFORCEMENT VEHICLE STORAGE AND TRAINING
 LOCATION: DODGE COUNTY JUNEAU, WISCONSIN
 ARCHITECT: Angus Young
 1234 Main Street, Suite 100
 Juneau, WI 54801
 Phone: (715) 835-1234
 Fax: (715) 835-5678
 Email: info@angusyoung.com
 Website: www.angusyoung.com

PROJECT NO. 19-001
 SHEET NO. A100
 DATE: 2/16/19

DODGE COUNTY LAW ENFORCEMENT
 VEHICLE STORAGE AND TRAINING
 DODGE COUNTY
 JUNEAU, WISCONSIN

Angus Young
 Architectural
 Engineering
 Interior Design

PRELIMINARY - NOT FOR CONSTRUCTION

A100

Budget Estimate

68190 Dodge County Day Enforcement Center

Lower Level Renovation 1.00

68190 Dodge County Day Enforcement Center

Item Description				Sub-total	Cost / SF	
Site				\$8,300	\$0.80	1.8%
Utilities			\$8,300			
Demolition				\$84,400	\$8.17	18.1%
Buildings			\$84,400			
Structure				\$75,000	\$7.26	16.1%
Concrete			\$50,600			
Masonry			\$24,300			
Interior Construction				\$20,400	\$1.98	4.4%
Base Materials			\$2,400			
Ceiling Finishes			\$1,600			
Flooring			\$7,900			
Interior Doors			\$5,000			
Wall Finishes			\$3,600			
Specialties				\$3,900	\$0.38	0.8%
Casework			\$3,100			
Fire Extinguishers and Cabinets			\$800			
Fire Protection Systems				\$26,400	\$2.56	5.7%
Wet & Dry Systems			\$26,400			
Mechanical				\$95,800	\$9.28	20.6%
Exhaust			\$10,400			
Heating, Ventilation & A/C			\$82,200			
Natural Gas			\$3,100			
Plumbing				\$4,100	\$0.40	0.9%
Domestic Systems			\$4,100			
Electrical				\$63,400	\$6.14	13.6%
Lighting			\$35,800			
Power			\$8,400			
Service and Distribution			\$19,200			
Total Budget before General Contractor markups				\$381,700	\$36.97	82.0%
General Conditions	7.00% X	\$381,700	=	\$26,700		
Bonds	1.50% X	\$408,400	=	\$6,126		
General Contractor O and P	7.00% X	\$414,526	=	\$28,600		
Bid Day Budget				\$443,100	\$42.92	95.2%
Construction Contingency	5.00% X	\$443,000	=	\$22,200		
Construction Budget				\$465,300	\$45.07	100.0%
Project Development Expenses	8.00% X	\$465,300	=	\$37,200		
Project Budget				\$502,500	\$48.67	

Budget Estimate

68190 Dodge County Day Enforcement Center

Add Garage Door 1.01

68190 Dodge County Day Enforcement Center				
Item Description			Sub-total	Cost / SF
Site			\$24,600	\$246.00 46.0%
Excavation		\$5,500		
Improvements		\$17,900		
Lighting		\$1,200		
Demolition			\$11,500	\$115.00 21.5%
Selective		\$11,500		
Structure			\$1,100	\$11.00 2.0%
Masonry		\$1,100		
Exterior Enclosure			\$6,600	\$66.00 12.4%
Doors and Windows		\$6,600		
Total Budget before General Contractor markups			\$43,700	\$437.00 81.8%
General Conditions	7.00% X	\$43,700 =	\$3,100	
Bonds	1.50% X	\$46,800 =	\$702	
General Contractor O and P	7.00% X	\$47,502 =	\$3,300	
Bid Day Budget			\$50,800	\$508.00 95.1%
Construction Contingency	5.00% X	\$51,000 =	\$2,600	
Construction Budget			\$53,400	\$534.00 100.0%
Project Development Expenses	8.00% X	\$53,400 =	\$4,300	
Project Budget			\$57,700	\$577.00

FIRST FLOOR PLAN
 SCALE: 1/8" = 1'-0"

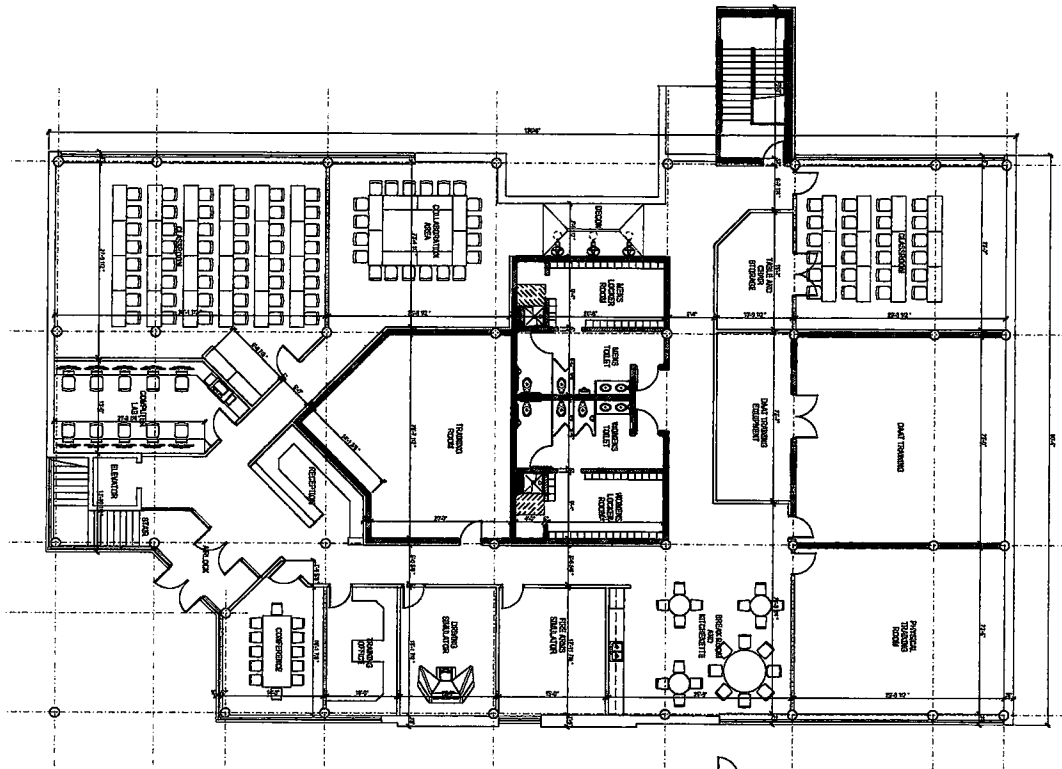

LOWER LEVEL FLOOR PLAN
 SCALE: 1/8" = 1'-0"

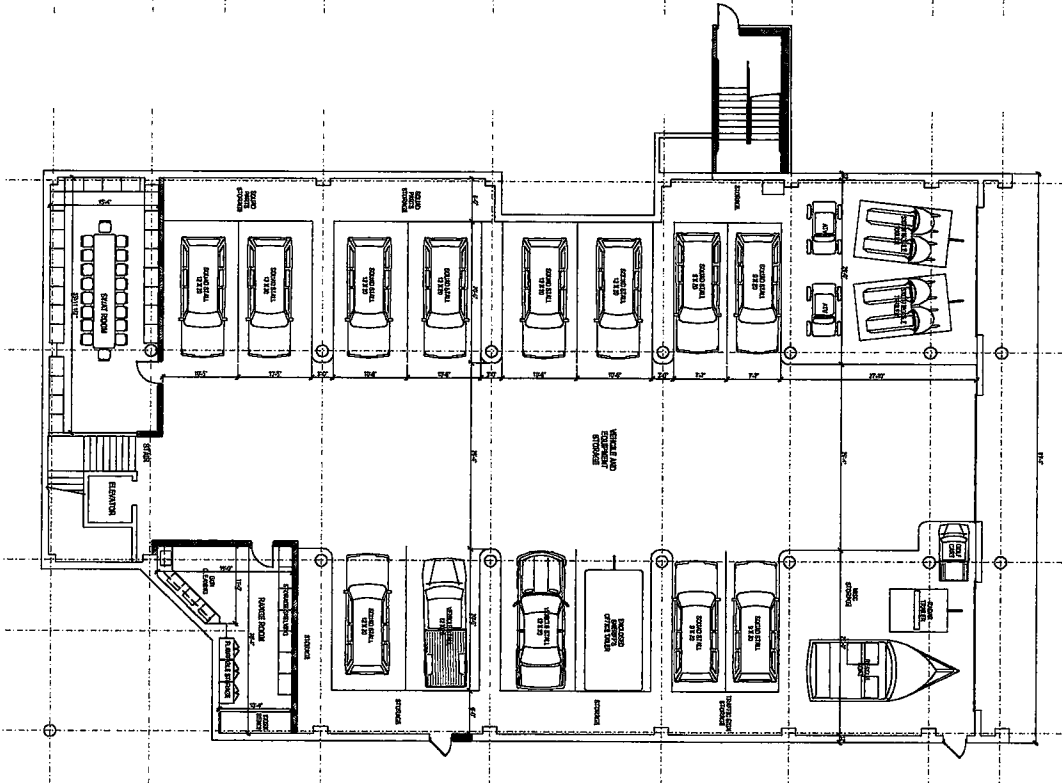

PRELIMINARY - NOT FOR CONSTRUCTION

Due to electronic distribution, this drawing may not be printed to the scale indicated on the drawing. Do NOT use scale to determine dimensions or sizes.

Due to electronic distribution, this drawing may not be printed to the scale indicated on the drawing. Do NOT use scale to determine dimensions or sizes.

A100

PROJECT NUMBER	000001
DATE	11/11/17
APPROVED BY	J.H.
REVIEWED BY	J.H.
DESIGNED BY	J.H.
DATE	11/11/17
PROJECT	000001

**DODGE COUNTY LAW ENFORCEMENT
 VEHICLE STORAGE AND TRAINING
 DODGE COUNTY
 JUNEAU, WISCONSIN**

Angus Young
 Architecture
 Engineering
 Interior Design
 555 South Tower Street, Juneau, WI 54901-0201
 Ph: (715) 736-1320 Fax: (715) 736-0644
 www.angusyoung.com

REVISIONS	DATE

Budget Estimate

68190 Dodge County Day Enforcement Center

First Floor Renovation 1.02

68190 Dodge County Day Enforcement Center

Item Description		Sub-total	Cost / SF	
Demolition		\$84,400	\$8.17	6.7%
Buildings	\$84,400			
Structure		\$203,300	\$19.69	16.2%
Concrete	\$33,800			
Masonry	\$169,500			
Steel	\$0			
Roof System		\$600	\$0.06	0.0%
Accessories	\$600			
Insulation	\$0			
Roofing	\$0			
Exterior Enclosure		\$6,300	\$0.61	0.5%
Doors and Windows	\$3,500			
Insulation	\$2,300			
Sealants	\$400			
Interior Construction		\$187,800	\$18.19	15.0%
Base Materials	\$4,300			
Ceiling Finishes	\$23,000			
Flooring	\$48,900			
Framing and Furring	\$55,700			
Interior Doors	\$25,500			
Stair Systems	\$4,400			
Trim	\$8,400			
Wall Finishes	\$17,500			
Specialties		\$20,100	\$1.95	1.6%
Casework	\$4,700			
Fire Extinguishers and Cabinets	\$800			
Locker Room Equipment	\$14,600			
Fire Protection Systems		\$29,500	\$2.86	2.4%
Wet & Dry Systems	\$29,500			
Mechanical		\$255,800	\$24.77	20.4%
Exhaust	\$1,100			
Heating, Ventilation & A/C	\$247,900			
Natural Gas	\$6,800			
Plumbing		\$96,600	\$9.36	7.7%
Domestic Systems	\$96,600			
Electrical		\$141,900	\$13.74	11.3%
Communications	\$25,700			
Lighting	\$84,400			
Power	\$21,100			
Service and Distribution	\$10,800			

68190 Dodge County Day Enforcement Center

Item Description				Sub-total Cost / SF
Total Budget before General Contractor markups				\$1,026,500 \$99.42 82.0%
General Conditions	7.00% X	\$1,026,500	=	\$71,900
Bonds	1.50% X	\$1,098,400	=	\$16,476
General Contractor O and P	7.00% X	\$1,114,876	=	\$76,900
Bid Day Budget				\$1,191,800 \$115.43 95.2%
Construction Contingency	5.00% X	\$1,192,000	=	\$59,600
Construction Budget				\$1,251,400 \$121.20 100.0%
Project Development Expenses	8.00% X	\$1,251,400	=	\$100,100
Project Budget				\$1,351,500 \$130.90

Budget Estimate

68190 Dodge County Day Enforcement Center

New Storage Building 1.03

68190 Dodge County Day Enforcement Center

Item Description		Sub-total	Cost / SF	
Site		\$74,100	\$12.35	9.5%
Excavation	\$16,100			
Improvements	\$26,000			
Landscaping	\$14,000			
Lighting	\$4,100			
Utilities	\$14,000			
Structure		\$235,000	\$39.17	30.1%
Concrete	\$119,700			
Masonry	\$45,900			
Steel	\$69,300			
Roof System		\$60,200	\$10.03	7.7%
Insulation	\$21,400			
Roofing	\$38,700			
Exterior Enclosure		\$88,900	\$14.82	11.4%
Doors and Windows	\$24,100			
Exterior Finishes	\$59,600			
Insulation	\$5,200			
Interior Construction		\$47,900	\$7.98	6.1%
Base Materials	\$0			
Ceiling Finishes	\$9,000			
Flooring	\$29,300			
Wall Finishes	\$9,600			
Specialties		\$3,900	\$0.65	0.5%
Casework	\$3,100			
Fire Extinguishers and Cabinets	\$800			
Fire Protection Systems		\$16,500	\$2.75	2.1%
Wet & Dry Systems	\$16,500			
Mechanical		\$73,800	\$12.30	9.5%
Exhaust	\$6,500			
Heating, Ventilation & A/C	\$64,200			
Natural Gas	\$3,100			
Plumbing		\$7,800	\$1.30	1.0%
Domestic Systems	\$7,800			
Electrical		\$45,000	\$7.50	5.8%
Lighting	\$26,900			
Power	\$6,100			
Service and Distribution	\$12,000			

68190 Dodge County Day Enforcement Center

Item Description				Sub-total Cost / SF
Total Budget before General Contractor markups				\$653,100 \$108.85 83.6%
General Conditions	7.00% X	\$653,100	=	\$45,700
Bonds	1.50% X	\$698,800	=	\$10,482
General Contractor O and P	7.00% X	\$709,282	=	\$48,900
Bid Day Budget				\$758,200 \$126.37 97.1%
Construction Contingency	3.00% X	\$758,000	=	\$22,700
Construction Budget				\$780,900 \$130.15 100.0%
Project Development Expenses	8.00% X	\$780,900	=	\$62,500
Project Budget				\$843,400 \$140.57

Proposal to County Board
from
Dodge County Building Committee

New

Proposal to raze, remove and restore the site area from the 1959 previous Sheriff 'J' Pod building and the repurposing of the 1977 portion of the previous Sheriff's Cell building for vehicle and equipment storage in the lower level and future redevelopment of the first floor.

The Sheriff's department currently needs space for vehicle storage space for emergency equipment (i.e. rescue boat, snowmobiles, and squads) and would need to replace space for SWAT and Range equipment and supplies if the 1977 portion of the building were razed. The proposal is to remove all interior walls and systems on both floors of the 1977 building. The lower level would be built out for storage needs and the first floor would remain unfinished until an appropriate use is determined.

The following is the outline costs for this proposal.

Project Budget:

Testing, Abatement and Remove of Hazardous Materials both buildings	\$ 85,000
Raze and Remove form 'J' Pod 1959 building	125,000
Demolition and construction cost to repurpose lower level for storage	443,500
Demolition of interiors of first floor for future use	103,000
<u>Landscaping of portion of site where 1959 building removed</u>	<u>25,000</u>
<u>Sub-total</u>	<u>\$ 781,500</u>
Project Contingencies	59,700
<u>Design and approval expenses (2020 Budget)**</u>	<u>8,800</u>
<u>Total proposed for 2020 Budget</u>	<u>\$ 850,000</u>

** Note: Funds have been expended in 2019 for design and preparation of bidding and construction documents for the storage level construction.

Dodge County Law Enforcement Center Repurposing Project
(Dodge County Law Enforcement Vehicle Storage)
January 30, 2020
Bid Results

Company	Bid Bond	Base Bid	Alt 1	Alt 2	Alt 3	Subtotal Base, Alt 1,2,3	Alt 4	Alt 5	Total
Capelle Bros. & Diedrich, Inc. 253 N. Hickory St. Fond du Lac, WI 54935	Yes	\$934,200	\$51,050	\$199,060	\$253,780	\$1,438,090	\$23,380	\$6,850	\$1,468,320
Kenneth F. Sullivan Co. 1314 Emil St. Madison, WI 53713	Yes	\$959,400	\$47,000	\$199,400	\$246,900	\$1,452,700	\$21,700	\$6,100	\$1,480,500
Creative Constructors, LLC N83W13430 Leon Rd. Menomonee Falls, WI 53051	Yes	\$1,015,500	\$44,000	\$212,000	\$388,000	\$1,659,500	\$27,000	\$11,000	\$1,697,500
Vogel Bros. Building Co. 5460 Fen Oak Dr. Madison, WI 53718	Yes	\$1,145,000	\$40,800	\$175,700	\$279,000	\$1,640,500	\$23,000	\$4,700	\$1,668,200
J. H. Hassinger N60 W16289 Kohler Ln. Menomonee Fall, WI 53051	Yes	\$1,054,954	\$56,046	\$231,507	\$324,449	\$1,666,956	\$26,324	\$9,265	\$1,702,545
Advanced Bulding Corp. 4125 Terminal Dr. Suite 100 McFarland, WI 53558	Yes	\$1,002,400	\$45,500	\$201,300	\$285,000	\$1,534,200	\$25,500	\$7,500	\$1,567,200
Bachmann Construction 1201 S. Stoughton Rd. Madison, WI 53716	Yes	\$1,098,620	\$44,369	\$222,229	\$154,852	\$1,520,070	\$23,646	\$6,273	\$1,549,989
Alternate 1: HVC Roof Top Unit Alternate 2: Replace Roof - 1977 Section Alternate 3: Demolition 1959 Building Alternate 4: Security: Card Reader Access - Renovated Building Alternate 5: Video Surveillance and recording equipment									

Dodge County Law Enforcement Vehicle Storage
 February 6th, 2020
 Project #: 68190

	Contractor Bid	AYA Cost Estimate	Difference (Cost Estimate - Bid Day)
General Requirements	\$ 69,152.00	\$ 61,410.00	\$ (7,742.00)
Waste Disposal	\$ 50,055.00	in demolition	\$ (50,055.00)
Demolition	\$ 182,644.00	\$ 187,400.00	\$ 4,756.00
Concrete Work	\$ 69,868.00	\$ 50,600.00	\$ (19,268.00)
Masonry	\$ 73,224.00	\$ 24,300.00	\$ (48,924.00)
Casework	\$ 6,735.00	\$ 3,100.00	\$ (3,635.00)
Doors/Frames/Hardware	\$ 18,787.00	\$ 5,000.00	\$ (13,787.00)
Aluminum Entrance	\$ 7,900.00		\$ (7,900.00)
Interior Finishes		\$ 11,800.00	\$ 11,800.00
Painting	\$ 7,000.00	\$ 3,600.00	\$ (3,400.00)
Louvers Infill	\$ 2,009.00		\$ (2,009.00)
Toilet Acc / Signage / Fire Extinguishers	\$ 1,654.00	\$ 890.00	\$ (764.00)
Chain-Link Fence & Bollards	\$ 5,376.00		\$ (5,376.00)
Site Utilities	\$ 19,297.00	\$ 8,300.00	\$ (10,997.00)
Porcelain Tile and Base (allowance)	\$ 1,654.00		\$ (1,654.00)
Fire Protection	\$ 39,370.00	\$ 26,400.00	\$ (12,970.00)
Plumbing	\$ 59,000.00	\$ 4,100.00	\$ (54,900.00)
HVAC	\$ 126,500.00	\$ 95,800.00	\$ (30,700.00)
Electrical	\$ 116,000.00	\$ 63,400.00	\$ (52,600.00)
Construction Contingency	\$ -	\$ 22,200.00	\$ 22,200.00
Estimate by Others			
Asbestos & Hazardous Waste Removal	\$ 77,975.00	\$ 40,500.00	\$ (37,475.00)
Cost Added During Design			\$ -
Additional Wall		\$ 2,723.00	\$ 2,723.00
New Doors		\$ 2,350.00	\$ 2,350.00
Separation of Ammunition Storage		\$ 5,125.00	\$ 5,125.00
Additional Data Room		\$ 5,125.00	\$ 5,125.00
Additional Toilet		\$ 17,800.00	\$ 17,800.00
Total	\$ 934,200.00	\$ 641,923.00	\$ (292,277.00)

Note: 1. General Conditions Includes - Permit, Large Equipment, Trucking, Temporary Facilities, Small Tools, Supervision, Etc.

DODGE COUNTY BUILDING COMMITTEE MINUTES

Administration Building, Room 1A 127 East Oak Street, Juneau, WI 53039

Date: February 6, 2020

Call to order: The meeting of the Dodge County Building Committee was called to order by Chairman Dennis Schmidt at 4:30 p.m. on February 6, 2020 in Room 1F & 1G of the Dodge County Administration Building with the following members present: **Dennis Schmidt, Cathy Houchin, Richard Fink, Mark Roesch, Kevin Burnett**

Roll Call and Non-Committee Member County Board Attendance: Russ Kottke, County Board Chairman.

Also present: Russ Freber, Director of Physical Facilities; Phil McAless, Assistant Director of Physical Facilities; Barb Brooks, Administrative Secretary; Jim Mielke, Dodge County Administrator; Dave Ehlinger, Director of Finance; Kim Nass, Corporation Counsel; Steve Genin, Angus Young; Ed Zagorski, Watertown Daily Times

Public Comment: None

Approval of the minutes from the January 9, 2020 meeting, and allow the Chairman to go out of order to efficiently conduct the meeting. A motion was made by Richard Fink and seconded by Kevin Burnett. Motion carried.

Discuss Bids for Law Enforcement Center Repurpose Project Seven General Contractor bids were received. Steve Genin from Angus Young provided bid information to the Committee.

Resolution for Repurpose of Law Enforcement Center a motion was made by Kevin Burnett and seconded by Richard Fink to send to the Finance Committee the Resolution Authorizing the Construction and General Fund Transfer for the Law Enforcement Center Repurpose Project, and the Resolution Authorizing the Construction and Internal Borrowing for the Law Enforcement Center Repurpose Project not to exceed \$1,581,800. Including Alternates 1, 2 and 3. The Committee was presented with two resolutions with different financing options for the project. The Committee discussed advancing both resolutions to the Finance Committee signifying its support of the project and deference to the Finance Committee for funding the project. Motion carried.

Resolution to Fund, Purchase and Install two Transfer Switches at the Dodge County Justice Facility with Jail Improvement Fund and General Fund Transfer a motion was made by Kevin Burnett and seconded by Mark Roesch to send to Finance the Resolution to Fund, Purchase and Install Two Transfer Switches at the Dodge County Justice Facility with Jail Improvement Fund and General Fund Transfer in the amount of \$84,550. Motion carried.

Abstract Building Parking Lot Russ notified the company that the parking lot will be available until the time of demolition.

Discussion of Remodeling Dispatch 911 Area discussed possible updating of the Dispatch area.

Courthouse Roof Drain Piping Leak there is another cast iron drain pipe leak. A plumber is coming out tomorrow. We will get price for this project. Consensus of the Committee is to move forward with the project.

2019 Budget the Budget should be good. We are waiting to obtain revenue from the Henry Dodge Office Building. Finance is working on this.

Carryover Items 2019 Budget this will be brought back at the next meeting.

A Motion was made by Kevin Burnett and seconded by Mark Roesch to convene in closed session at 5:40 p.m.

Before voting on the motion, Chairman Schmidt announced to all present that the purpose of the closed session will be to deliberate the purchasing of public properties, which, because of competitive and bargaining reason, requires a closed session, specifically, a parcel of real estate to which Dodge County Parcel Identification Number 241-1115-2232-04 has been assigned, and which is located at 150 Miller Street, in the City of Juneau, Wisconsin. The meeting is closed pursuant to Section 19.85 (1) (e) of the Wisconsin Statutes.

A roll call was taken. Motion carried by unanimous vote of all members present.

There was deliberation concerning the purchasing of public properties, which, because of competitive and bargaining reasons requires a closed session, specifically, a parcel of real estate to which Dodge County Parcel Identification Number 241-1115-2232-04 has been assigned and which is located at 150 Miller Street, in the City of Juneau, Wisconsin.

A Motion was made by Cathy Houchin and seconded by Kevin Burnett to reconvene in open session. A roll call was taken. Motion carried by unanimous vote of all members at 5:57 p.m.

Consider, deliberate and take action in respect to the parcel of real estate to which Dodge County Parcel Identification Number 241-1115-2232-04 has been assigned, located at 150 Miller Street, in the City of Juneau, Wisconsin consensus of the Committee was to obtain more information regarding the property.

Future Agenda Items Courthouse Roof Drain Pipe Leak Cost Prices, 2019 Carryover, Update on Transfer Switches at the Dodge County Justice Facility

Determine Next Meeting Date and Time Wednesday March 4, 2020 at 4:30 p.m.

Adjournment:

There being no further business to come before this Committee, the meeting was adjourned by Chairman Dennis Schmidt at 6:02 p.m.

Respectfully submitted,

Cathy Houchin, Secretary

Disclaimer: The above minutes may be approved, amended or corrected at the next committee meeting.

2
3 **Resolution Authorizing the Construction and**
4 **Internal Borrowing for the Law Enforcement Center Repurpose Project**

5
6 TO THE HONORABLE BOARD OF SUPERVISORS OF DODGE COUNTY, WISCONSIN,
7

8 **WHEREAS**, the Dodge County Building Committee (hereinafter “Committee”) has
9 studied and evaluated the needs of Dodge County and its operations, and has determined that
10 there is a need to demolish the 1959 section and remodel the 1977 section of the Law
11 Enforcement Center for purposes of Sheriff’s Office vehicle and equipment storage; and,
12

13 **WHEREAS**, as a result of its evaluation and deliberation, the Committee has formed the
14 considered conclusion that it is necessary to repurpose the Dodge County Law Enforcement
15 Center by conducting certain demolition and reconstruction in order to make the building
16 suitable for vehicle and equipment storage (“Repurpose Project”); and,
17

18 **WHEREAS**, the Committee authorized the engagement of Angus Young Associates,
19 Inc., of Janesville, Wisconsin, to propose a project budget and design for the demolition and
20 reconstruction of the Law Enforcement Center, develop a Project Manual with specifications,
21 provide complete construction documents, assist in the bidding of the Repurpose Project, and
22 provide technical support services during the construction phase of the Repurpose Project; and,
23

24 **WHEREAS**, a Request for Bids (“RFB”) titled *Dodge County Law Enforcement Vehicle*
25 *Storage*, was released on December 13, 2019, advertised as a Class 2 Notice, and opened on
26 January 30, 2020 with the results as reflected on the bid tabulation, attached hereto as Exhibit
27 “A”; and,
28

29 **WHEREAS**, the Committee recommends awarding contracts to Capelle Bros. &
30 Diedrich, Inc., of Fond du Lac, Wisconsin, in the total amount of \$1,438,090, consisting of a
31 Base Bid of \$934,200, and Alternates 1, 2, and 3 in the amount of \$503,890; and,
32

33 **WHEREAS**, the Committee, in its planning for the Repurpose Project, included the
34 Repurpose Project in the *2020-2024 Dodge County Capital Improvement Plan* which was
35 approved on October 15, 2019; and,
36

37 **WHEREAS**, the proposed funding source of the Repurpose Project consists of an
38 internal borrowing; and,
39

40 **WHEREAS**, the Committee has established a total construction budget for the
41 Repurpose Project in the amount of \$1,581,899, a copy of which is attached hereto as Exhibit
42 “B”; and,
43

44 **WHEREAS**, the Dodge County Finance Committee, at its meeting on February 17,
45 2020, considered the feasibility of an internal borrowing and other funding sources and
46 recommends the following terms for an internal borrowing based on the Amortization Schedule,
47 attached hereto and incorporated herein as Exhibit “C” (the final amortization schedule will be
48 based on actual construction costs):

- 1
- 2 1. The Repurpose Projected principal amount of the loan will be \$1,581,899;
- 3
- 4 2. The source of the funds will be from the Unassigned General Fund in an amount
- 5 not to exceed \$1,581,899;
- 6
- 7 3. The interest rate will be 1.9 percent per annum, calculated on the unreplenished,
- 8 outstanding principal amount, on February 1 and August 1 in each of the
- 9 following years: 2021, 2022, 2023, 2024, and 2025;
- 10
- 11 4. The financing term will be 5.5 years, and will commence on February 1, 2020,
- 12 and end on August 1, 2025, both inclusive; and,
- 13
- 14 5. The Dodge County Finance Director will replenish the Unassigned General Fund
- 15 by making deposits to the Unassigned General Fund, of Dodge County sales and
- 16 use tax receipts, in the appropriate amounts of principal in each of the following
- 17 years: 2021, 2022, 2023, 2024, and 2025; and,
- 18
- 19 6. The Dodge County Physical Facilities Department shall budget for annual interest
- 20 payments in each of the following years: 2021, 2022, 2023, 2024, and 2025; and,
- 21

22 **SO, NOW, THEREFORE, BE IT RESOLVED**, by the Dodge County Board of
23 Supervisors that the Repurpose Project, on the recommendation of the Dodge County Building
24 Committee, hereby authorizes the Repurpose Project to proceed forthwith, accepts the bid of
25 Capelle Bros. & Diedrich, Inc., in the total amount of \$1,438,090; and,
26

27 **BE IT FURTHER RESOLVED**, that the Dodge County Board of Supervisors, on the
28 recommendation of the Finance Committee, hereby authorizes the use of Dodge County funds in
29 an amount not to exceed \$1,581,899, on the following terms and conditions:
30

- 31 1. The Repurpose Projected principal amount of the loan will be \$1,438,090;
- 32
- 33 2. The source of the funds will be from the Unassigned General Fund in an amount
- 34 not to exceed \$1,581,899;
- 35
- 36 3. The interest rate will be 1.9 percent per annum, calculated on the unreplenished,
- 37 outstanding principal amount, on February 1 and August 1 in each of the
- 38 following years: 2021, 2022, 2023, 2024, and 2025;
- 39
- 40 4. The financing term will be 5.5 years, and will commence on February 1, 2020,
- 41 and end on August 1, 2025, both inclusive;
- 42
- 43 5. The Dodge County Finance Director will replenish the Unassigned General Fund
- 44 by making deposits to the Unassigned General Fund, of Dodge County sales and
- 45 use tax receipts, in the appropriate amounts of principal in each of the following
- 46 years: 2021, 2022, 2023, 2024, and 2025; and,
- 47

1 6. The Dodge County Physical Facilities Department shall budget for interest
2 payments in each of the following Years: 2021, 2022, 2023, 2024, and 2025; and,
3

4 **BE IT FURTHER RESOLVED**, by the Dodge County Board of Supervisors, that the
5 Dodge County Administrator and the Dodge County Clerk are authorized to execute contracts
6 necessary for the completion of the Repurpose Project, consistent with the award made herein;
7 and,
8

9 **BE IT FINALLY RESOLVED**, that upon presentation of properly reviewed and
10 approved invoices by the Dodge County Administrator, payment of said invoices may be made
11 from Dodge County funds taken from the Unassigned General Fund in a total amount not to
12 exceed \$1,581,899.
13

All of which is respectfully submitted this 25th day of February, 2020.

Dodge County Building Committee:

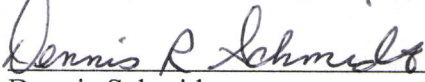
Dennis Schmidt

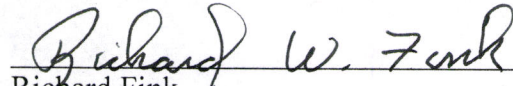

Richard Fink

Mark Roesch

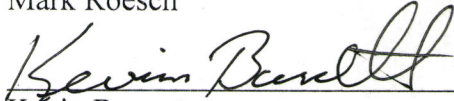
Cathy Houchin

Kevin Burnett

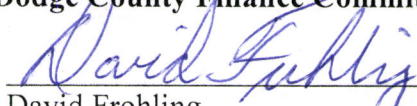
Dodge County Finance Committee:

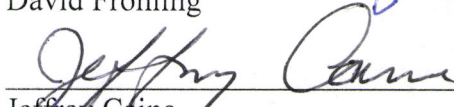

David Frohling

Ed Benter

Jeffrey Caine

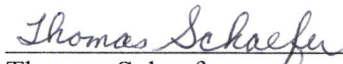
David Guckenberger

Thomas Schaefer

***FISCAL NOTE:** The adopted budget for 2020 included \$940,000 for this purpose in Bus Unit 1902 Law Enforcement Center (JD Edwards). The budget will be amended for the difference between the final approved budget and the original \$940,000. Finance Committee review date: February 17, 2020. Chair initials: .*

Vote Required: Two-thirds of members elect.

Resolution Summary: Resolution authorizing the construction and internal borrowing for the Law Enforcement Center Repurpose Project.

BID TABULATION FORM

Project: Dodge County Law Enforcement
 Bid opening: 30-Jan-20
 Project #: 68190

CONTRACTOR	Attended Mandatory Walk Through	Addendum Received	Bid Bond	Schedule (Days)	BASE BID	Alternate 1 (RTU Additive)	Alternate 2 (TPO Roof)	Alternate 3 (Demolition of Facility)	Alternate 4 (Card Access)	Alternate 5 (Surveillance)	BID TOTAL (Base Bid + Alternate 1 thru Alternate 3)
Advanced Building Corporation	X	X	X	180	\$ 1,002,400.00	\$ 45,500.00	\$ 201,300.00	\$ 285,000.00	\$ 25,500.00	\$ 7,500.00	\$ 1,534,200.00
Capelle Brothers & Diehrich Inc	X	X	X	240	\$ 934,200.00	\$ 51,050.00	\$ 199,060.00	\$ 253,780.00	\$ 23,380.00	\$ 6,850.00	\$ 1,438,090.00
JH Hassinger Inc.	X	X	X	270	\$ 1,054,954.00	\$ 56,046.00	\$ 231,507.00	\$ 324,449.00	\$ 26,324.00	\$ 9,265.00	\$ 1,666,956.00
Vogel Brothers Building Co.	X	X	X	150	\$ 1,145,000.00	\$ 40,800.00	\$ 175,700.00	\$ 279,000.00	\$ 23,000.00	\$ 4,700.00	\$ 1,640,500.00
Bachmann Construction	X	X	X	167	\$ 1,098,620.00	\$ 44,369.00	\$ 222,229.00	\$ 154,852.00	\$ 23,646.00	\$ 6,273.00	\$ 1,520,070.00
Creative Constructors, LLC	X	X	X	260	\$ 1,015,500.00	\$ 44,000.00	\$ 212,000.00	\$ 388,000.00	\$ 27,000.00	\$ 11,000.00	\$ 1,659,500.00
Sullivan desighBUILD	X	X	X	180	\$ 959,400.00	\$ 47,100.00	\$ 199,400.00	\$ 246,900.00	\$ 21,700.00	\$ 61,000.00	\$ 1,452,800.00
											\$0
											\$0
											\$0
											\$0
											\$0
											\$0
											\$0
											\$0
											\$0
											\$0
											\$0
											\$0
											\$0
											\$0

PROJECT COST ITEMIZATION FOR LAW ENFORCEMENT CENTER REPURPOSE PROJECT

February 25, 2020

Project Cost

Base Bid Award to Capelle Bros. & Dietrich, Inc.	\$934,200
Alternate No. 1-RTU Additive	51,050
Alternate No. 2-TPO Roof	199,060
Alternate No. 3-Demolition	<u>253,780</u>
Total Capelle Bros. & Dietrich, Inc. Bid with Alternates	1,438,090
Project Contingency (10% of Bid Award)	<u>143,809</u>
Total Project Cost:	\$1,581,899
Total Project Budget:	\$1,581,899

Loan Amortization Schedule

Proposed Law Enforcement Funding Option #2 & #3

February 4, 2020

Loan Information

Loan Amount	1,581,899.00
Annual Interest Rate	1.90%
Term of Loan in Years	5.5
First Payment Date	8/1/2020
Payment Frequency	Semi-Annual
Compound Period	Semi-Annual
Payment Type	End of Period
Rounding	On

Semi-Annual Payment 152,135.26

Summary

Rate (per period)	0.950%
Total Payments	1,679,581.26
Total Interest	97,682.26
Est. Interest Savings	(6,093.35)

Alternative #3	
Original budget	940,000
Closure C-Juneau TIF #2	43,599
Closure C-Juneau TIF #3	9,414
Closure C-Mayville TIF #3	229,479
Additional sales tax usage	359,407
Total	1,581,899

Amortization Schedule

No.	Due Date	Payment Due	Additional Payment	Total Payment	Interest	Principal	Balance
							1,581,899.00
1	8/1/2020	152,135.26	(137,107.22)	15,028.04	15,028.04	0.00	1,581,899.00
2	2/1/2021	152,135.26	21,082.68	173,217.94	15,028.04	158,189.90	1,423,709.10
3	8/1/2021	152,135.26	19,579.88	171,715.14	13,525.24	158,189.90	1,265,519.20
4	2/1/2022	152,135.26	18,077.07	170,212.33	12,022.43	158,189.90	1,107,329.30
5	8/1/2022	152,135.26	16,574.27	168,709.53	10,519.63	158,189.90	949,139.40
6	2/1/2023	152,135.26	15,071.46	167,206.72	9,016.82	158,189.90	790,949.50
7	8/1/2023	152,135.26	13,568.66	165,703.92	7,514.02	158,189.90	632,759.60
8	2/1/2024	152,135.26	12,065.86	164,201.12	6,011.22	158,189.90	474,569.70
9	8/1/2024	152,135.26	10,563.05	162,698.31	4,508.41	158,189.90	316,379.80
10	2/1/2025	152,135.26	9,060.25	161,195.51	3,005.61	158,189.90	158,189.90
11	8/1/2025	159,692.70	0.00	159,692.70	1,502.80	158,189.90	0.00