

DERGE PARK

N8379 County Road CP
Beaver Dam, WI 53916



(920) 386-3700 | parks@co.dodge.wi.us | dodgeparks.com



SCALE: 1"=125'

Map Produced By:
Dodge County
Land Resources & Parks

LEGEND

- 17 Campsites
- 1 Enclosed Quonset Shelter
- Restrooms
- Showers
- Boat Launch
- Picnic Area
- Parking
- Handpump Well
- Grill
- Fire Wood
- Dump Station
- Playground
- Campsite Pads
- Buildings
- Drainage Swale
- Trails
- Paved Path
- Roads
- Wooded Areas

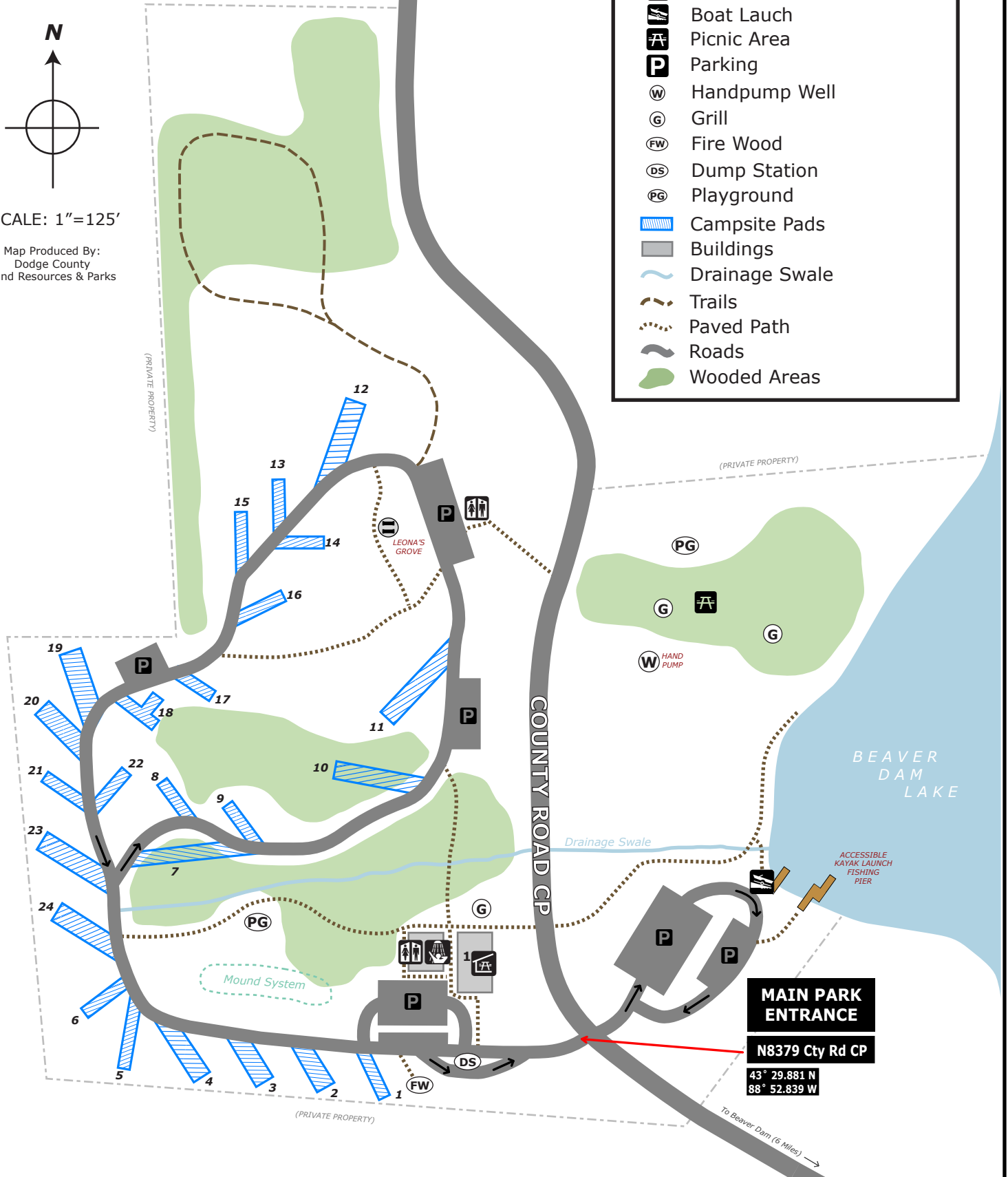

**MAIN PARK
ENTRANCE**

N8379 Cty Rd CP

43° 29.881 N
88° 52.839 W