

**Notice of Meeting of the Dodge County Board of Supervisors**

There will be a meeting of the Dodge County Board of Supervisors on **Wednesday, February 17, 2016, at 7:00 P.M.** in the County Board Room located on the fourth floor of the Administration Building, located at 127 East Oak Street, Juneau, Wisconsin.

The Agenda for the Meeting is as follows:

**Call to Order by Russell Kottke, County Board Chairman**

**Pledge of Allegiance**

**Roll Call**

**Approve Minutes from December 15, 2015, County Board Session**

**Communications on File**

**Special Orders of Business**

Confirm Appointments made by County Administrator

1. Appoint Larry Dogs to fill a vacancy on the Board of Adjustment. His term will commence on February 17, 2016 and expire on July 1, 2018.
2. Appoint Carolyn Flowers, Ivan Elm, and Harvey Grulke to fill vacancies on the Aging/Nutrition Advisory Committee. Their terms will commence on February 17, 2016 and expire on July 1, 2018.

**Resolutions on File**

- 15-70 Authorize and Approve Purchase of Compensation Consulting Services from Carlson Dettman and Direct Finance Director to Carry Over Funds from the Human Resources Department Budget to Pay for the Consulting Services – Human Resources and Labor Negotiations Committee.
- 15-71 Authorize and Approve Purchase of Computer Software and Support Services from Meridian IT, Inc. – Information Technology Committee.
- 15-72 Establish Salaries for County Clerk, County Treasurer and Register of Deeds – Human Resources and Labor Negotiations Committee.
- 15-73 Create 30 New, Non-Benefited, Occasional Part-Time, Miscellaneous Positions of Hazardous Materials Responder in the Emergency Management Department – Executive Committee.
- 15-74 Authorize Completion of Simulcast Phase III and IFERN Project – Executive Committee.
- 15-75 Approve Action of the Human Resources and Labor Negotiations Committee and the Executive Committee to Adjust the Labor Grade Structure and to Place the Administrator Position in Step 1 of Labor Grade 18 – Executive and Human Resources and Labor Negotiations Committees.
- 15-76 Approve the Seventh Amendment to County Administrator Employment Agreement – Executive Committee.
- 15-77 Change Amounts of Appropriations in the 2015 Dodge County Budget in Clearview – Finance Committee.
- 15-78 Change Amounts of Appropriations in the 2015 Dodge County Budget in the Courts – Finance Committee.

- 15-79 Change Amounts of Appropriations in the 2015 Dodge County Budget in the Highway Department– Finance Committee.
- 15-80 Change Amounts of Appropriations in the 2015 Dodge County Budget in the Human Services and Health Department– Finance Committee.
- 15-81 Authorize Carry Over of Funds for the Dodge County Clerk – Finance Committee.
- 15-82 Authorize Carry Over of Funds for the Maintenance Department – Finance Committee.
- 15-83 Approve the Carry Over of Funds from the 2015 Dodge County Budget to the 2016 Dodge County Budget – Finance Committee.
- 15-84 Approve Purchase of Skid Loader and Accessories – Building Committee.
- 15-85 Authorize Purchase of Equipment – Highway Committee.
- 15-86 Authorize Purchase of One Twin Pump Crackfilling Melter/Applicator – Highway Committee.

**Report on File**

- 1. Ordinance No. 948 – Amend Land Use Code – Patrick and Shelley Tighe Property – Section 17, Town of Lomira – Planning, Development and Parks Committee.

**Ordinance on File**

- 1. Ordinance No. 949 – Authorize the Taxation Committee to Waive the 0.5% per Month Penalty on Delinquent General Property Taxes, Special Assessments, Special Charges and Special Taxes Included in the Tax Roll – Taxation Committee.

**Claims on File**

- 1. A claim by AT&T for money damages in the amount of \$2,513.43, for costs to repair three buried telephone cables and a pedestal was received in the Office of the Dodge County Clerk on August 27, 2015. The claim arises from an incident that is alleged to have occurred on or about July 20, 2015, near W9844 CTH G in the Town of Calamus, Dodge County, Wisconsin, and wherein an employee of Dodge County was operating a mower in the right-of-way of CTH G, and the mower caused damage to three marked AT&T buried telephone cables and a pedestal, and AT&T expended \$2,513.43 to repair the three marked AT&T buried telephone cables and a pedestal.
- 2. A claim by Robert and Anna Schutte for money damages in the amount of \$12,231 was received in the Dodge County Highway Department on November 30, 2015. This claim arises from a flooding event that is alleged to have occurred on July 13, 2015, at W9154 CTH S, in the Town of Beaver Dam, Dodge County, Wisconsin. Robert and Anna Schutte are the owners of real property and personal property located at W9154 CTH S. Robert and Anna Schutte seek money damages in the amount of \$12,231 for physical damage to items of personal property, for physical damage to real property, and for costs of labor, equipment rental and use, and various other expenses that they allegedly incurred in their efforts to save personal property, including animals, and real property, that were affected by flooding. Robert and Anna Schutte further allege that:
  - a. The losses and damages that they incurred were caused by the action of the Dodge County Highway Department in installing an incorrectly sized culvert on their property when the Dodge County Highway Department reconstructed CTH S;

- b. Their property was flooded, first, in 2008, due to the fact that the culvert installed was not able to properly handle the flow of water through their property;
- c. At that time, they notified Dodge County of the problems they were experiencing, due to this incorrectly-sized culvert having been installed on their property;
- d. On July 13, 2015, they again experienced the severe flooding of their property;
- e. The culvert was replaced by the Dodge County Highway Department with proper, larger-sized culverts on October 6-7, 2015; and,
- f. Had these larger-sized culverts been originally installed at the time CTH S was reconstructed, or even replaced after their first flooding in 2008, they would not have experienced on July 13, 2015, the flooding or incurred the losses, described above.

**Distribution of Enterprise Resource Planning (ERP) Business Plan and Background Information Presented by Julie Kolp, Finance Director and Ruth Otto, Information Technology Director – Information only. No action will be taken.**

**Set Next Meeting Date & Time**

**Recess**

Any person wishing to attend who, because of a disability, requires special accommodation, should contact the Dodge County Clerk's Office at (920) 386-3600, at least 24 hours before the scheduled meeting time so appropriate arrangements can be made. The building entrance which is accessible by a person with a disability is located on the east side of the building off of Miller Street.

Any invocation that may be offered before the official start of the Board meeting shall be the voluntary offering of a private citizen, to and for the benefit of the Board. The views or beliefs expressed by the invocation speaker have not been previously reviewed or approved by the Board, and the Board does not endorse the religious beliefs or views of this, or any other speaker.

COMMITTEE NAME		COUNTY BOARD							
MEETING DATE		February 17, 2016							
						Approval	<i>RK</i>	Date	<i>2-24-2016</i>
						Chair	<i>Russ Kottke</i>		
VENDOR	NAME	PRESENT	ABSENT	PERDIEM	MILES	AMOUNT	MEALS	AMOUNT	
10023	Adelmeyer, Gerald	X		50.00	43	23.22			
11994	Behl, Allen	X		50.00	32	17.28			
19566	Berres, Jeff	X		50.00	42	22.68			
11970	Bischoff, Larry	X		50.00	20	10.80			
10583	Bobholz, Janice		Excused	0.00	0	0.00			
26899	Bobholz, Mary	X		50.00	28	15.12			
10008	Caine, Chester		Excused	0.00	0	0.00			
46788	Derr, Lisa	X		50.00	21	11.34			
10195	Duchac, Jeffry	X		50.00	30	16.20			
28760	Frohling, David	X		50.00	29	15.66			
43805	Gohr, Phillip		Excused	0.00	0	0.00			
16723	Grebel, Randy	X		50.00	13	7.02			
41853	Greshay, Richard	X		50.00	14	7.56			
48638	Hilbert, Dan	X		50.00	20	10.80			
43806	Houchin, James	X		50.00	33	17.82			
25412	Johnson, Harold	X		50.00	54	29.16			
16348	Kottke, Russell	X		55.00	30	16.20			
10015	Kriewald, Howard	X		50.00	20	10.80			
29374	Maly, Donna	X		50.00	20	10.80			
22503	Marsik, Joseph M.	X		50.00	40	21.60			
10313	Mattson, Rodger	X		50.00	20	10.80			
34243	Miller, MaryAnn	X		50.00	0	0.00			
43804	Muche, William	X		50.00	22	11.88			
36482	Nelson, Ed	X		50.00	32	17.28			
47109	Nickel, Thomas	X		50.00	34	18.36			
10018	Pollesch, Darrell	X		50.00	38	20.52			
46789	Roesch, Mark E.	X		50.00	34	18.36			
30697	Schaefer, Thomas	X		50.00	30	16.20			
15819	Schmidt, Dennis	X		50.00	0	0.00			
37252	Schraufnagel, Larry	X		50.00	50	27.00			
26089	Stousland, Glenn	X		50.00	20	10.80			
45723	Uttke, Wayne	X		50.00	50	27.00			
Supervisor Berres arrived at 7:14 p.m.									
Supervisor Miller claimed zero mileage									

**Dodge County Board of Supervisors  
February 17, 2016 – 7:00 p.m.  
Administration Building - Juneau, Wisconsin**

The February session of the Dodge County Board of Supervisors was called to order by Chairman Russell Kottke at 7:00 p.m. in the County Board Room on the fourth floor of the Administration Building, located at 127 East Oak Street, Juneau.

The Board rose to say the Pledge of Allegiance.

Roll call was taken by the Clerk with all Supervisors being in attendance with the exception of Supervisors J. Bobholz, Caine, and Gohr who had previously asked to be excused and Supervisor Berres. Supervisor Berres arrived at 7:14 p.m.

A motion was made by Supervisor Pollesch and seconded by Supervisor Duchac to approve the minutes of the December 15, 2015, session of the County Board as recorded, and dispense with the reading of the minutes. The motion passed by acclamation with no negative votes cast, and was so ordered by the Chairman.

**Communications on File**

Karen J. Gibson, County Clerk, read a letter and Resolution from the Village of Reeseville regarding the railroad crossing in Reeseville. The Chairman ordered the letter and Resolution be placed on file and he stated the railroad crossing issue will be forwarded to the Highway Committee for their review. Supervisor Johnson stated the highway committee has been discussing the issue at committee meetings. The Clerk continued by reading a letter and Resolution from the Town of Beaver Dam regarding the water rescue and dive team. The Chairman ordered the letter and Resolution be placed on file and he stated the water rescue and dive team issue will be on future Law Enforcement and Executive Committee agendas.

**Special Orders of Business**

Chairman Kottke called for the First Special Order of Business: Confirm appointments made by County Administrator, James Mielke. Appoint Larry Dogs to fill a vacancy on the Board of Adjustment. His term will commence on February 17, 2016 and expire on July 1, 2018. A motion to approve the appointment was made by Supervisor Frohling and seconded by Supervisor Grebel. The motion passed by acclamation with no negative votes cast, thereby approving the appointment.

Mr. Mielke then appointed Carolyn Flowers, Ivan Elm, and Harvey Grulke to fill vacancies on the Aging/Nutrition Advisory Committee. Their terms will commence on February 17, 2016 and expire on July 1, 2018. A motion to approve the appointments was made by Supervisor Maly and seconded by Supervisor Schraufnagel. The motion passed by acclamation with no negative votes cast, thereby approving the appointments.

Chairman Kottke asked the Board if there were any objections to the Clerk reading the "Therefore Be It Resolved" paragraphs only. Hearing no objections, the Chairman directed the clerk to proceed.

The following Resolutions, Report, Ordinance and Claims were read by the Clerk and acted upon by the Board:

**Resolution No. 15-70** Authorize and Approve Purchase of Compensation Consulting Services from Carlson Dettman and Direct Finance Director to Carry Over Funds from the Human Resources Department Budget to Pay for the Consulting Services – Human Resources and Labor Negotiations

Committee. A motion for adoption was made by Supervisor Schmidt and seconded by Supervisor Marsik. Question by Supervisor Berres answered by Supervisor Marsik and James Mielke, County Administrator. The vote was cast with 27 ayes and 2 noes, thereby adopting the Resolution.

**Ayes:** Pollesch, Kottke, Nelson, Marsik, Grebel, Greshay, Kriewald, Schaefer, Uttke, Adelmeyer, Muche, Johnson, Schraufnagel, Bischoff, Behl, Houchin, Roesch, Frohling, Schmidt, Duchac, Nickel, Maly, Hilbert, Miller, Stousland, Derr, Mattson. Total 27.

**Noes:** M. Bobholz, Berres. Total 2.

**Absent:** J. Bobholz, Gohr, Caine. Total 3.

**Resolution No. 15-71** Authorize and Approve Purchase of Computer Software and Support Services from Meridian IT, Inc. – Information Technology Committee. A motion for adoption was made by Supervisor Maly and seconded by Supervisor Duchac. The vote was cast with all voting in the affirmative, thereby adopting the Resolution.

**Resolution No. 15-72** Establish Salaries for County Clerk, County Treasurer and Register of Deeds – Human Resources and Labor Negotiations Committee. A motion for adoption was made by Supervisor Marsik and seconded by Supervisor Schmidt. Question by Supervisor Houchin answered by Supervisor Marsik. The vote was cast with all voting in the affirmative, thereby adopting the Resolution.

**Resolution No. 15-73** Create 30 New, Non-Benefited, Occasional Part-Time, Miscellaneous Positions of Hazardous Materials Responder in the Emergency Management Department – Executive Committee. A motion for adoption was made by Supervisor Grebel and seconded by Supervisor Schaefer. Questions by Supervisors Grebel and Muche answered by Amy Nehls, Emergency Management Director. The vote was cast with all voting in the affirmative, thereby adopting the Resolution.

**Resolution No. 15-74** Authorize Completion of Simulcast Phase III and IFERN Project – Executive Committee. A motion for adoption was made by Supervisor Miller and seconded by Supervisor Schraufnagel. Question by Supervisor Stousland answered by Supervisor Frohling. The vote was cast with all voting in the affirmative, thereby adopting the Resolution.

**Resolution No. 15-75** Approve Action of the Human Resources and Labor Negotiations Committee and the Executive Committee to Adjust the Labor Grade Structure and to Place the Administrator Position in Step 1 of Labor Grade 18 – Executive and Human Resources and Labor Negotiations Committees. A motion for adoption was made by Supervisor Maly and seconded by Supervisor Marsik. Question by Supervisor M. Bobholz answered by Supervisor Marsik. Comments by Supervisors Johnson, Stousland, Maly, Berres and Chairman Kottke. The vote was cast with 24 ayes, 4 noes and 1 abstention, thereby adopting the Resolution.

**Ayes:** Pollesch, Kottke, Nelson, Marsik, Grebel, Greshay, Kriewald, Schaefer, Uttke, Adelmeyer, Muche, Johnson, Schraufnagel, Bischoff, Behl, Frohling, Schmidt, Duchac, Nickel, Maly, Hilbert, Miller, Derr, Mattson. Total 24.

**Noes:** M. Bobholz, Berres, Roesch, Stousland. Total 4.

**Abstain:** Houchin. Total 1.

**Absent:** J. Bobholz, Gohr, Caine. Total 3.

**Resolution No. 15-76** Approve the Seventh Amendment to County Administrator Employment Agreement – Executive Committee. A motion for adoption was made by Supervisor Maly and seconded by

Supervisor Frohling. The vote was cast with 24 ayes, 4 noes and 1 abstention, thereby adopting the Resolution.

**Ayes:** Pollesch, Kottke, Nelson, Marsik, Grebel, Greshay, Kriewald, Schaefer, Uttke, Adelmeyer, Muche, Johnson, Schraufnagel, Bischoff, Behl, Frohling, Schmidt, Duchac, Nickel, Maly, Hilbert, Miller, Derr, Mattson. Total 24.

**Noes:** M. Bobholz, Berres, Roesch, Stousland. Total 4.

**Abstain:** Houchin. Total 1.

**Absent:** J. Bobholz, Gohr, Caine. Total 3.

**Resolution No. 15-77** Change Amounts of Appropriations in the 2015 Dodge County Budget in Clearview – Finance Committee. A motion for adoption was made by Supervisor Nickel and seconded by Supervisor Duchac. The vote was cast with all voting in the affirmative, thereby adopting the Resolution.

**Resolution No. 15-78** Change Amounts of Appropriations in the 2015 Dodge County Budget in the Courts – Finance Committee. A motion for adoption was made by Supervisor Miller and seconded by Supervisor Schaefer. The vote was cast with all voting in the affirmative, thereby adopting the Resolution.

**Resolution No. 15-79** Change Amounts of Appropriations in the 2015 Dodge County Budget in the Highway Department– Finance Committee. A motion for adoption was made by Supervisor Grebel and seconded by Supervisor Bischoff. Question by Supervisor Berres answered by Supervisor Uttke. The vote was cast with all voting in the affirmative, thereby adopting the Resolution.

**Resolution No. 15-80** Change Amounts of Appropriations in the 2015 Dodge County Budget in the Human Services and Health Department– Finance Committee. A motion for adoption was made by Supervisor Stousland and seconded by Supervisor Schaefer. The vote was cast with all voting in the affirmative, thereby adopting the Resolution.

**Resolution No. 15-81** Authorize Carry Over of Funds for the Dodge County Clerk – Finance Committee. A motion for adoption was made by Supervisor Johnson and seconded by Supervisor Nickel. The vote was cast with all voting in the affirmative, thereby adopting the Resolution.

**Resolution No. 15-82** Authorize Carry Over of Funds for the Maintenance Department – Finance Committee. A motion for adoption was made by Supervisor Nickel and seconded by Supervisor Schraufnagel. The vote was cast with 28 ayes and 1 no, thereby adopting the Resolution.

**Ayes:** Pollesch, Kottke, M. Bobholz, Nelson, Marsik, Grebel, Greshay, Kriewald, Schaefer, Uttke, Adelmeyer, Muche, Johnson, Schraufnagel, Bischoff, Behl, Houchin, Roesch, Frohling, Schmidt, Duchac, Nickel, Maly, Hilbert, Miller, Stousland, Derr, Mattson. Total 28.

**No:** Berres. Total 1.

**Absent:** J. Bobholz, Gohr, Caine. Total 3.

**Resolution No. 15-83** Approve the Carry Over of Funds from the 2015 Dodge County Budget to the 2016 Dodge County Budget – Finance Committee. A motion for adoption was made by Supervisor Frohling and seconded by Supervisor Bischoff. The vote was cast with all voting in the affirmative, thereby adopting the Resolution.

**Resolution No. 15-84** Approve Purchase of Skid Loader and Accessories – Building Committee. A motion for adoption was made by Supervisor Johnson and seconded by Supervisor Schraufnagel.

Question by Supervisor Grebel answered by Supervisor Mattson. Comments by Supervisors Frohling and Berres. The vote was cast with all voting in the affirmative, thereby adopting the Resolution.

**Resolution No. 15-85** Authorize Purchase of Equipment – Highway Committee. A motion for adoption was made by Supervisor Johnson and seconded by Supervisor Nickel. Questions by Supervisors Greshay and M. Bobholz answered by Supervisor Johnson, Brian Field, Highway Commissioner and John Haase, Highway Shop Superintendent. Comments by Supervisors Frohling, Grebel and Johnson. The vote was cast with all voting in the affirmative, thereby adopting the Resolution.

**Resolution No. 15-86** Authorize Purchase of One Twin Pump Crackfilling Melter/Applicator – Highway Committee. A motion for adoption was made by Supervisor Johnson and seconded by Supervisor Muche. The vote was cast with all voting in the affirmative, thereby adopting the Resolution.

**Report No. 1** Ordinance No. 948 – Amend Land Use Code – Patrick and Shelley Tighe Property – Section 17, Town of Lomira – Planning, Development and Parks Committee. A motion for adoption was made by Supervisor Schaefer and seconded by Supervisor Johnson. The vote was cast with all voting in the affirmative, thereby adopting the Report.

**Ordinance No. 1** Ordinance No. 949 – Authorize the Taxation Committee to Waive the 0.5% per Month Penalty on Delinquent General Property Taxes, Special Assessments, Special Charges and Special Taxes Included in the Tax Roll – Taxation Committee. A motion for adoption was made by Supervisor Schmidt and seconded by Supervisor Berres. Questions by Supervisors Stousland and Maly answered by Supervisor Berres and Patti Hilker, County Treasurer. Comments by Supervisors Greshay, Mattson and Berres. The vote was cast with all voting in the affirmative, thereby adopting the Ordinance.

**Claim No. 1** A claim by AT&T for money damages in the amount of \$2,513.43, for costs to repair three buried telephone cables and a pedestal was received in the Office of the Dodge County Clerk on August 27, 2015. The Clerk read a report from the Executive Committee recommending the claim be disallowed. A motion to approve the disallowance was made by Supervisor Johnson and seconded by Supervisor Maly. The vote was cast with 27 ayes and 2 noes, thereby disallowing the claim.

**Ayes:** Pollesch, Kottke, Nelson, Marsik, Grebel, Greshay, Kriewald, Schaefer, Adelmeyer, Muche, Johnson, Schraufnagel, Bischoff, Behl, Berres, Houchin, Roesch, Frohling, Schmidt, Duchac, Nickel, Maly, Hilbert, Miller, Stousland, Derr, Mattson. Total 27.

**Noes:** M. Bobholz, Uttke. Total 2.

**Absent:** J. Bobholz, Gohr, Caine. Total 3.

**Claim No. 2** A claim by Robert and Anna Schutte for money damages in the amount of \$12,231 was received in the Dodge County Highway Department on November 30, 2015. This claim arises from a flooding event that is alleged to have occurred on July 13, 2015, at W9154 CTH S, in the Town of Beaver Dam, Dodge County, Wisconsin. Robert and Anna Schutte are the owners of real property and personal property located at W9154 CTH S. Robert and Anna Schutte seek money damages in the amount of \$12,231 for physical damage to items of personal property, for physical damage to real property, and for costs of labor, equipment rental and use, and various other expenses that they allegedly incurred in their efforts to save personal property, including animals, and real property, that were affected by flooding. The Clerk read a report from the Executive Committee recommending the claim be disallowed. A motion to approve the disallowance was made by Supervisor Derr and seconded by Supervisor Nickel. Question by



Supervisor Houchin answered by Brian Field, Highway Commissioner. Comment by Supervisor Derr. The vote was cast with 25 ayes, 3 noes and 1 abstention, thereby disallowing the claim.

**Ayes:** Pollesch, Kottke, Nelson, Marsik, Grebel, Greshay, Kriewald, Schaefer, Adelmeyer, Muche, Johnson, Schraufnagel, Bischoff, Behl, Roesch, Frohling, Schmidt, Duchac, Nickel, Maly, Hilbert, Miller, Stousland, Derr, Mattson. Total 25.

**Noes:** M. Bobholz, Uttke, Houchin. Total 3.

**Abstain:** Miller. Total 1.

**Absent:** J. Bobholz, Gohr, Caine. Total 3.

Chairman Kottke noted that at the June 2016 meeting, the Executive Director of the County's insurance company will be giving a presentation regarding the County's liability insurance.

At this time, Chairman Kottke called upon Julie Kolp, Finance Director and Ruth Otto, Information Technology Director, who distributed an informational document titled "Overview – Dodge County Enterprise Resource Planning (ERP)" dated February 17, 2016. Ms. Kolp and Ms. Otto gave a short explanation of the document and the mission statement of the Government Finance Officers Association (GFOA) was read. It was noted that there will be three upcoming meetings for County Board members to consider attending; the Executive Committee Meeting on March 7, 2016 at 1:00 p.m., the Finance Committee Meeting on March 8, 2016 at 8:00 a.m. and the Information Technology Committee Meeting on March 8, 2016 at 5:30 p.m. The document should be brought back to the March 15, 2016, County Board meeting and Ms. Kolp and Ms. Otto encouraged board member to direct any questions regarding the ERP to them.

The Clerk noted the following had been placed on the Supervisor's desks: 2015 Land Conservation Department Annual Report, Dodge County Law Enforcement Newsletter (LENS), a memorandum regarding the Community Development Block Grant from Nate Olson, Senior Planner with the Land Resources and Parks Department, a memorandum regarding Cisco maintenance from Ruth Otto, Information Technology Director, and the Aging and Disability Resource Center Newsletter. The Chairman ordered these be placed on file.

At 8:37 p.m. Supervisor Maly made a motion to recess until Tuesday, March 15, 2016 at 7:00 p.m. Supervisor Schraufnagel seconded the motion. The motion passed by acclamation, with no negative votes cast, and was so ordered by the Chairman.

**Disclaimer:** The above minutes may be approved, amended or corrected at the next meeting.

RESOLUTION NO. 15-70

TO THE HONORABLE BOARD OF SUPERVISORS OF DODGE COUNTY, WISCONSIN MEMBERS,

**WHEREAS**, the Dodge County Human Resources and Labor Negotiations Committee (the Committee) has studied and analyzed the current Dodge County Compensation Plan, also known as the Dodge County labor grade structure; and,

**WHEREAS**, as a result of this study and analysis, the Committee is concerned about the continuing market competitiveness and the internal and external consistency of the Dodge County labor grade structure, and has formed the considered conclusion that it is necessary to engage a compensation consultant to provide compensation consulting services to study and analyze the Dodge County labor grade structure, and to make and submit a written report, including recommendations, to the Committee; and,

**WHEREAS**, the Committee has received a proposal from Carlson Dettmann Consulting, LLC, 6733 Frank Lloyd Wright Avenue, Middleton, Wisconsin (Carlson Dettmann), a compensation consultant, to provide compensation consulting services to study and analyze the Dodge County labor grade structure, and make and submit a written report, including recommendations, to the Committee, at a total cost not to exceed \$17,500, (the Carlson Dettmann proposal); and,

**WHEREAS**, a copy of the Carlson Dettmann proposal has been marked for identification as Exhibit "A" and has been attached hereto; and,

**WHEREAS**, the Committee has reviewed and considered the Carlson Dettmann proposal, and has formed the considered conclusion that it is in the best interests of Dodge County to accept the Carlson Dettmann proposal; and,

**WHEREAS**, no funds have been budgeted in the 2016 Dodge County Budget to pay for the compensation consulting services as set forth in the Carlson Dettmann proposal; and,

**WHEREAS**, there are funds in the amount of \$17,500 in the 2015 Budget for the Dodge County Human Resources Department, in various wages and fringe benefits object expenditure accounts in Business Unit 901 and Business Unit 921, available for carryover to the 2016 Budget for the Human Resources Department and available for transfer to Business Unit 901, Human Resources, Account No. .5219.0901, Compensation Assessment Services, and sufficient to pay for the purchase of compensation consulting services as set forth in the Carlson Dettmann proposal; and,

**WHEREAS**, the Committee recommends to the Dodge County Board of Supervisors that the Dodge County Board of Supervisors:

1. Authorize and approve the purchase of the compensation consulting services as set forth in the Carlson Dettmann proposal;
2. Authorize and direct the Chairman of the Dodge County Board of Supervisors, the Dodge County Clerk, and the Dodge County Corporation Counsel to execute those documents

that are necessary to complete the purchase of compensation consulting services as set forth in the Carlson Dettmann proposal; and,

3. Authorize and direct the Dodge County Finance Director to carry over funds in the amount of \$17,500 in the 2015 Budget for the Dodge County Human Resources Department, in various wages and fringe benefits object expenditure accounts in Business Unit 901 and Business Unit 921, to the 2016 Budget for the Human Resources Department, and transfer these funds in the amount of \$17,500 to Business Unit 901, Human Resources, Account No. .5219.0901, Compensation Assessment Services, to be used to pay for the purchase of compensation consulting services as set forth in the Carlson Dettmann proposal;

**SO, NOW, THEREFORE, BE IT RESOLVED**, that the Dodge County Board of Supervisors hereby:

1. Authorizes and approves the purchase of compensation consulting services from Carlson Dettmann Consulting, LLC, 6733 Frank Lloyd Wright Avenue, Middleton, Wisconsin (Carlson Dettmann), at a total cost not to exceed \$17,500, to study and analyze the current Dodge County Compensation Plan, also known as the Dodge County labor grade structure, and to make and submit a written report, including recommendations, to the Dodge County Human Resources and Labor Negotiations Committee (the Committee), as set forth in a proposal that the Committee has received from Carlson Dettmann (the Carlson Dettmann proposal), a copy of which Carlson Dettmann proposal has been marked for identification as Exhibit "A", and has been attached hereto;
2. Authorizes and directs the Chairman of the Dodge County Board of Supervisors, the Dodge County Clerk, and the Dodge County Corporation Counsel to execute those documents that are necessary to complete the purchase of compensation consulting services as set forth in the Carlson Dettmann proposal; and,
3. Authorizes and directs the Dodge County Finance Director to carry over funds in the amount of \$17,500 in the 2015 Budget for the Dodge County Human Resources Department, in various wages and fringe benefits object expenditure accounts in Business Unit 901 and Business Unit 921, to the 2016 Budget for the Human Resources Department, and transfer these funds in the amount of \$17,500 to Business Unit 901, Human Resources, Account No. .5219.0901, Compensation Assessment Services, to be used to pay for the purchase of compensation consulting services as set forth in the Carlson Dettmann proposal; and,

**BE IT FINALLY RESOLVED**, that upon presentation to the Dodge County Clerk of invoices properly approved by the Dodge County Finance Director, in a total amount not to exceed \$17,500, representing the purchase of compensation consulting services from Carlson Dettmann, as set forth in the Carlson Dettmann proposal, the County Clerk is hereby authorized to draw orders upon the Dodge County Treasurer for payment of such invoices, and that funds for payment of such invoices shall be taken from Business Unit 901, Human Resources, Account No. .5219.0901, Compensation Assessment Services.

All of which is respectfully submitted this 17th day of February, 2016.

**Dodge County Human Resources and Labor Negotiations Committee:**

*Joseph Marsik*  
Joseph Marsik

*Jeffry Duchac*  
Jeffry Duchac

*David Frohling*  
David Frohling

*Dennis Schmidt*  
Dennis Schmidt

*Richard Greshay*  
Richard Greshay

**FISCAL NOTE:**

Is the referenced expenditure included in the adopted 2016 Budget? \_\_\_\_\_ Yes or X No

Fiscal Impact on the adopted 2016 Budget:  
\$ 17,500

Fiscal Impact reviewed by the Dodge County Finance Committee on 2/9, 2016.

*David Frohling*  
David Frohling, Chairman  
Dodge County Finance Committee

ADOPTED  
BY DODGE COUNTY BOARD

FEB 17 2016

AYES 27 NOES 2  
ABSENT 3  
ABSTAIN 0

*Karen J. Peterson*  
County Clerk

**PROFESSIONAL SERVICE AGREEMENT  
BETWEEN  
THE COUNTY OF DODGE, WI  
AND  
CARLSON DETTMANN CONSULTING, LLC**

This professional service agreement (hereinafter the "Agreement") is made and entered into by and between Dodge County, WI (hereinafter "the County") and Carlson Dettmann Consulting, LLC, a Wisconsin limited-liability company (hereinafter "Consultant").

**WHEREAS**, Consultant assisted the County in developing its current pay plan; and

**WHEREAS**, labor markets in the region have changed substantially, and the County is concerned about continuing market competitiveness; and

**WHEREAS**, the County wishes to enter into an agreement with Consultant to provide professional consulting services for market measurement and pay plan management services.

**THEREFORE**, the County and Consultant agree to the following:

1. Term. The term of this Agreement shall be from date of signing until terminated by the County or the Consultant. The parties agree that, barring any unforeseen circumstances, the Consultant's findings and recommendations will be delivered to the County on or before July 1, 2016.
2. Scope of Services. The Consultant shall provide to the County consulting services as follows:
  - a) Market study update. Consultant will measure labor markets for the County using the benchmark jobs and public sector organizations measured in the most recent study, as well as an expanded list of market matches so that the County can make the most appropriate choice on its market comparisons.
  - b) Consultant will include data that reflect private sector benchmarks from its data library for those jobs that it can match. All data will be provided in summary form.
  - c) Consultant will review turnover, current hiring practices and internal policy controls on recruitment and recommend policy adjustments as appropriate.
  - d) Consultant will provide a revised pay plan structure based upon the market study.
  - e) Consultant will conduct job evaluation reviews as requested by the County for positions it concludes have experienced a substantial change in duties since the most recent pay study and recommend pay plan placement.
3. Fees. The County shall pay the Consultant at the following rates for services agreed upon:
  - a) Base Project Fee. Excepting 3. b) below, the professional fee for the market review portion of the project shall be performed at a cost not-to-exceed \$17,500, and includes:
    - i) The review of revised or new documentation for up to 25 jobs.
    - ii) Onsite meetings to include:
      - (1) An initial meeting with the County to ascertain issues, concerns, and to properly identify the data requirements of the project; and
      - (2) Meetings, to be scheduled over the course of two (2) days, with the County's department heads to discuss matters relating to the scope of this project; and

- (3) Up to two (2) committee meetings to discuss the status of the project and/or review the findings of the project; and
- (4) Up to two (2) meetings with the County Board of Supervisors to review the findings of the project and/or aide with the adoption of said project.

b) Additional Fees:

- i) Consultant services agreed upon that are greater than the scope of this Agreement (e.g. consulting on merit pay allocation alternatives; onsite meetings in excess of those defined above; etc.) shall be at Consultant's normal rates unless agreed upon otherwise by the County and Consultant. However, subject to scheduling and mutual agreement, meetings conducted by telephone and/or web conference are not subject to any additional fee.
  - ii) Jobs submitted to Consultant for job evaluation in excess of 25 shall be charged at \$250 per evaluation.
  - iii) For meetings in excess of those defined above, the County will reimburse Consultant for travel time and "out-of-pocket" expenses for mileage, meals, or lodging.
4. Performance Requirements of Consultant. The Consultant shall complete the services as stated above. The Consultant shall furnish all labor, materials, administration, services, supplies, equipment, transportation, and quality control necessary to provide professional consulting services. Consultant shall provide progress reports upon request by the County.
  5. Performance Requirements of County. The County shall provide and make available to the Consultant access to its human resources and related systems of record as necessary to fulfill said services.
  6. Independent Contractor. It is mutually understood and agreed, and it is the intent of the parties hereto, that an independent contractor relationship be and is hereby established under the terms and conditions of this Agreement. The Consultant shall remain an independent contractor under this Agreement. All employees of Consultant or subcontractors shall remain the responsibility of the Consultant and shall not become employees of the County under this Agreement. No tenure or any rights or benefits, including worker's compensation, unemployment insurance, medical care, sick leave, vacation leave, severance pay, withholding taxes or other benefits available to County employees shall accrue to the Consultant or its employees performing services under this Agreement.
  7. Indemnification. The Consultant agrees it shall defend, indemnify, and hold harmless the County, its officers, and its employees against any and all liability, losses, costs, damages, and expenses, including attorney fees that the County, its officers or its employees, may hereafter sustain, incur or be required to pay arising out of the negligent or intentional acts or omissions of the Consultant, its officers or employees. The County agrees it shall defend, indemnify, and hold harmless the Consultant, its officers, and its employees against any and all liability, losses, costs, damages, and expenses, including attorney fees that the Consultant, its officers or its employees, may hereafter sustain, incur or be required to pay arising out of the negligent or intentional acts or omissions of the County, its officers or employees.
  8. Trade Secrets. The Carlson Dettmann Point Factor Job Evaluation System and methodology, marketplace surveys performed, Total Rewards Management System, and job point evaluation data collected and analyzed to perform the Scope of Services is owned by Consultant, is confidential and proprietary, and is a trade secret pursuant to Wis. Stats. s. 134.90. Client

(including its officers, employees, agents and representatives) shall not disclose, disseminate, or otherwise misappropriate these trade secrets without the express consent of Consultant.

9. Applicable Law. This Agreement shall be governed by and construed in accordance with the laws of the State of Wisconsin in effect on the date of this Agreement.
10. Assignment. Neither party to this Agreement may assign or transfer this Agreement, or any part thereof, without the written consent of the other party.
11. Severability. If any provision of this Agreement is held to be illegal, invalid or unenforceable, such provision shall be fully severable and this Agreement shall be construed and enforced as if such illegal, invalid or unenforceable provision had never comprised a part of the Agreement. The remaining provisions shall remain in full force and effect and shall not be affected by the illegal, invalid or unenforceable provision or by its severance.
12. Binding Effect. This Agreement shall extend to and be binding upon and inure to the benefit of the parties.
13. Entire Agreement. This Agreement sets forth the entire understanding of the parties and supersedes all prior arrangements and/or understandings, whether written or oral, with respect to the subject matter contained in this Agreement. No terms, conditions, warranties, other than those contained herein, and no amendments or modifications hereto shall be binding unless made in writing and signed by the County and the Consultant.

**DODGE COUNTY, WI**

By:

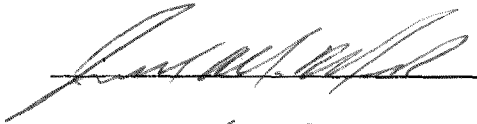

Date:

1/18/2016

**CARLSON DETTMANN CONSULTING, LLC**

By:

---

Charles E. Carlson, Partner

Date:

RESOLUTION NO. 15-71

TO THE HONORABLE BOARD OF SUPERVISORS OF DODGE COUNTY, WISCONSIN MEMBERS,

**WHEREAS**, the Dodge County Information Technology Committee (Committee) has determined that it is necessary to purchase computer software and support services for the purposes of supporting the Dodge County computer system backbone and the Voice Over Internet Protocol telephone system; and,

**WHEREAS**, the Committee has received a proposal, dated December 4, 2015, from Meridian IT Inc., 9 Parkway North, Deerfield, Illinois (Meridian IT Inc.), for the purchase of computer software and support services at a purchase price of \$420,616.85 (the Meridian proposal); and,

**WHEREAS**, copies of the Meridian proposal documents are on file in the Office of the Dodge County Clerk and may be reviewed there during normal business hours; and,

**WHEREAS**, the purchase option is a Master Installment Payment Agreement - Software and/or Support Only (No Hardware) (Master Installment Payment Agreement) with zero percent financing, to be entered into by and between Dodge County, Wisconsin, and Cisco Systems Capital Corporation (Cisco), and the payment structure is one payment equal to \$140,205.62, due at the signing of the Master Installment Payment Agreement, which signing is reasonably anticipated to occur on or about February 18, 2016, followed by a payment equal to \$140,205.62, due on or about January 1, 2017, and followed by a payment equal to \$140,205.61, due on or about January 1, 2018; and,

**WHEREAS**, pursuant to the terms and conditions of the Master Installment Payment Agreement:

1. Dodge County will grant to Cisco a first priority security interest in the computer software, and, to the extent legally available, in the support services;
2. The Master Installment Payment Agreement will terminate after Dodge County has timely made the first payment, the second payment, and the third payment;
3. Thereafter, Cisco will terminate its security interest in the computer software and its security interest, if any, in the support services; and,
4. Dodge County will then own the computer software and support services free and clear of the security interest of Cisco; and,

**WHEREAS**, the Dodge County Board of Supervisors has appropriated funds in the 2016 Dodge County Budget in the amount of \$140,205.62 in Business Unit 1811, Desktop and Network Infrastructure, Account No. .5249, Software Maintenance, which are now available, to make the first payment in the amount of \$140,205.62; and,



**WHEREAS**, it is reasonably anticipated that the Dodge County Board of Supervisors will appropriate funds in the 2017 Dodge County Budget, in the amount of \$140,205.62, in order that funds will be available to make the second payment in January of 2017, and it is reasonably anticipated that the Dodge County Board of Supervisors will appropriate funds in the 2018 Dodge County Budget, in the amount of \$140,205.61, in order that funds will be available to make the third payment in January of 2018; and,

**WHEREAS**, the Committee recommends that the Dodge County Board of Supervisors approve and accept the Meridian proposal; and,

**WHEREAS**, the Committee recommends that the Dodge County Board of Supervisors authorize and direct the Dodge County Director of Information Technology and the Dodge County Clerk to execute, on behalf of Dodge County, all documents necessary to complete the purchase of computer software and support services as set forth in the Meridian proposal;

**SO, NOW, THEREFORE, BE IT RESOLVED**, that the Dodge County Board of Supervisors hereby authorizes and approves the purchase by the Information Technology Committee of computer software, and support services as set forth in a proposal, dated December 4, 2015, submitted by Meridian IT Inc., 9 Parkway North, Deerfield, Illinois, at a purchase price of \$420,616.85 (the Meridian proposal); and,

**BE IT FURTHER RESOLVED**, that the Dodge County Board of Supervisors hereby authorizes and directs the Dodge County Director of Information Technology and the Dodge County Clerk to execute, on behalf of Dodge County, all documents necessary to complete the purchase of computer software and support services as set forth in the Meridian proposal; and,

**BE IT FINALLY RESOLVED**, that upon presentation to the Dodge County Clerk in January of 2016, of an invoice properly approved by the Dodge County Director of Information Technology in the amount of \$140,205.62, representing the first payment for the purchase of computer software and support services as set forth in the Meridian proposal, the County Clerk is hereby authorized and directed to draw an order upon the Dodge County Treasurer for payment of such invoice, and that funds in the amount of \$140,205.62, for payment of such invoice, shall be taken from Business Unit 1811, Desktop and Network Infrastructure, Account No. .5249, Software Maintenance.

All of which is respectfully submitted this 17th day of February, 2016.

**Dodge County Information Technology Committee:**

  
\_\_\_\_\_  
Donna Maly

  
\_\_\_\_\_  
Mary J. Bobholz

  
\_\_\_\_\_  
Jeffry Duchae

\_\_\_\_\_  
Janice K. Bobholz

\_\_\_\_\_  
James Houchin

Information Technology Committee

**FISCAL NOTE:**

Is the referenced expenditure included in the adopted 2016 Budget?   X   Yes or        No

Fiscal Impact on the adopted 2016 Budget:

\$       0      

Fiscal Impact reviewed by the Dodge County Finance Committee on   2/9  , ~~2015~~   2016  

David Frohling  
David Frohling, Chairman  
Dodge County Finance Committee

ADOPTED  
BY DODGE COUNTY BOARD

FEB 17 2016

AYES   29   NOES   0    
ABSENT   3    
ABSTAIN   0  

Karen J. Gibson  
County Clerk

RESOLUTION NO. 15-72

TO THE HONORABLE BOARD OF SUPERVISORS OF DODGE COUNTY, WISCONSIN MEMBERS:

**WHEREAS**, Section 59.22(1)(a) of the *Wisconsin Statutes*, 2013-14, requires that before the earliest time for filing nomination papers for any elective office to be voted on in the County, which officer is paid in whole or part from the County Treasury, the County Board of Supervisors shall establish the total annual compensation for services to be paid to such officer (exclusive of reimbursement for expenses out of pocket); and,

**WHEREAS**, such compensation for Dodge County elected officials must be established by the Dodge County Board of Supervisors by April 15, 2016, for the 2017-2020 term for the elective offices of County Clerk, County Treasurer, and Register of Deeds; and,

**WHEREAS**, total annual compensation for the 2013-2016 term for the elective offices of County Clerk, County Treasurer, and Register of Deeds was established by the Dodge County Board of Supervisors on February 21, 2012, by Resolution No. 11-67; and,

**WHEREAS**, the undersigned Committee is responsible for recommending to the Dodge County Board of Supervisors the annual compensation to be established for such Dodge County elected officials; and,

**WHEREAS**, the undersigned Committee has taken into consideration external comparables by comparing the current compensation and duties and responsibilities of each of these positions in relation to the salaries paid to elected officials in other counties in comparison to their duties and responsibilities, and to internal comparables by reviewing the labor grade salary structure for Dodge County department heads and non-represented employees (see attached Exhibit "A", "B", and "C"); and,

**WHEREAS**, a comparison of the 2016 salaries for the elective offices of County Clerk, County Treasurer, and Register of Deeds to the 2016 labor grade salary structure for Dodge County department heads and non-represented employees shows these positions to be at salaries below department head positions with a similar scope of responsibilities (see attached Exhibit "A", "B", and "C"); and,

**WHEREAS**, it is the opinion of the undersigned Committee that the compensation for such elected officials shall be established on a basis of straight salary with no fees that are collected by the official's office being retained as part of the compensation to the elected official; and,

**WHEREAS**, it is the opinion of the undersigned Committee, after considering the comparisons to external and internal comparables, that the salaries for the elective offices of County Clerk, County Treasurer, and Register of Deeds should be established for each year of the 2017-2020- term of office, as follows:

	Current	New Term			
	<u>2016</u>	<u>2017</u>	<u>2018</u>	<u>2019</u>	<u>2020</u>
County Clerk	\$63,215	\$68,057	\$69,078	\$70,114	\$71,166
County Treasurer	\$63,215	\$68,057	\$69,078	\$70,114	\$71,166
Register of Deeds	\$63,215	\$68,057	\$69,078	\$70,114	\$71,166

**SO, NOW, THEREFORE, BE IT RESOLVED**, that the Dodge County Board of Supervisors hereby establishes the following salaries for elected officials for the elective term beginning the first Monday in January of 2017, and continuing until the first Monday in January of 2021:

	Current		New Term		
	<u>2016</u>	<u>2017</u>	<u>2018</u>	<u>2019</u>	<u>2020</u>
County Clerk	\$63,215	\$68,057	\$69,078	\$70,114	\$71,166
County Treasurer	\$63,215	\$68,057	\$69,078	\$70,114	\$71,166
Register of Deeds	\$63,215	\$68,057	\$69,078	\$70,114	\$71,166

**BE IT FURTHER RESOLVED**, that the elected officials will be paid on each pay date an amount that is equal to their annual salary divided by the number of pay dates occurring within the respective term year (beginning on the first Monday of the calendar year and continuing until the first Monday of the next calendar year) except for the final pay date of the term year when the amount paid will be the balance of the total annual salary; and,

**BE IT FURTHER RESOLVED**, that the above-stated salaries shall be the entire compensation for services paid from the Dodge County Treasury to such elected officials (exclusive of reimbursement for expenses out of pocket) and any fees collected by or through the office of said elected officials shall be turned over to the Dodge County Treasurer and placed in the General Fund Account of Dodge County; and,

**BE IT FURTHER RESOLVED**, that persons holding the elective offices of County Clerk, County Treasurer, and Register of Deeds, will be responsible for paying the employee required contribution toward Wisconsin Retirement System benefits, which shall be done through payroll deduction; and,

**BE IT FINALLY RESOLVED**, that persons holding the elective offices of County Clerk, County Treasurer, and Register of Deeds, will be eligible to participate in the health insurance benefit, dental benefit, and life insurance benefit offered to Dodge County department heads at the rates and terms and in a manner consistent with Dodge County's policies and procedures.

All of which is respectfully submitted this 17th day of February, 2016.

**Dodge County Human Resources and Labor Negotiations Committee:**

  
Joseph Marsik

  
Jeffrey Duchac

  
Dave Frohling

  
Dennis Schmidt

  
Richard Greshay

ADOPTED  
BY DODGE COUNTY BOARD

FEB 17 2016

AYES 29 NOES 0  
ABSENT 3  
ABSTAIN 0

  
Karen J. Gibson  
County Clerk

## ELECTED OFFICIALS 2016 Dodge County

2016	\$63,215	\$30.39	
<b>CARLSON DETTMAN STUDY COUNTIES</b>		<b>REGISTER OF</b>	<b>COUNTY</b>
<b>2016 SALARIES</b>	<b>TREASURER</b>	<b>DEEDS</b>	<b>CLERK</b>
Washington	\$68,663	\$68,663	\$68,663
Jefferson	\$64,022	\$62,628	\$73,115
Fond du Lac	\$70,074	\$70,074	\$71,690
Sheboygan	\$63,615	\$63,416	\$64,952
Rock	\$73,511	\$73,510	\$73,510
Columbia	\$76,413	\$72,677	\$72,677
Walworth	\$68,682	\$68,682	\$68,682
Manitowoc	\$63,125	\$63,127	\$63,127
Calumet	\$61,217	\$61,217	\$61,824
Waupaca	\$67,810	\$68,074	\$67,815
Sauk	\$66,892	\$60,759	\$66,892
Portage	\$64,175	\$64,175	\$65,486
<b>AVERAGE SALARY 2016</b>	<b>\$67,350</b>	<b>\$66,417</b>	<b>\$68,203</b>
<b>AVERAGE HOURLY WAGE</b>	<b>\$32.38</b>	<b>\$31.93</b>	<b>\$32.79</b>
Wage Falls in Labor Grade 11	Step 3-4	Step 3-4	Step 4-5
<b>DODGE</b>	<b>\$63,215</b>	<b>\$63,215</b>	<b>\$63,215</b>
	<b>\$30.39</b>	<b>\$30.39</b>	<b>\$30.39</b>
Wage Falls in Labor Grade 11	Step 1-2	Step 1-2	Step 1-2
Dodge Less than Comparable Counties Used in 2016	-5.9%	-5.1%	-7.9%



County Clerk, County Treasurer, Register of Deeds History

<b>County Board Resolution 08-09 (April 15, 2008)</b>						
	Current	2009	2010	2011	2012	January 5, 2009 Through January 7, 2013
County Clerk	\$53,500.00	\$55,105.00 3.0%	\$56,758.00 3.0%	\$58,461.00 3%	\$60,215.00 3.0%	
County Treasurer	\$53,500.00	\$55,105.00 3.0%	\$56,758.00 3.0%	\$58,461.00 3%	\$60,215.00 3.0%	
Register of Deeds	\$53,500.00	\$55,105.00 3.0%	\$56,758.00 3.0%	\$58,461.00 3%	\$60,215.00 3.0%	

<b>County Board Resolution 11-67 (February 21, 2012)</b>						
	Current	2013	2014	2015	2016	January 7, 2013 Through January 2, 2017
County Clerk	\$60,215.00	\$60,965.00 1.2%	\$61,715.00 1.2%	\$62,465.00 1.2%	\$63,215.00 1.2%	
County Treasurer	\$60,215.00	\$60,965.00 1.2%	\$61,715.00 1.2%	\$62,465.00 1.2%	\$63,215.00 1.2%	
Register of Deeds	\$60,215.00	\$60,965.00 1.2%	\$61,715.00 1.2%	\$62,465.00 1.2%	\$63,215.00 1.2%	

<b>County Board Resolution 16-__ (February 17, 2016)</b>						
	Current	2017	2018	2019	2020	January 2, 2017 Through January 6, 2021
County Clerk	\$63,215.00	\$68,058.00 7.66%	\$69,079.00 1.5%	\$70,115.00 1.5%	\$71,167.00 1.5%	
County Treasurer	\$63,215.00	\$68,058.00 7.66%	\$69,079.00 1.5%	\$70,115.00 1.5%	\$71,167.00 1.5%	
Register of Deeds	\$63,215.00	\$68,058.00 7.66%	\$69,079.00 1.5%	\$70,115.00 1.5%	\$71,167.00 1.5%	

RESOLUTION NO. 15-73

TO THE HONORABLE BOARD OF SUPERVISORS OF DODGE COUNTY, WISCONSIN MEMBERS,

**WHEREAS**, on November 13, 1990, the Dodge County Board of Supervisors adopted Resolution No. 90-64 and Resolution No. 90-65, and thereby created a Dodge County Hazardous Response Unit, which has developed into the Dodge County Hazardous Materials Response Team, also known as the Dodge County HAZMAT Team (HAZMAT Team); and,

**WHEREAS**, the HAZMAT Team is a county-wide responder team, consisting of approximately 30 specially-trained responders from communities throughout Dodge County; and,

**WHEREAS**, since November 13, 1990, up to the present time, due to increasingly higher-level standards for hazardous materials response agencies, HAZMAT Team members have become subject to more extensive and intensive regulation, including increases in the number of regulations pertaining to qualification and training; and,

**WHEREAS**, at the present time, HAZMAT Team members attend and participate in an average of 24 hours of training each year, in order to remain proficient in their hazardous materials response knowledge and skills, and in order to increase their hazardous materials response knowledge and skills; and,

**WHEREAS**, due to increases in qualification and training requirements for HAZMAT Team members, and the need for Dodge County to retain these specially trained, skilled, knowledgeable, and dedicated HAZMAT Team members, funds in the amount of \$3,000 were included in the 2016 Emergency Management Department Budget to be used in 2016 to pay a stipend in the amount of \$100 to each of the 30 HAZMAT Team members; and,

**WHEREAS**, in the past, HAZMAT Team members were considered independent contractors, rather than Dodge County employees, with the result that HAZMAT Team members were paid only for deployments, and not for training hours; and,

**WHEREAS**, recently, the Dodge County Director of Human Resources determined that current Internal Revenue Service rules and regulations require that HAZMAT Team members be classified as Dodge County employees, rather than as independent contractors; and,

**WHEREAS**, the Dodge County Executive Committee has formed the considered conclusion that 30 new, non-benefited, occasional part-time, miscellaneous, positions of *Hazardous Materials Responder*, in the Emergency Management Department, should be created, effective immediately; and,

**WHEREAS**, a DRAFT job description for the proposed position of *Hazardous Materials Responder* has been marked for identification as Exhibit "A", and has been attached hereto; and,

**WHEREAS**, due to the change in status of HAZMAT Team members, from independent contractors to Dodge County employees, additional funds are needed in the 2016 Emergency Management Department Budget to pay for wages, payroll taxes, drug testing, and reimbursement of mileage for miles traveled to and from deployments, for the proposed positions of *Hazardous Materials Responder* for the period of time commencing on February 17, 2016, and ending on December 31, 2016, both inclusive; and,

**WHEREAS**, there are funds in Business Unit 1390, Contingent Appropriation, in the amount of \$4,994, available for transfer and sufficient to pay for wages, payroll taxes, drug testing, and reimbursement of mileage for miles traveled to and from deployments, for the proposed positions of *Hazardous Materials*



Responder during the period of time commencing on February 17, 2016, and ending on December 31, 2016, both inclusive;

SO, NOW, THEREFORE, BE IT RESOLVED, that the Dodge County Board of Supervisors hereby creates 30 new, non-benefited, occasional part-time, miscellaneous, positions of Hazardous Materials Responder in the Dodge County Emergency Management Department, effective February 17, 2016; and,

BE IT FINALLY RESOLVED, that the Dodge County Finance Director is hereby authorized and directed to transfer funds in the amount of \$4,994 from Business Unit 1390, Contingent Appropriation, to various wages and fringe benefits object expenditure accounts and to other object expenditure accounts, as required, in Business Unit 2825, HAZMAT, to be used to pay for wages, payroll taxes, drug testing, and reimbursement of mileage for miles traveled to and from deployments, for the 30 newly-created positions of Hazardous Materials Responder during the period of time commencing on February 17, 2016, and ending on December 31, 2016, both inclusive.

All of which is respectfully submitted this 17th day of February, 2016.

Dodge County Executive Committee:

Russell Kottke  
Russell Kottke

Harold Johnson  
Harold Johnson

Donna Maly  
Donna Maly

Joseph M. Marsik  
Joseph M. Marsik

MaryAnn Miller  
MaryAnn Miller

Jeff Berres  
Jeff Berres

David Frohling  
David Frohling

FISCAL NOTE:

Is the referenced expenditure included in the adopted 2016 Budget? \_\_\_\_\_ Yes or X No

Fiscal Impact on the adopted 2016 Budget:  
\$ 4994

Fiscal Impact reviewed by the Dodge County Finance Committee on 2/9, 2016.

David Frohling, Chairman  
Dodge County Finance Committee

ADOPTED  
BY DODGE COUNTY BOARD

FEB 17 2016

AYES 29 NOES 0  
ABSENT 3  
ABSTAIN 0

Raren J. Gibson  
County Clerk

## DODGE COUNTY JOB DESCRIPTION

Current Wages: \$7.25/hr Trainings/Meetings; \$35/hr HazMat Call out

<b>JOB TITLE:</b>	Hazardous Materials Responder	<b>FLSA STATUS:</b>	Non-exempt
<b>DEPARTMENT:</b>	Emergency Management	<b>REPORTS TO:</b>	Emergency Management Director
<b>LOCATION:</b>	Law Enforcement Building	<b>DATE:</b>	DRAFT
<b>LABOR GRADE:</b>	Non-Union Miscellaneous	<b>REVISED:</b>	

**OVERALL PURPOSE/SUMMARY**

Under the general Direction of the Emergency Management Director, serves as a resource to Dodge County response agencies in protecting the citizens by providing specialized equipment, training, and personnel for Hazardous Materials Response in order to contain, confine, and mitigate a hazardous material spill or leak. Operates under regulations CFR 29, CFR 40, and CFR 49, and Wisconsin Statue 323 under the supervision of the Emergency Management Director.

**PRINCIPAL DUTIES AND RESPONSIBILITIES**

1. Responds to chemical emergencies occurring in Dodge County as the result of a spill, leak, release, fire, uncontrolled reaction, abandoned receptacles, and/or mishandling of material(s) as requested by the local Incident Commander through Dodge County Central Communications.
2. Reports to scene/staging area, determined by the Incident Commander or Emergency Management.
3. Coordinates efforts with other agencies to mitigate the situation.
4. Employs the use of the Incident Command System (ICS) as defined by the National Incident Management System (NIMS).
5. Assists Incident Commander and Team Coordinator in assessing hazardous or potentially hazardous conditions and rapidly identifies the immediate hazards that may affect the public, response personnel, and the environment including: contamination, weather observations, referencing of materials, hazmat control zones, evacuation, air sampling, containment, and Incident Action Plan (IAP).
6. Utilizes proper protective equipment in accordance to incident level criteria.
7. Follows contamination control procedures to minimize the transfer of hazardous substances from the scene by establishing control zones and decontaminating people and equipment.
8. Implements Incident Action Plan (IAP) by providing support to the Incident Commander or designee in one or more of the following roles: Team Coordinator (HazMat Group Supervisor), Platoon Officer, HAZMAT Safety Officer, and/or Team member.
  - a) Team Coordinator (HazMat Group Supervisor):
    - i. Reports to Incident Commander.
    - ii. Organizes, assigns, and responsible overall HAZMAT operations during deployments.
    - iii. Provides incident documentation.
    - iv. Recommends equipment needs and budget requests.
  - b) Platoon Officer:
    - i. Reports to HazMat Group Supervisor.
    - ii. Assumes the duties of the HAZMAT Team Coordinator in his/her absence.
    - iii. Sets up, initiates, conducts, and documents all training exercises.
    - iv. Maintains equipment, inventory and record keeping including: equipment manuals, inventory records, warranty data, safety inspection records, replacement needs, and equipment acquisition.
    - v. Maintains a safety inspection record of the HAZMAT Team vehicle.
  - c) HAZMAT Safety Officer:
    - i. Assists incident command and the HAZMAT team to assure a safe response and to ensure proper mitigation.
    - ii. Monitors and assesses HAZMAT operations for safety compliance. Mitigates unsafe situations and develops measures to assure personnel safety, which may include: recommending levels of protection, monitoring safety conditions, implementing on-site safety and health plan, and monitoring physical health of the team members during operations.
    - iii. Provides safety activities during training sessions.
    - iv. Authorizes to stop operations or activities due to unsafe or unstable conditions.
  - d) Team Members:
    - i. Reports to Platoon Officer
    - ii. Performs duties, as assigned, to an entry team to assist with assessing degree of hazard, identifying products, identifying containment needs, and performing necessary actions to mitigate the incident as identified in the Incident Action Plan.
    - iii. Performs duties, as assigned, to a rescue team to remain on standby outside the contaminated area and in an emergency, assists the entry team.
    - iv. Performs duties, as assigned, as reference or recorder, to provide information and documentation to formulate the action plan.
    - v. Performs duties, as assigned, to Decontamination Leader to ensure proper decontamination procedures are followed to prevent the transmigration of contaminants.
    - i. Performs duties, as assigned, to Decontamination Zone Team Member to set up and operate the decontamination system for decontaminating personnel and equipment leaving the contaminated area.

9. Maintains confidentiality during and after deployments.
10. Attends training, meetings and conferences and maintains current knowledge of methods and procedures through professional literature, publications, internet, etc.
11. Follows all safety practices and regulations including Incident Safety Plan.
12. Regular attendance and punctuality required.
13. Performs related duties as may be required or assigned.

**JOB SPECIFICATION**

**KNOWLEDGE, SKILLS, AND ABILITIES**

Knowledge of National Incident Management System (NIMS) and Incident Command.  
 Knowledge of hazardous materials/contaminations classifications and their effects.  
 Knowledge of decontamination methods and procedures.  
 Knowledge of Emergency Planning and Community Right-to-Know (EPCRA)  
 Knowledge of State and Federal regulations including: CFR 29, CFR 40, and CFR 49, and Wisconsin Statue 323.  
 Knowledge of Atmospheric Hazard Guide.  
 Ability to utilize communication system including radios and standard hand signals.  
 Ability to determine the potential for contact with hazardous materials.  
 Ability to gather facts and data and draw logical conclusions from such data.  
 Ability to prepare accurate records and reports in accordance with State and County regulations.  
 Ability to establish and maintain effective relations and working relationships with local, State, and Federal response agencies.  
 Ability to exercise judgment, decisiveness and creativity required in situations involving directions, control, and planning of an entire program or multiple programs.  
 Ability to communicate effectively orally and in writing, and interact effectively with co-workers and the general public.  
 Must meet requirements of Dodge County Driver Qualification Program.  
 Must attend at least two (2) of the four (4) quarterly training meetings.  
 Must attend annual eight (8) hour refresher course.

**EDUCATION AND EXPERIENCE**

Must be trained at the Operations or Technician Level and possess a current certificate in compliance with 29 CFR 1910.120 (q), as referenced in Comm 30/NFPA 472, Chap 6.  
 Operations level team members shall successfully complete: ICS-700, ICS-100, and Hazardous Materials Operations Training (Operations Certificate required). Technical College Fire Service Training, preferred.  
 Technician level team members shall successfully complete: ICS-700, ICS-100, ICS-200, and Technician Training (Technician Certificate required). Certified Firefighter I, preferred.  
 Team Officers (Team Coordinator, Safety Officer, Platoon Officer) shall successfully complete: ICS-700, ICS-100, ICS-200, ICS-300, ICS-400, Technician Training (Technician Certificate required.) Certified Fire Fighter II and Certified Fire Officer I, preferred.  
 A combination of educations and experience that provides the necessary knowledge, skills and abilities may be considered. Must be at least 21 years of age. Must be able to communicate effectively using clear and concise language.  
 Valid Wisconsin Driver's license and access to reliable transportation required. Must be available twenty-four (24) hours a day, seven (7) days a week.

**WORKING CONDITIONS**

Works in extreme working conditions including exposure to hazardous materials and various environmental factors/weather conditions, including wearing protective equipment. Works in extreme temperatures (both high and low). The physical demand level for this job is medium to heavy. Must lift and carry objects up to approximately 50 pounds without assistance. Must stand, sit and walk for long periods and at times on uneven terrain. Must use near and far vision. Must constantly hear. Must use hand-eye coordination.

**PHYSICAL DEMANDS**

The County of Dodge is an Equal Opportunity Employer. In compliance with the Americans with Disabilities Act, the County will provide reasonable accommodations to qualified individuals with disabilities and encourages both prospective and current employees to discuss potential accommodations with the employer.

**ACKNOWLEDGEMENTS**

EMPLOYEE SIGNATURE:  
 DATE:  
 SUPERVISOR SIGNATURE:  
 DATE:

**FOR HUMAN RESOURCE USE**

ANALYST(S):  
 DATE:

The principal duties and responsibilities shown are all essential job functions except for those indicated with an asterisk (\*).

THIS POSITION DESCRIPTION SUPERSEDES ALL PRIOR DESCRIPTIONS.

RESOLUTION NO. 15-74

TO THE HONORABLE BOARD OF SUPERVISORS OF DODGE COUNTY, WISCONSIN MEMBERS,

**WHEREAS**, the Dodge County Executive Committee has considered the radio communications equipment needs of Dodge County and has determined that it is necessary to undertake and complete Phase III of the Simulcast Expansion of the existing Dodge County fire radio communications channel, known as DOFIRE1 (Simulcast Phase III project); and,

**WHEREAS**, upon completion of the Simulcast Phase III project, all radio communications messages on the existing Dodge County fire radio communications channel, known as DOFIRE1 will be broadcast simultaneously from all nine of the Dodge County Central Communications tower sites; and,

**WHEREAS**, the Simulcast Phase III project will consist of the purchase of new radio communications equipment and the installation and optimization of performance of that radio communications equipment at the following Dodge County Central Communications tower sites: Juneau Highway Shop Tower; St. Helena Tower; Mayville Water Tower; Knowles Tower; Rubicon Tower; Ashippun Tower; Reeseville Water Tower; Beaver Dam Fire Department Tower; and, Fox Lake Tower; and,

**WHEREAS**, the Dodge County Emergency Management Department has solicited and received a price quotation for the Simulcast Phase III project, for the purchase of new radio communications equipment and professional services to install it and to optimize its performance, from Communications Service Wisconsin LLC of Portage, Wisconsin, in the amount of \$183,694, a copy of which price quotation is on file in the Office of the Dodge County Clerk and may be viewed there during normal business hours; and,

**WHEREAS**, the Dodge County Executive Committee has considered the radio communications equipment needs of Dodge County and has determined that it is necessary to undertake and complete additional optimization on the existing Dodge County interagency fire emergency radio network radio communications channel, known as IFERN (IFERN project); and,

**WHEREAS**, upon completion of the IFERN project, all radio communications messages on the existing Dodge County interagency fire emergency radio network radio communications channel, known as IFERN will be broadcast from the St. Helena Tower; and,

**WHEREAS**, the IFERN project will consist of moving the existing base station from the Juneau Tower to the St. Helena Tower and the purchase of new radio communications equipment and the installation and optimization of performance of that radio communications equipment at the St. Helena Tower; and,

**WHEREAS**, the Dodge County Emergency Management Department has solicited and received a price quotation for the IFERN project, for the purchase of new radio communications equipment and professional services to install it and to optimize its performance, from Communications Service Wisconsin LLC of Portage, Wisconsin, in the amount of \$9,883, a copy of which price quotation is on file in the Office of the Dodge County Clerk and may be viewed there during normal business hours; and,

**WHEREAS**, in reasonable anticipation of the receipt in late 2015 of Assistance to Firefighters Grant funds in the amount of \$236,000, from FEMA, by the Emergency Management Department, \$309,000 of County Sale and Use Tax Proceeds were appropriated to Business Unit 2801, Central Communications, Account No. .5819, Other Capital Equipment, in the 2016 Budget of the Emergency Management Department, \$59,000 of which was appropriated to pay for the required 20% Assistance to Firefighters Grant local match, and \$250,000 of which was appropriated to pay for the addition of Simulcasting capabilities for Dodge County Highway Channel 1, known as DOHWY1; and,

**WHEREAS**, because the Emergency Management Department did not receive any Assistance to Firefighters Grant funds from FEMA in 2015, and because a change was made in the priority of projects that Dodge County will fund in 2016, it is the considered conclusion of the Executive Committee that the remaining funds in the amount of \$115,423 (\$309,000 less \$183,694 and less \$9,883 equals \$115,423) that were appropriated to Business Unit 2801, Central Communications, Account No. .5819, Other Capital Equipment, in the 2016 Budget of the Emergency Management Department, should be reappropriated to Business Unit 100.3415, County Sale and Use Tax – Assigned General Fund; and,

**WHEREAS**, the Executive Committee recommends that the Dodge County Board of Supervisors:

1. Authorize and direct the Executive Committee to proceed forthwith to take all actions necessary to undertake and complete the Simulcast Phase III project;
2. Approve and accept the price quotation for the Simulcast Phase III project, for the purchase of new radio communications equipment and professional services to install it and to optimize its performance, from Communications Service Wisconsin LLC of Portage, Wisconsin, in the amount of \$183,694;
3. Authorize and direct the Executive Committee to proceed forthwith to take all actions necessary to undertake and complete the IFERN project;
4. Approve and accept the price quotation for the IFERN project, for the purchase of new radio communications equipment and professional services to install it and to optimize its performance, from Communications Service Wisconsin LLC of Portage, Wisconsin, in the amount of \$9,883;

5. Authorize and direct the Director of the Dodge County Emergency Management Department to execute on behalf of Dodge County, all documents necessary to complete the purchase of new radio communications equipment and professional services to install it and to optimize its performance as set forth in the price quotations for the Simulcast Phase III project and the IFERN project, submitted by Communications Service Wisconsin LLC of Portage, Wisconsin; and,
6. Reappropriate funds in the amount of \$115,423 from Business Unit 2801, Central Communications, Account No. .5819, Other Capital Equipment, in the 2016 Budget of the Emergency Management Department, to Business Unit 100.3415, County Sale and Use Tax – Assigned General Fund;

**SO, NOW, THEREFORE, BE IT RESOLVED**, that the Dodge County Board of Supervisors hereby:

1. Authorizes and directs the Executive Committee to proceed forthwith to take all actions necessary to undertake and complete the Simulcast Phase III project;
2. Approves and accepts the price quotation for the Simulcast Phase III project, for the purchase of new radio communications equipment and professional services to install it and to optimize its performance, from Communications Service Wisconsin LLC of Portage, Wisconsin, in the amount of \$183,694;
3. Authorizes and directs the Executive Committee to proceed forthwith to take all actions necessary to undertake and complete the IFERN project;
4. Approves and accepts the price quotation for the IFERN project, for the purchase of new radio communications equipment and professional services to install it and to optimize its performance, from Communications Service Wisconsin LLC of Portage, Wisconsin, in the amount of \$9,883;
5. Authorizes and directs the Director of the Dodge County Emergency Management Department to execute on behalf of Dodge County, all documents necessary to complete the purchase of new radio communications equipment and professional services to install it and to optimize its performance as set forth in the price quotations for the Simulcast Phase III project and the IFERN project, submitted by Communications Service Wisconsin LLC of Portage, Wisconsin; and,
6. Reappropriates funds in the amount of \$115,423 from Business Unit 2801, Central Communications, Account No. .5819, Other Capital Equipment, in the 2016 Budget of the Emergency Management Department, to Business Unit 100.3415, County Sale and Use Tax – Assigned General Fund; and,

**BE IT FINALLY RESOLVED**, that upon presentation to the Dodge County Clerk of invoices properly approved by the Director of the Emergency Management Department in a total amount not to exceed \$193,577 (\$183,694 plus \$9,883 equals \$193,577), representing the costs of the purchase of new radio communications equipment and professional services to install it and to optimize its performance, for the Simulcast Phase III project and the IFREN project, from Communications Service Wisconsin LLC, the County Clerk is authorized to issue orders upon the Dodge County Treasurer for payment of such invoices and that funds for payment of such invoices shall be taken from Business Unit 2801, Central Communications, Account No. .5819, Other Capital Equipment.

All of which is respectfully submitted this 17th day of February, 2016.

**Dodge County Executive Committee:**

Russell Kottke  
Russell Kottke

Harold Johnson  
Harold Johnson

Donna Maly  
Donna Maly

Joseph M. Marsik  
Joseph M. Marsik

Mary Ann Miller  
Mary Ann Miller

Jeff Berres  
Jeff Berres

David Frohling  
David Frohling

FISCAL NOTE:  
 Is the referenced expenditure included in the adopted 2016 Budget?  X  Yes or   No

Fiscal Impact on the adopted 2016 Budget:  
 \$  115423

Fiscal Impact reviewed by the Dodge County Finance Committee on  2/9 , 2016.

David Frohling  
 David Frohling, Chairman  
 Dodge County Finance Committee

ADOPTED  
BY DODGE COUNTY BOARD

FEB 17 2016

AYES	<u>29</u>	NOES	<u>0</u>
ABSENT	<u>3</u>		
ABSTAIN	<u>0</u>		

Raren J. Gibson  
County Clerk

RESOLUTION NO. 15-75

TO THE HONORABLE BOARD OF SUPERVISORS OF DODGE COUNTY, WISCONSIN MEMBERS,

**WHEREAS**, at the request of the Dodge County Executive Committee, the Dodge County Human Resources and Labor Negotiations Committee has studied and analyzed a proposal to place the Dodge County Administrator position (Administrator position) on the Dodge County Compensation Plan, also known as the Dodge County labor grade structure (labor grade structure); and,

**WHEREAS**, on November 9, 2015, the Dodge County Director of Human Resources sent a Job Description Questionnaire for the Administrator position to Carlson Dettmann Consulting, LLC, 6733 Frank Lloyd Wright Avenue, Middleton, Wisconsin (Carlson Dettmann); and,

**WHEREAS**, in response to the Job Description Questionnaire, Carlson Dettmann submitted a report to the Director of Human Resources regarding the proposal to place the Administrator position on the labor grade structure; and,

**WHEREAS**, on December 15, 2015, at a meeting of the Human Resources and Labor Negotiations Committee, Patrick Glynn, Senior Consultant of Carlson Dettmann, conferred with the Committee about the proposal to place the Administrator position on the labor grade structure; and,

**WHEREAS**, as a result of these studies and analyses by the Human Resources and Labor Negotiations Committee of the proposal to place the Administrator position on the labor grade structure, the Committee took formal action:

1. On December 15, 2015, to adjust the labor grade structure by adding Labor Grade 17 and Labor Grade 18, and to place the Administrator position into Labor Grade 18 of the newly-adjusted labor grade structure;
2. On February 2, 2016, upon the recommendation of the Dodge County Executive Committee, to place the Administrator position in Step 1 of Labor Grade 18, of the labor grade structure, effective July 9, 2016; and,
3. On February 2, 2016, to provide that future step increases for the individual occupying the Administrator position shall be determined based on performance evaluations to be conducted by the Dodge County Executive Committee, all of which shall be conducted in accordance with Dodge County Policies relating to the implementation and administration of the newly-adjusted labor grade structure, except that any performance evaluation resulting in a rating, which as to other employees, would be subject to review and approval by the County Administrator, will instead be subject to review and approval by the Chairman of the Dodge County Board of Supervisors; and,

**WHEREAS**, there are funds in the 2016 Dodge County Administrator Budget available and sufficient to fund wages and fringe benefits for the Administrator position at Step 1 in Labor Grade 18 of the labor grade structure, during the period of time commencing on July 9, 2016, and ending on December 31, 2016, both inclusive; and,

**WHEREAS**, a copy of the Dodge County Compensation Plan has been marked for identification as Exhibit "A", and has been attached hereto; and,

**WHEREAS**, a copy of a document entitled *2016 Wages and Fringe Benefits for the Dodge County Administrator Position* has been marked for identification as Exhibit "B", and has been attached hereto; and,



WHEREAS, a copy of a document entitled *County Administrator Compensation/Benefit Comparison*, which was compiled and issued by Sheboygan County, Wisconsin, in 2015, has been marked for identification as Exhibit "C", and has been attached hereto;

SO, NOW, THEREFORE, BE IT RESOLVED, that the Dodge County Board of Supervisors hereby approves and ratifies the formal action which the Dodge County Human Resources and Labor Negotiations Committee took:

1. On December 15, 2015, to adjust the labor grade structure by adding Labor Grade 17 and Labor Grade 18, and to place the Administrator position into Labor Grade 18 of the newly-adjusted labor grade structure;
2. On February 2, 2016, upon the recommendation of the Dodge County Executive Committee, to place the Administrator position in Step 1 of Labor Grade 18, of the labor grade structure, effective July 9, 2016; and,
3. On February 2, 2016, to provide that future step increases for the individual occupying the Administrator position shall be determined based on performance evaluations to be conducted by the Dodge County Executive Committee, all of which shall be conducted in accordance with Dodge County Policies relating to the implementation and administration of the newly-adjusted labor grade structure, except that any performance evaluation resulting in a rating, which as to other employees, would be subject to review and approval by the County Administrator, will instead be subject to review and approval by the Chairman of the Dodge County Board of Supervisors.

All of which is respectfully submitted this 17th day of February, 2016.

**Dodge County Executive Committee:**

  
\_\_\_\_\_  
Russell Kottke

\_\_\_\_\_  
Harold Johnson

  
\_\_\_\_\_  
Donna Maly

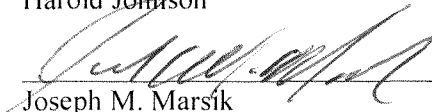
  
\_\_\_\_\_  
Joseph M. Marsik

  
\_\_\_\_\_  
MaryAnn Miller

  
\_\_\_\_\_  
Jeff Berres

  
\_\_\_\_\_  
David Frohling

**Dodge County Human Resources and Labor Negotiations Committee:**

\_\_\_\_\_  
Joseph Marsik

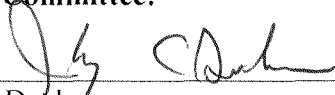
  
\_\_\_\_\_  
Jeffrey Duchac

  
\_\_\_\_\_  
David Frohling

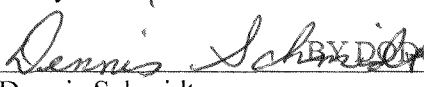
  
\_\_\_\_\_  
Dennis Schmidt

ADOPTED  
BY DODGE COUNTY BOARD

  
\_\_\_\_\_  
Richard Greshay

FEB 17 2016

AYES	24	NOES	4
ABSENT	3		
ABSTAIN	1		

*Karen J. Bilson*  
County Clerk

DODGE COUNTY COMPENSATION PLAN  
EFFECTIVE: JANUARY 1, 2016

Labor Grade	Merit Pay (effective 01/01/16)																		Max Step14B			
	Step 1	Step 2	Step 3	Step 4	Step 5	Control Point Step 6	Step 7A	Step 7B	Step 8A	Step 8B	Step 9A	Step 9B	Step 10A	Step 10B	Step 11A	Step 11B	Step 12A	Step 12B		Step 13A	Step 13B	Step 14A
1	\$10.89	\$11.20	\$11.51	\$11.82	\$12.13	\$12.44	\$12.60	\$12.75	\$12.91	\$13.06	\$13.22	\$13.37	\$13.53	\$13.68	\$13.84	\$14.00	\$14.15	\$14.31	\$14.46	\$14.62	\$14.77	\$14.93
2	\$12.81	\$13.18	\$13.54	\$13.91	\$14.27	\$14.64	\$14.82	\$15.01	\$15.19	\$15.37	\$15.56	\$15.74	\$15.92	\$16.10	\$16.29	\$16.47	\$16.65	\$16.84	\$17.02	\$17.20	\$17.39	\$17.57
3	\$14.74	\$15.16	\$15.58	\$16.00	\$16.42	\$16.84	\$17.05	\$17.26	\$17.47	\$17.68	\$17.89	\$18.10	\$18.31	\$18.52	\$18.73	\$18.95	\$19.16	\$19.37	\$19.58	\$19.79	\$20.00	\$20.21
4	\$16.66	\$17.14	\$17.61	\$18.09	\$18.56	\$19.04	\$19.28	\$19.52	\$19.75	\$19.99	\$20.23	\$20.47	\$20.71	\$20.94	\$21.18	\$21.42	\$21.66	\$21.90	\$22.13	\$22.37	\$22.61	\$22.85
5	\$18.59	\$19.12	\$19.65	\$20.18	\$20.71	\$21.24	\$21.51	\$21.77	\$22.04	\$22.30	\$22.57	\$22.83	\$23.10	\$23.36	\$23.63	\$23.90	\$24.16	\$24.43	\$24.69	\$24.96	\$25.22	\$25.49
6	\$20.51	\$21.10	\$21.68	\$22.27	\$22.85	\$23.44	\$23.73	\$24.03	\$24.32	\$24.61	\$24.91	\$25.20	\$25.49	\$25.78	\$26.08	\$26.37	\$26.66	\$26.96	\$27.25	\$27.54	\$27.84	\$28.13
7	\$22.44	\$23.08	\$23.72	\$24.36	\$25.00	\$25.64	\$25.96	\$26.28	\$26.60	\$26.92	\$27.24	\$27.56	\$27.88	\$28.20	\$28.52	\$28.85	\$29.17	\$29.49	\$29.81	\$30.13	\$30.45	\$30.77
8	\$24.36	\$25.06	\$25.75	\$26.45	\$27.14	\$27.84	\$28.19	\$28.54	\$28.88	\$29.23	\$29.58	\$29.93	\$30.28	\$30.62	\$30.97	\$31.32	\$31.67	\$32.02	\$32.36	\$32.71	\$33.06	\$33.41
9	\$26.29	\$27.04	\$27.79	\$28.54	\$29.29	\$30.04	\$30.42	\$30.79	\$31.17	\$31.54	\$31.92	\$32.29	\$32.67	\$33.04	\$33.42	\$33.80	\$34.17	\$34.55	\$34.92	\$35.30	\$35.67	\$36.05
10	\$28.21	\$29.02	\$29.82	\$30.63	\$31.43	\$32.24	\$32.64	\$33.05	\$33.45	\$33.85	\$34.26	\$34.66	\$35.06	\$35.46	\$35.87	\$36.27	\$36.67	\$37.08	\$37.48	\$37.88	\$38.29	\$38.69
11	\$30.14	\$31.00	\$31.86	\$32.72	\$33.58	\$34.44	\$34.87	\$35.30	\$35.73	\$36.16	\$36.59	\$37.02	\$37.45	\$37.88	\$38.31	\$38.75	\$39.18	\$39.61	\$40.04	\$40.47	\$40.90	\$41.33
12	\$32.06	\$32.98	\$33.89	\$34.81	\$35.72	\$36.64	\$37.10	\$37.56	\$38.01	\$38.47	\$38.93	\$39.39	\$39.85	\$40.30	\$40.76	\$41.22	\$41.68	\$42.14	\$42.59	\$43.05	\$43.51	\$43.97
13	\$33.99	\$34.96	\$35.93	\$36.90	\$37.87	\$38.84	\$39.33	\$39.81	\$40.30	\$40.78	\$41.27	\$41.75	\$42.24	\$42.72	\$43.21	\$43.70	\$44.18	\$44.67	\$45.15	\$45.64	\$46.12	\$46.61
14	\$36.87	\$37.93	\$38.98	\$40.03	\$41.09	\$42.14	\$42.67	\$43.19	\$43.72	\$44.25	\$44.77	\$45.30	\$45.83	\$46.35	\$46.88	\$47.41	\$47.93	\$48.46	\$48.99	\$49.51	\$50.04	\$50.57
15	\$40.72	\$41.89	\$43.05	\$44.21	\$45.38	\$46.54	\$47.12	\$47.70	\$48.29	\$48.87	\$49.45	\$50.03	\$50.61	\$51.19	\$51.78	\$52.36	\$52.94	\$53.52	\$54.10	\$54.68	\$55.27	\$55.85
16	\$44.57	\$45.85	\$47.12	\$48.39	\$49.67	\$50.94	\$51.58	\$52.21	\$52.85	\$53.49	\$54.12	\$54.76	\$55.40	\$56.03	\$56.67	\$57.31	\$57.94	\$58.58	\$59.22	\$59.85	\$60.49	\$61.13
17	\$48.42	\$49.81	\$51.19	\$52.57	\$53.96	\$55.34	\$56.03	\$56.72	\$57.42	\$58.11	\$58.80	\$59.49	\$60.18	\$60.87	\$61.57	\$62.26	\$62.95	\$63.64	\$64.33	\$65.02	\$65.72	\$66.41
18	\$52.27	\$53.77	\$55.26	\$56.75	\$58.25	\$59.74	\$60.49	\$61.23	\$61.98	\$62.73	\$63.47	\$64.22	\$64.97	\$65.71	\$66.46	\$67.21	\$67.95	\$68.70	\$69.45	\$70.19	\$70.94	\$71.69

## 2016 Wages and Fringe Benefits for the Dodge County Administrator Position

1. Wages and Fringe Benefits in the adopted 2016 Dodge County Budget

A. Wages	\$107,918
B. Fringe Benefits	<u>\$ 33,531</u>
C. Total of Wages plus Fringe Benefits	\$141,449

---

2. Actual 2016 Wages and Fringe Benefits with a Step 1, Labor Grade 18, Implementation on July 9, 2016

A. Wages	\$107,887
B. Fringe Benefits	<u>\$ 33,527</u>
C. Total of Wages plus Fringe Benefits	\$141,414

County Administrator Compensation/Benefit Comparison

County	2010 Population	2015 (Current) Salary	Years in Position	Retention Incentive	Vehicle Allowance	Expense Allowance	WRS (Employee Portion)	Deferred Comp	Dues for Civic Clubs	Vacation	Personal Days	Professional Development
Ashland	16,157											
Barron	45,870	\$105,794	6							24		Memberships to NACA, ICMA, WCEA, WCMA and WICPA
Bayfield	15,014											
Burnett	15,457	\$98,000	2					\$600 annually	As needed	18	Ability to flex as needed	Memberships to WCMA, ICMA, anything else up to \$2500
Calumet	48,971	\$135,000 (to increase \$5,000 per year through 2018 - 2018 salary will be \$150,000)	1	Beginning January 2016, \$4,000 annually paid in \$1,000 quarterly installments. Beginning January 2018, \$8,000 annually in \$2,000 quarterly installments.				County to contribute 3% of annual base salary		PTO @ level 5 (21 years of service). Total per year is 43.		Memberships to NACA, ICMA, WCEA, WCMA and cost of attending one national conference in addition to the NACo conference annually.
Chippewa	62,415											
Dodge	88,759	\$106,300	7							20		Memberships to ICMA, WCMA, WGFOA
Door	27,785	\$108,000	1 month							PTO @ 5 years Service (24 days)		Memberships to ICMA, WCMA and conference support
Douglas	44,159	\$103,022	5	P4P to 120% of scale (potential to \$126,797 - must meet standards for 2 years consecutively to increase salary over 100%).					\$2,000 annual budget covers professional and civic club dues	20	28 hours per year; no carry over - use or lose	Training Budget is \$7,500; includes travel, meal reimbursement, conference/training costs
Dunn	43,857	\$121,472	14		\$6,900 annually (Determined by multiplying the current standard business mileage rate established by the IRS by 1000. For 2015, the amount is 57.5 cents/mile or \$575)					20		Memberships to NACA, ICMA, WCEA, WCMA and cost of attending one national conference or the NACo conference annually

County Administrator Compensation/Benefit Comparison

County	2010 Population	2015 (Current) Salary	Years in Position	Retention Incentive	Vehicle Allowance	Expense Allowance	WRS (Employee Portion)	Deferred Comp	Dues for Civic Clubs	Vacation	Personal Days	Professional Development
Eau Claire	98,736	\$135,000	1 month CURRENTLY VACANT						Membership dues, fees and attendant expenses to participate in a local civic or community organization.	26		Memberships to NACA, ICMA, WCEA, WCEA and cost of attending one national conference annually
Iowa	23,687	\$92,000								MTO level 4 of 6 (31 days)		WCMA & ICMA
Jefferson Kewaunee	83,686 20,574	\$121,600 \$90,001	2 6 months							15 10	5	Memberships to ICMA, WCEA and WCMA; Pay State Bar annual license fee; Conference expenses based on annual budget
La Crosse	114,638	\$180,245	12	\$12,000	\$2,400 plus travel outside the County on County business will be reimbursed according to County policy			The \$12,000 annual Retention Award is deposited into a deferred compensation account at 25% per quarter	Pay for reasonable membership fees and/or dues for ONE club/organization	25	10	Memberships not limited to ICMA, WCMA, NACo dues and conference expenses
Marathon Marquette	134,063 41,749	\$124,538 \$115,000	7 3 months						Rotary	32.5 20	5	ICMA Dues and Conference, WCMA Dues and Conference, WCA Legislative Conference Reasonable
Monroe	44,673	\$95,900	6				100% per contract			23	1.5	Memberships to WCMA, ICMA, GFOA
Ozaukee	86,395	\$128,710	15							20		Memberships not limited to WCMA, WCEA, NACO
Rock	160,331	\$127,500	1		\$6,000	\$2,000		\$4,000 annually		25		Memberships not limited to WCMA, ICMA, WCEA
Sheboygan	115,507	\$130,333	16							22		Membership to WCEA and attending WCA, NACO conferences budgeted

County Administrator Compensation/Benefit Comparison

County	2010 Population	2015 (Current) Salary	Years in Position	Retention Incentive	Vehicle Allowance	Expense Allowance	WRS (Employee Portion)	Deferred Comp	Dues for Civic Clubs	Vacation	Personal Days	Professional Development
St. Croix	84,345	\$160,000	4	Same P4P program as employees. For 2015, amount earned was 2% of \$3,200.	\$4,800 with annual adjustment to reflect increases and decreases in CPI.					36		Memberships to WCMA, ICMA and one area service organization. May attend 2 NACo/NACA and one ICMA Conference annually.
Walworth	102,228	\$150,942	14						As needed	20 (able to bank 6 weeks)	Same as Walworth County employees	Memberships to WCEA, ICMA; ICMA, WCA, NACo annual conferences
Washington	131,887	\$111,966	2						Rotary	25 days PTO		Memberships to WCMA & ICMA. May attend 2 NACo/NACA and one ICMA Conference annually.

September 1, 2015

RESOLUTION NO. 15-76

TO THE HONORABLE BOARD OF SUPERVISORS OF DODGE COUNTY, WISCONSIN MEMBERS,

**WHEREAS**, by means of Resolution No. 08-44, adopted by the Dodge County Board of Supervisors on August 19, 2008, the Dodge County Board of Supervisors appointed James E. Mielke as Dodge County Administrator, effective September 22, 2008, and approved, endorsed, and ratified a proposed *County Administrator Employment Agreement*, which was subsequently executed by Dodge County and James E. Mielke, and is dated August 26, 2008; and,

**WHEREAS**, the Dodge County Executive Committee, at its February 1, 2016, meeting, reviewed the annual compensation for the County Administrator as set forth in the *County Administrator Employment Agreement, Dated August 26, 2008*; and,

**WHEREAS**, the Executive Committee recommends that the *County Administrator Employment Agreement, Dated August 26, 2008*, be amended as follows:

1. That the provision within Section 8 of the Contract entitled "SALARY" be amended to provide as follows:

**"SALARY.**

- A.** Employer shall pay Employee a bi-weekly salary equivalent to an annual amount of \$98,000 divided by 26 bi-weekly pay periods, beginning on Employee's first date of employment and continuing through the remaining pay periods of 2008, 2009, 2010, 2011, and 2012. Commencing with calendar year 2015, the Employer shall pay Employee a bi-weekly salary equivalent to an annual amount of \$106,323 divided by the number of bi-weekly paydays occurring within the calendar year. Thereafter, the salary of the Employee shall be recommended to the County Board by the Executive Committee, with consideration given to Employee's performance.
- B.** **Notwithstanding the preceding paragraph A, if Employer takes or has taken action to place the position of County Administrator on the Dodge County Compensation Plan, also known as the Dodge County Labor Grade Structure, (or any successor compensation plan applicable to Employer's department heads) ("Plan"), then, as of the effective date of such action, paragraph A of this Section 8 shall be of no prospective effect, and thereafter, Employee's salary shall be based upon the Plan in accordance with the labor grade and step designated by Employer, and any subsequent amendments to the Plan, and any step increases implemented in accordance with Employer's policies regarding step increases under the Plan. Furthermore, if Employer takes action to place the position of County Administrator on the Plan, then, any compensation due to Employee under paragraph A of this Section 8 shall be prorated to the effective date of such action, and any**

compensation due to Employee under the Plan shall be prorated from the effective date of such action.

C. Future step increases for Employee beyond Step 1 of Labor Grade 18 of the Plan shall be determined based on performance evaluations of Employee to be conducted by the Dodge County Executive Committee, all of which shall be conducted in accordance with Dodge County Policies relating to the implementation and administration of the Plan, except that any performance evaluation of Employee resulting in a rating, which if received by any other Dodge County employee or employees, would require review and approval by Employee, will instead be subject to review and approval by the Chairman of the Dodge County Board of Supervisors."

WHEREAS, the requested amendment has been set forth in writing in a document entitled *Seventh Amendment To County Administrator Employment Agreement, Dated August 26, 2008*, a copy of which has been attached hereto; and,

WHEREAS, the Executive Committee recommends that the Dodge County Board of supervisors approve the *Seventh Amendment To County Administrator Employment Agreement, Dated August 26, 2008*, and authorize and direct Russell Kottke, Chairman of the Dodge County Board of Supervisors, to execute the *Seventh Amendment To County Administrator Employment Agreement, Dated August 26, 2008*, on behalf of Dodge County;

SO, NOW, THEREFORE, BE IT RESOLVED, that the Dodge County Board of Supervisors hereby approves the *Seventh Amendment To County Administrator Employment Agreement, Dated August 26, 2008*, a copy of which has been attached hereto, and hereby authorizes and directs Russell Kottke, Chairman of the Dodge County Board of Supervisors, to execute the *Seventh Amendment To County Administrator Employment Agreement, Dated August 26, 2008*, on behalf of Dodge County.

All of which is respectfully submitted this 17th day of February, 2016.

Dodge County Executive Committee:

Russell Kottke  
Russell Kottke

Harold Johnson

Donna Maly  
Donna Maly

Joseph M. Marsik  
Joseph M. Marsik

Mary Ann Miller  
Mary Ann Miller

Jeff Berres  
Jeff Berres

David Frohling  
David Frohling

ADOPTED BY DODGE COUNTY BOARD

FEB 17 2016

AYES 24 NOES 4  
ABSENT 3  
ABSTAIN 1

\*\*\*Additions in text are indicated by underline and bold-faced type.\*\*\*

Karen J. Silson  
County Clerk



Seventh Amendment To County Administrator Employment Agreement  
Dated August 26, 2008

AGREEMENT made this 25th day of February, 2016, by and between Dodge County, a Wisconsin quasi-municipal corporation ("Employer" or "County"), and James E. Mielke ("Employee"). The Parties agree as follows:

This Agreement amends the County Administrator Employment Agreement ("Contract"), entered into by and between the Parties on August 26, 2008, as previously amended, and is an amendment to the Contract pursuant to Section 19 of said Contract, which provides that amendments to the Employment Agreement shall be as agreed from time to time and reduced to writing in the same fashion as the Employment Agreement.

The Parties further agree as follows:

That *Section 8 Salary and Benefits* of the *County Administrator Employment Agreement, dated August 26, 2008*, as amended (by the November 12, 2009 Amendment, the May 18, 2011 Second Amendment, the January 5, 2012 Third Amendment, the December 26, 2012 Fourth Amendment, the December 19, 2013 Fifth Amendment **and the November 13, 2014 Sixth Amendment** to the County Administrator Employment Agreement Dated August 26, 2008) (the "Contract"), shall be amended as follows:

1. The provision within Section 8 of the Contract entitled "SALARY" shall be amended to provide as follows:

**"SALARY.**

**A.** Employer shall pay Employee a bi-weekly salary equivalent to an annual amount of \$98,000 divided by 26 bi-weekly pay periods, beginning on Employee's first date of employment and continuing through the remaining pay periods of 2008, 2009, 2010, 2011, and 2012. Commencing with calendar year 2015, the Employer shall pay Employee a bi-weekly salary equivalent to an annual amount of \$106,323 divided by the number of bi-weekly paydays occurring within the calendar year. Thereafter, the salary of the Employee shall be recommended to the County Board by the Executive Committee, with consideration given to Employee's performance.

**B.** **Notwithstanding the preceding paragraph A, if Employer takes or has taken action to place the position of County Administrator on the Dodge County Compensation Plan, also known as the Dodge County Labor Grade Structure, (or any successor compensation plan applicable to Employer's department heads) ("Plan"), then, as of the effective date of such action, paragraph A of this Section 8 shall be of no prospective effect, and thereafter, Employee's salary shall be based upon the Plan in accordance with the labor grade and step designated by Employer, and any subsequent**

amendments to the Plan, and any step increases implemented in accordance with Employer's policies regarding step increases under the Plan. Furthermore, if Employer takes action to place the position of County Administrator on the Plan, then, any compensation due to Employee under paragraph A of this Section 8 shall be prorated to the effective date of such action, and any compensation due to Employee under the Plan shall be prorated from the effective date of such action.

C. Future step increases for Employee beyond Step 1 of Labor Grade 18 of the Plan shall be determined based on performance evaluations of Employee to be conducted by the Dodge County Executive Committee, all of which shall be conducted in accordance with Dodge County Policies relating to the implementation and administration of the Plan, except that any performance evaluation of Employee resulting in a rating, which if received by any other Dodge County employee or employees, would require review and approval by Employee, will instead be subject to review and approval by the Chairman of the Dodge County Board of Supervisors."

All other provisions of the *County Administrator Employment Agreement, dated August 26, 2008*, as previously amended, shall remain in full force and effect, and are not amended in any respect by this Seventh Amendment.

**EMPLOYER:**

DODGE COUNTY

Russell Kottke  
Russell Kottke, Chairman  
Dodge County Board of Supervisors

Dated: February 25, 2016

**ATTEST:**

Kelly L. Lepple  
Kelly L. Lepple

**APPROVED AS TO FORM:**

John F. Corey  
John F. Corey, Corporation Counsel  
Dated: February 1, 2016

**EMPLOYEE:**

JAMES E. MIELKE

James E. Mielke  
James E. Mielke

Dated: February 24, 2016

**ATTEST:**

Kelly L. Lepple  
Kelly L. Lepple

RESOLUTION NO. 15-77

TO THE HONORABLE BOARD OF SUPERVISORS OF DODGE COUNTY, WISCONSIN MEMBERS,

WHEREAS, the Dodge County Board of Supervisors adopted the 2015 Dodge County Budget on November 12, 2014; and,

WHEREAS, due to events which have taken place and circumstances which have changed since the Dodge County Board of Supervisors adopted the 2015 Dodge County Budget, it is now necessary to change the amounts of some of the various appropriations that were stated in the 2015 Dodge County Budget at the time it was adopted; and,

WHEREAS, the Dodge County Finance Committee hereby recommends to the Dodge County Board of Supervisors, that the Dodge County Board of Supervisors authorize and direct the Dodge County Finance Director to change the amounts of those appropriations that were stated in the 2015 Dodge County Budget at the time it was adopted:

- 1. In Clearview, as set forth in Exhibit "A", which has been attached hereto;

SO, NOW, THEREFORE, BE IT RESOLVED, that the Dodge County Board of Supervisors hereby authorizes and directs the Dodge County Finance Director to change the amounts of those appropriations that were stated in the 2015 Dodge County Budget at the time it was adopted:

- 1. In Clearview, as set forth in Exhibit "A", which has been attached hereto.

All of which is respectfully submitted this 17th day of February, 2016.

Dodge County Finance Committee:

David Frohling  
David Frohling

Gerald Adelmeyer  
Gerald Adelmeyer

Wayne Uttke  
Phillip Gohr

Thomas Schaefer  
Thomas Schaefer

ADOPTED  
BY DODGE COUNTY BOARD

FEB 17 2016

AYES 29 NOES 0  
ABSENT 3  
ABSTAIN 0

Raren J. Gibson  
County Clerk

<b>FISCAL NOTE:</b>	
Is the referenced expenditure included in the adopted <sup>2019</sup> <del>2016</del> Budget?	
<input checked="" type="checkbox"/> Yes or	<input type="checkbox"/> No
Fiscal Impact on the adopted <sup>2015</sup> <del>2016</del> Budget:	
\$ <u>0</u>	
Fiscal Impact reviewed by the Dodge County Finance Committee on	
<u>2019</u> <del>2016</del>	
<u>David Frohling</u>	
David Frohling, Chairman	
Dodge County Finance Committee	

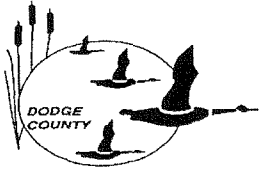

Dodge County, Wisconsin  
Finance Department  
Fund Transfer Form

Resolution Number:

Department: Clearview Fund: 645

For Finance Department use only

Doc# \_\_\_\_\_

Batch# \_\_\_\_\_

GL Date: \_\_\_\_\_

**Description of Adjustment:**

Memorandum - Clearview Budget Adjustment Request - January 28, 2016

Budget Amendments					
Business Unit Number	Account Object Number	Subsidiary Number	Account Title	Amount	
<b>Revenue Increases</b>					
4519	4697		Other Revenue	(67,881)	
4520	4613		PVT-Ancillary	(798)	
4520	4652		MA MCO Revenue	(29,205)	
4520	4734	451	MCHA Assessme	(100,000)	
4521	4636		Medicaid-ICF MR	(175,000)	
4524	4602		Private Pay Revenue	(100,000)	
4524	4794	02	Clrv-DD-Unifi	(50,316)	
4525	4652		MA MCO Revenue	(39,000)	
4525	4734	45	CV Other Coun	(115,000)	
4527	4602		Private Pay Revenue	(25,150)	
<b>Expenditure Increases</b>					
4520	5100		Salary & Fringe Benefits	475,000	
4520	5211	30	MC-Occup Thrp	5,000	
4520	5211	32	MC-Phys Thrpy	5,000	
4520	5211	36	MC-Laboratory	7,500	
4520	5341		Incontinent Supplies	4,600	
4520	5571	01	Bad Debt-Medi	1,500	
4520	5571	02	Bad Debt-Medi	4,200	
4520	5571	03	Bad Debt-Comm	7,250	
4521	5349		MA-Other Supplies	2,250	
4525	5100		Salary & Fringe Benefits	105,000	
4525	5571	01	Bad Debt-Medi	2,900	
4527	5100		Salary & Fringe Benefits	14,000	
4528	5349		Other Supplies	11,250	
4532	5100		Salary & Fringe Benefits	4,000	
4538	5100		Salary & Fringe Benefits	14,500	
4541	5100		Salary & Fringe Benefits	30,000	
4582	5514		Ins-Professional Liabi	8,400	
<b>Funds Applied</b>					

## **Memorandum**

### **Clearview Budget Adjustment Request January 28, 2016**

#### **Revenue Adjustments:**

Clearview has seen higher than budgeted revenue in several miscellaneous ancillary accounts. These include Cable / Telephone revenue, therapies, and other private pay charges.

Clearview has collected old assessments that were due from other counties. The increase in the amount of the collections exceeded our budgeted amount for the 2015.

Collections from various payer sources such as Managed Care Organizations, Medicaid, and private pay residents have exceeded budget projections.

#### **Expense Adjustments:**

The Nursing Home, Behavioral Health, Community Group Home, Physician Services, Activities, and Dietary areas have additional salary and fringe benefits costs. This is due to higher than budgeted census in most areas of Clearview.

Additional expenses due to higher than budgeted census are medical and resident supplies, medications, therapies, and ancillary services.

Additional expenses are; bad debts expense and increased licensed staff insurance due to the addition of a doctor. Bad debts expense increased slightly in some areas of the facility due to the change in Clearview's method of estimating the allowance for doubtful accounts.

RESOLUTION NO. 15-78

TO THE HONORABLE BOARD OF SUPERVISORS OF DODGE COUNTY, WISCONSIN MEMBERS,

**WHEREAS**, the Dodge County Board of Supervisors adopted the 2015 Dodge County Budget on November 12, 2014; and,

**WHEREAS**, due to events which have taken place and circumstances which have changed since the Dodge County Board of Supervisors adopted the 2015 Dodge County Budget, it is now necessary to change the amounts of some of the various appropriations that were stated in the 2015 Dodge County Budget at the time it was adopted; and,

**WHEREAS**, the Dodge County Finance Committee hereby recommends to the Dodge County Board of Supervisors, that the Dodge County Board of Supervisors authorize and direct the Dodge County Finance Director to change the amounts of those appropriations that were stated in the 2015 Dodge County Budget at the time it was adopted:

- 1. In the Courts, as set forth in Exhibit "A", which has been attached hereto;

**SO, NOW, THEREFORE, BE IT RESOLVED**, that the Dodge County Board of Supervisors hereby authorizes and directs the Dodge County Finance Director to change the amounts of those appropriations that were stated in the 2015 Dodge County Budget at the time it was adopted:

- 1. In the Courts, as set forth in Exhibit "A", which has been attached hereto.

All of which is respectfully submitted this 17th day of February, 2016.

**Dodge County Finance Committee:**

*David Frohling*  
David Frohling

*Gerald Adelmeyer*  
Gerald Adelmeyer

Wayne Uttke

*Thomas Schaefer*  
Thomas Schaefer

*Phillip Gohr*  
Phillip Gohr

ADOPTED  
BY DODGE COUNTY BOARD

FEB 17 2016

AYES	<u>29</u>	NOES	<u>0</u>
ABSENT	<u>3</u>		
ABSTAIN	<u>0</u>		

*Karen J. Gibson*  
County Clerk

<b>FISCAL NOTE:</b>	
Is the referenced expenditure included in the adopted <del>2016</del> <sup>2015</sup> Budget?	
<input checked="" type="checkbox"/> Yes or <input type="checkbox"/> No	
Fiscal Impact on the adopted <del>2016</del> <sup>2015</sup> Budget:	
\$ <u>0</u>	
Fiscal Impact reviewed by the Dodge County Finance Committee on <u>2/9</u> 2016.	
<i>David Frohling</i>	
David Frohling, Chairman Dodge County Finance Committee	

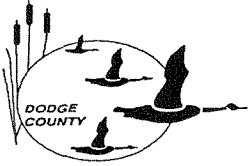

Dodge County, Wisconsin  
 Finance Department  
 Fund Transfer Form

Resolution Number:

Department: Courts

For Finance Department use only

Doc# \_\_\_\_\_

Batch# \_\_\_\_\_

GL Date: \_\_\_\_\_

**Description of Adjustment:**

Please see Memorandum To: Dodge County Finance Committee and James Mielke, County Administrator

From: Steven G. Bauer, Circuit Judge, Date: February 1, 2016, RE: Budget Adjustment - Circuit Courts

Budget Amendments			Account Title	Amount
Business Unit Number	Account Object Number	Subsidiary Number		
<b>Revenue Decreases</b>				
301	4221	031	Circuit Court Grant	8,000
308	4221	032	Guardian Ad Litem Grant	5,800
<b>Revenue Increases</b>				
307	4521	033	Attorney Fee Recoupment	(29,000)
308	4521	031	Guardian Ad Litem Recoupment	(15,000)
401	4512		Document Filing Fees	(2,000)
<b>Expenditure Increases</b>				
307	5211	03	Psychiatric Evaluations	49,500
<b>Expenditure Decreases</b>				
301	5121		Wages and Fringe Benefits	(4,000)
301	5156		Court Commissioner Pay	(6,000)
301	5312		Office Supplies	(3,000)
301	5812		Furniture & Furnishing	(1,500)
401	5121		Wages and Fringe Benefits	(2,800)
<b>Funds Applied</b>				
				0.00

**STEVEN G. BAUER, CIRCUIT JUDGE**  
**DODGE COUNTY CIRCUIT COURT, BRANCH FOUR**  
Dodge County Justice Facility  
210 West Center Street  
Juneau, Wisconsin 53039-1091  
920) 386-4050 FAX (920) 386-3587

Doreen Streblov, RPR  
(920) 386-4049  
Court Reporter

Barbara N. Brandt  
(920) 386-4050  
Judicial Assistant

MEMORANDUM

To: Dodge County Finance Committee  
James Mielke, County Administrator

From: Steven G. Bauer, Circuit Judge

Date: February 8, 2016

Re: Budget Adjustment – Circuit Courts

Attached you will find a fund transfer request to move funds among budget units to cover an increase in expenditures for psychiatric evaluations. The main adjustment is a \$49,500 increase in the Court's budget for psychiatric evaluations. As you might remember, an additional \$14,000 was added to this line item during 2015 to cover an anticipated deficit. Unfortunately, the \$14,000 was insufficient. The total costs for psychiatric evaluations was approximately \$129,500. The 2015 budget for this line item was \$66,000.

The increased costs for psychiatric evaluations was primarily the result of an increase in mental commitments. Under the law, when someone is taken into custody, and the Court has found probable cause that he or she suffers from a treatable mental illness and are a substantial risk of danger to either themselves or others, the Court must order two psychiatric evaluations. The Court has no control over the number of these commitments. They are kind of like snowstorms.

There were two other revenue decreases related to the Circuit Court grant (\$8,000) and Guardian ad litem grant (\$5,800) to reflect the amount actually received from the State.

Fortunately, there were positive surprises in the budget. We collected more money for attorney's fees (\$29,000) and guardian ad litem fees (\$15,000) than what was budgeted. Moreover, there was money left in other line items that were not expended this year (I was concerned with the uncertainty of the budget), with the largest being fill-in court commissioner pay (\$6,000.)

I can inform you that I, with the assistance of Julie Kolp, have put in place some accounting measures that should help me make the estimate for psychiatric expenses more accurate. I respectfully ask you to approve this budget amendment.



RESOLUTION NO. 15-79

TO THE HONORABLE BOARD OF SUPERVISORS OF DODGE COUNTY, WISCONSIN MEMBERS,

WHEREAS, the Dodge County Board of Supervisors adopted the 2015 Dodge County Budget on November 12, 2014; and,

WHEREAS, due to events which have taken place and circumstances which have changed since the Dodge County Board of Supervisors adopted the 2015 Dodge County Budget, it is now necessary to change the amounts of some of the various appropriations that were stated in the 2015 Dodge County Budget at the time it was adopted; and,

WHEREAS, the Dodge County Finance Committee hereby recommends to the Dodge County Board of Supervisors, that the Dodge County Board of Supervisors authorize and direct the Dodge County Finance Director to change the amounts of those appropriations that were stated in the 2015 Dodge County Budget at the time it was adopted:

- 1. In the Highway Department, as set forth in Exhibit "A", which has been attached hereto;

SO, NOW, THEREFORE, BE IT RESOLVED, that the Dodge County Board of Supervisors hereby authorizes and directs the Dodge County Finance Director to change the amounts of those appropriations that were stated in the 2015 Dodge County Budget at the time it was adopted:

- 1. In the Highway Department, as set forth in Exhibit "A", which has been attached hereto.

All of which is respectfully submitted this 17th day of February, 2016.

Dodge County Finance Committee:

*David Frohling*  
David Frohling

*Gerald Adelmeyer*  
Gerald Adelmeyer

Wayne Uttke  
*Phillip Gohr*  
Phillip Gohr

*Thomas Schaefer*  
Thomas Schaefer

<b>FISCAL NOTE:</b>	
Is the referenced expenditure included in the adopted <sup>2015</sup> <del>2016</del> Budget?	
<input checked="" type="checkbox"/> Yes or	<input type="checkbox"/> No
Fiscal Impact on the adopted <sup>2015</sup> <del>2016</del> Budget:	
\$	<u>0</u>
Fiscal Impact reviewed by the Dodge County Finance Committee on	
<u>2/19</u>	<u>2016</u> .
<i>David Frohling</i>	
David Frohling, Chairman	
Dodge County Finance Committee	

ADOPTED  
BY DODGE COUNTY BOARD

FEB 17 2016

AYES 29 NOES 0  
ABSENT 3  
ABSTAIN 0

*Haren J. Silson*  
County Clerk



Dodge County, Wisconsin  
Finance Department  
Fund Transfer Form

Resolution Number:

Department: Highway

For Finance Department use only

Doc# \_\_\_\_\_

Batch# \_\_\_\_\_

GL Date: \_\_\_\_\_

Description of Adjustment:

Please see Memo to: Finance Committee From: Brian Field, Commissioner

Dated: January 29, 2016 RE: 2015 Budget Amendment Summary

Budget Amendments					
Business Unit Number	Account Object Number	Subsidiary Number	Account Title		Amount
<b>Revenue Decreases</b>					
3321	4723	11	STHS Maintenance Servs-Routine		350,860
<b>Revenue Increases</b>					
3111	4895	142	Hwy Administration-US Bank Rebate		(16,901)
3312	4723	06	CTHS Snow & Ice-Salt Storage		(13,704)
3322	4723	01	STHS Road/Bridge Const-Services		(341,132)
3322	4723	02	STHS Road/Bridge Const-Rec/Rep		(9,728)
3328	4723	01	STHS Other-Services		(124,267)
3328	4723	02	STHS Other-Rec/Rep		(5,369)
<b>Expenditure Increases</b>					
3281	5494		Capital Asset Acq-Materials & Sup		81,891
3313	5121		CTHS Road Const-Labor		34,580
3313	5122		CTHS Road Const-Overtime		21,668
3313	5491		CTHS Road Const-Employee Benefits		73,155
3313	5492		CTHS Road Const-Field Small Tools		6,906
3313	5493		CTHS Road Const-Machinery & Equip		141,906
3313	5494		CTHS Road Const-Materials & Sup		27,685
3322	5121		STHS Road/Bridge Const-Wages		42,412
3322	5122		STHS Road/Bridge Const-Wages OT		68
3322	5491		STHS Road/Bridge Const-EE Benefits		31,330
3322	5492		STHS Road/Bridge Const-Field Sm TI		1,845
3322	5493		STHS Road/Bridge Const-Mach/Equip		81,039
3322	5494		STHS Road/Bridge Const-Materials		68,491
3328	5121		STHS Other- Wages		21,962
3328	5122		STHS Other- Wages OT		3,093
3328	5491		STHS Other - Benefits		18,032
3328	5492		STHS Other-Field Small Tools		1,096
3328	5493		STHS Other-Mach/Equip		18,276
3328	5494		STHS Other-Materials		61,808
<b>Expenditure Decreases</b>					
3311	5493	311	CTHS Westside Maint-Mach/Equip		(75,200)
3311	5493	312	CTHS Eastside Maint-Mach/Equip		(50,550)
3311	5493	315	CTHS Centerline Marking-Mach/Equip		(7,360)
3311	5493	321	CTHS Westside Sealcoat Maint-Mach/Equip		(13,950)
3311	5493	322	CTHS Eastside Sealcoat Maint-Mach/Equip		(11,180)
3311	5494	322	CTHS Eastside Sealcoat-Materials		(49,650)
3312	5493		CTHS Snow & Ice Control-Mach/Equip		(19,660)
3321	5121		STHS Maintenance-Wages		(64,374)
3321	5122		STHS Maintenance-Wages-OT		(3,161)
3321	5491		STHS Maintenance-Benefits		(49,362)
3321	5492		STHS Maintenance-Field Small Tools		(2,941)
3321	5493		STHS Maintenance-Mach/Equip		(99,315)
3321	5494		STHS Maintenance-Materials		(130,299)
<b>Funds Applied</b>					0.00

February 2016

# **DODGE COUNTY HIGHWAY COMMISSION**

211 East Center Street  
Juneau WI 53039-1309  
(920) 386-3650 (phone)  
(920) 386-3525 (fax)

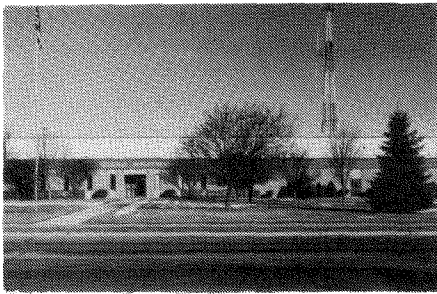

**HIGHWAY DEPARTMENT**

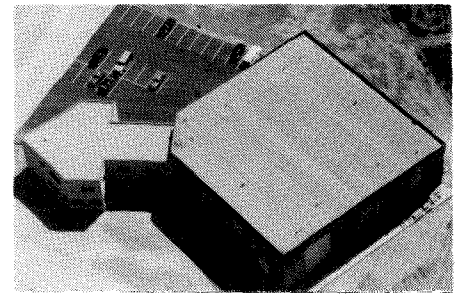

**AIRPORT TERMINAL BUILDING**

**COMMISSIONER**

Brian Field  
bfield@co.dodge.wi.us

**DODGE COUNTY  
HIGHWAY  
COMMITTEE**

Harold J. Johnson,  
Chair  
Jeff Berres  
Chester Caine  
Randy Grebel  
William T. Muche

**ASSISTANT  
COMMISSIONER**

Peter L. Thompson  
pthompson@co.dodge.wi.us

**PATROL  
SUPERINTENDENTS**

Nate Minnig  
nminnig@co.dodge.wi.us

Joseph Lechner  
jlechner@co.dodge.wi.us

**SHOP  
SUPERINTENDENT**

John Haase  
jhaase@co.dodge.wi.us

**OPERATIONS  
SUPERINTENDENT**

Steve Pett  
spett@co.dodge.wi.us

**OFFICE MANAGER**

Lori M. Fett  
lfett@co.dodge.wi.us

MEMO TO: Finance Committee  
  
FROM: Brian Field, Commissioner  
  
DATE: January 29, 2016  
  
SUBJECT: 2015 Budget Amendment Summary

We submit these proposed budget amendments to account for additional revenues received from the Wisconsin Department of Transportation through the performance based maintenance contracts. The additional revenues were utilized primarily to cover costs incurred to provide the services. The net gain was applied to the purchase of additional equipment and to fund two additional full-time positions in the department.

We also received a rebate from US Bank for our credit card purchases in 2015. The revenue helped to fund additional equipment purchased.

A combination of unspent CTH Maintenance money and unspent Snow and Ice money is being proposed to cover the cost overrun experienced in our Capital Projects Highway Reconstruction Business Unit.

When our final 2015 year end accounting is completed, any remaining funds will be considered unreserved retained earnings in the Highway Commission fund.

RESOLUTION NO. 15-80

TO THE HONORABLE BOARD OF SUPERVISORS OF DODGE COUNTY, WISCONSIN MEMBERS,

**WHEREAS**, the Dodge County Board of Supervisors adopted the 2015 Dodge County Budget on November 12, 2014; and,

**WHEREAS**, due to events which have taken place and circumstances which have changed since the Dodge County Board of Supervisors adopted the 2015 Dodge County Budget, it is now necessary to change the amounts of some of the various appropriations that were stated in the 2015 Dodge County Budget at the time it was adopted; and,

**WHEREAS**, the Dodge County Finance Committee hereby recommends to the Dodge County Board of Supervisors, that the Dodge County Board of Supervisors authorize and direct the Dodge County Finance Director to change the amounts of those appropriations that were stated in the 2015 Dodge County Budget at the time it was adopted:

- 1. In the Human Services and Health Department, as set forth in Exhibit "A", which has been attached hereto;

**SO, NOW, THEREFORE, BE IT RESOLVED**, that the Dodge County Board of Supervisors hereby authorizes and directs the Dodge County Finance Director to change the amounts of those appropriations that were stated in the 2015 Dodge County Budget at the time it was adopted:

- 1. In the Human Services and Health Department, as set forth in Exhibit "A", which has been attached hereto.

All of which is respectfully submitted this 17th day of February, 2016.

**Dodge County Finance Committee:**

*David Frohling*  
David Frohling

*Gerald Adelmeier*  
Gerald Adelmeier

Wayne Uttke

*Thomas Schaefer*  
Thomas Schaefer

*Phillip Gohr*  
Phillip Gohr

<b>FISCAL NOTE:</b>	
Is the referenced expenditure included in the adopted, <sup>2015</sup> <del>2016</del> Budget?	
<input checked="" type="checkbox"/> Yes or <input type="checkbox"/> No	
Fiscal Impact on the adopted <sup>2015</sup> <del>2016</del> Budget:	
\$ <u>    - 0 -    </u>	
Fiscal Impact reviewed by the Dodge County Finance Committee on	
<u>2/9</u> , 2016.	
<i>David Frohling</i>	
David Frohling, Chairman	
Dodge County Finance Committee	

ADOPTED  
BY DODGE COUNTY BOARD

FEB 17 2016

AYES 29 NOES 0  
ABSENT 3  
ABSTAIN 0

*Karen J. Gibson*  
County Clerk



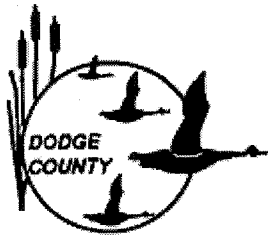

**Human Services &  
Health Department**

# Memo

**To:** Finance Committee  
**From:** Kenneth Kamps, Division Manager – Fiscal and Support Services  
**CC:** Janet Wimmer, Julie Kolp, Jim Mielke  
**Date:** January 28, 2016  
**Re:** 2015 Budget Amendments

---

Pursuant to a thorough review of the current 2015 revenues and expenditures we hereby request our department's 2015 budget be amended. We have increased revenues in certain areas due to modification of State contracts and increased Wisconsin Medical Assistance Program Cost Report payments. Secondly, there are some business units where expenditures are exceeding budgeted levels due to increased Mental Health and Children's out of home placements and services. Division Managers and Supervisors made a conscientious effort to decrease expenditures in a number of areas by reducing services and not refilling some positions funded in the 2015 budget. The specific business units and accounts impacted by this budget amendment are detailed on the attachment to this memorandum.

Overall the expenditure increase equals the expenditure decrease and revenue increase thus creating no overall budget impact. We are not requesting any general fund transfer related to these 2015 budget amendments.

RESOLUTION NO. 15-81

TO THE HONORABLE BOARD OF SUPERVISORS OF DODGE COUNTY, WISCONSIN MEMBERS,

**WHEREAS**, there are funds in the amount of \$3,500 in the 2015 Budget for the Dodge County Clerk in Business Unit 1204, Elections, Account No. .5313, Ballot Printing and Duplication, which funds were appropriated for the purpose of paying for the printing of ballots, available to carry over to the 2016 Budget for the County Clerk, and available for transfer to Business Unit 1204, Elections, Account No. .5312, Office Supplies and Small Equipment, which funds are proposed to be used in 2016 to pay for the purchase of office supplies and small equipment; and,

**WHEREAS**, the Dodge County Finance Committee recommends that the Dodge County Board of Supervisors:

1. Authorize and direct the Dodge County Finance Director to carry over funds in the amount of \$3,500 in the 2015 Budget for the Dodge County Clerk in Business Unit 1204, Elections, Account No. .5313, Ballot Printing and Duplication, and transfer these funds in the amount of \$3,500 to Business Unit 1204, Elections, Account No. .5312, Office Supplies and Small Equipment, to be used in 2016 to pay for the purchase of office supplies and small equipment; and,

**SO, NOW, THEREFORE, BE IT RESOLVED**, that the Dodge County Board of Supervisors hereby:

1. Authorizes and directs the Dodge County Finance Director to carry over funds in the amount of \$3,500 in the 2015 Budget for the Dodge County Clerk in Business Unit 1204, Elections, Account No. .5313, Ballot Printing and Duplication, to the 2016 Budget for the Dodge County Clerk, and transfer these funds in the amount of \$3,500 to Business Unit 1204, Elections, Account No. .5312, Office Supplies and Small Equipment, to be used in 2016 to pay for the purchase of office supplies and small equipment.

All of which is respectfully submitted this 17th day of February, 2016.

**Dodge County Finance Committee:**

  
David Frohling

  
Gerald Adelmeyer

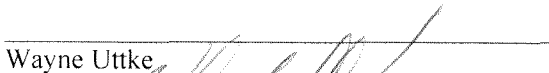
Wayne Uttke  

  
Thomas Schaefer

  
Phillip Gohr

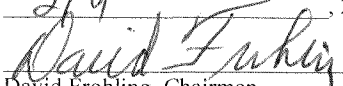
<p><b>FISCAL NOTE:</b> Is the referenced expenditure included in the adopted 2016 Budget? Yes or <input checked="" type="checkbox"/> No</p> <p>Fiscal Impact on the adopted 2016 Budget: \$ <u>3500</u></p> <p>Fiscal Impact reviewed by the Dodge County Finance Committee on <u>2/9</u>, 2016.  David Frohling, Chairman Dodge County Finance Committee</p>
--

ADOPTED  
BY DODGE COUNTY BOARD

FEB 17 2016

AYES 29 NOES 0  
ABSENT 3  
ABSTAIN 0

  
Karen J. Gibson  
County Clerk

RESOLUTION NO. 15-82

TO THE HONORABLE BOARD OF SUPERVISORS OF DODGE COUNTY, WISCONSIN MEMBERS:

**WHEREAS**, there are funds in the amount of \$25,000 in the 2015 Budget for the Dodge County Physical Facilities Maintenance Department (Maintenance Department) in Business Unit 2901, Courts Building Maintenance, which funds were appropriated for the purpose of paying for the installation of an air conditioner in Room B010 in the basement of the Dodge County Courthouse, available to carry over to the 2016 Budget for the Physical Facilities Maintenance Department, and available for transfer to Business Unit 1903, Legal Services Building, which funds are proposed to be used in 2016 to pay costs associated with the installation of two air conditioning units in the Dodge County Legal Services Building; and,

**WHEREAS**, there are funds in the amount of \$7,810 in the 2015 Budget for the Maintenance Department in Business Unit 2901, Courts Building Maintenance, which funds were appropriated for the purpose of paying for pipe insulation at the Dodge County Courthouse, available to carry over to the 2016 Budget for the Maintenance Department, which funds are proposed to be used in 2016 to pay for the removal and replacement of countertops in the Courtroom of Branch I of the Dodge County Circuit Court; and,

**WHEREAS**, the Dodge County Finance Committee recommends that the Dodge County Board of Supervisors:

1. Authorize and direct the Dodge County Finance Director to carry over funds in the amount of \$25,000 in the 2015 Budget for the Maintenance Department in Business Unit 2901, Courts Building Maintenance, to the 2016 Budget for the Maintenance Department, and to transfer these funds in the amount of \$25,000 to Business Unit 1903, Legal Services Building, to be used in 2016 to pay costs associated with the installation of two air conditioning units in the Legal Services Building; and,
2. Authorize and direct the Finance Director to carry over funds in the amount of \$7,810 in the 2015 Budget for the Maintenance Department in Business Unit 2901, Courts Building Maintenance, to the 2016 Budget for the Maintenance Department, to be used in 2016 to pay for the removal and replacement of countertops in the Courtroom of Branch I of the Dodge County Circuit Court;

**SO, NOW, THEREFORE, BE IT RESOLVED**, that the Dodge County Board of Supervisors hereby:

1. Authorizes and directs the Dodge County Finance Director to carry over funds in the amount of \$25,000 in the 2015 Budget for the Dodge County Physical Facilities Maintenance Department (Maintenance Department) in Business Unit 2901, Courts Building Maintenance, to the 2016 Budget for the Maintenance Department, and to transfer these funds in the amount of \$25,000 to Business Unit 1903, Legal Services Building, to be used in 2016 to pay costs associated with the installation of two air conditioning units in the Dodge County Legal Services Building; and,



- 2. Authorizes and directs the Finance Director to carry over funds in the amount of \$7,810 in the 2015 Budget for the Maintenance Department in Business Unit 2901, Courts Building Maintenance, to the 2016 Budget for the Maintenance Department, to be used in 2016 to pay for the removal and replacement of countertops in the Courtroom of Branch I of the Dodge County Circuit Court.

All of which is respectfully submitted this 17th day of February, 2016.

**Dodge County Finance Committee:**

  
 \_\_\_\_\_  
 David Frohling

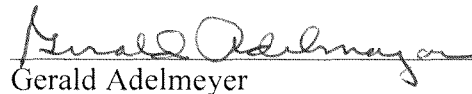
  
 \_\_\_\_\_  
 Gerald Adelmeyer

Wayne Uttke

  
 \_\_\_\_\_  
 Thomas Schaefer

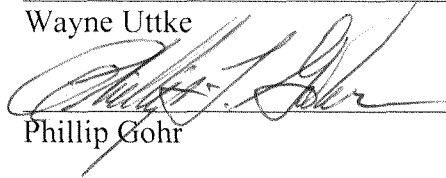
  
 \_\_\_\_\_  
 Phillip Gohr

**FISCAL NOTE:**

Is the referenced expenditure included in the adopted 2016 Budget? \_\_\_\_\_ Yes or X No

Fiscal Impact on the adopted 2016 Budget:

\$ 32810

Fiscal Impact reviewed by the Dodge County Finance Committee on 2/9, 2016.

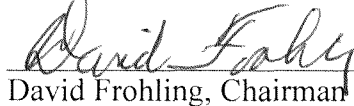
  
 \_\_\_\_\_  
 David Frohling, Chairman

Dodge County Finance Committee

BY DODGE COUNTY BOARD

FEB 17 2016

AYES 28 NOES 1  
 ABSENT 3  
 ABSTAIN 0

  
 Karen J. Gibson  
 County Clerk

RESOLUTION NO. 15-83

TO THE HONORABLE BOARD OF SUPERVISORS OF DODGE COUNTY, WISCONSIN MEMBERS,

**WHEREAS**, the Dodge County Finance Committee has set forth in a document entitled *Requests To Carry Over Funds From Budget Year 2015 To Budget Year 2016*, a list of requests that it has recently received from department heads/managers/directors to carry over unexpended funds and related revenues from Budget Year 2015 to Budget Year 2016; and,

**WHEREAS**, a copy of the document entitled *Requests To Carry Over Funds From Budget Year 2015 To Budget Year 2016*, has been marked for identification as Exhibit "A", and has been attached hereto; and,

**WHEREAS**, in connection with each of these requests by department heads/managers/directors to carry over funds, the Finance Committee has:

1. Confirmed with the department heads/managers/directors that the funds will be used in Fiscal Year 2016 for the same purpose or purposes for which the funds were originally appropriated;
2. Received a recommendation from the committee of jurisdiction of each department that has made a request; and,
3. Received a recommendation from the county administrator; and,

**WHEREAS**, the Finance Committee has considered the requests by department heads/managers/directors, the recommendations of the committees of jurisdiction and the recommendations of the county administrator, and has formed the considered conclusion that it is in the best interests of Dodge County for the Dodge County Board of Supervisors to carry over funds from Budget Year 2015 to Budget Year 2016, as requested;

**SO, NOW, THEREFORE, BE IT RESOLVED**, that the Dodge County Board of Supervisors hereby:

1. Carries over funds from the 2015 Dodge County Budget, from those business units and in those amounts set forth in Exhibit "A", attached hereto, in a total amount of \$596,234, and appropriates those funds to the 2016 Dodge County Budget;
2. Appropriates to the 2016 Dodge County Budget the funding necessary to cover the carry over expenditures by appropriating to the 2016 Dodge County Budget the related 2015 fund balances in the amount of \$596,234; and,
3. Authorizes and directs the Dodge County Finance Director to make all necessary adjustments to the 2016 Dodge County Budget arising from the adoption of this Resolution by the Dodge County Board of Supervisors.

All of which is respectfully submitted this 17th day of February, 2016.

Dodge County Finance Committee:

David Frohling  
David Frohling

Gerald Adelmeyer  
Gerald Adelmeyer

Wayne Uttke  
Phillip Gohr  
Phillip Gohr

Thomas J. Schaefer  
Thomas J. Schaefer

**FISCAL NOTE:**

Is the referenced expenditure included in the adopted 2016 Budget? Yes or  No

Fiscal Impact on the adopted 2016 Budget:  
\$ + 596234-

Fiscal Impact reviewed by the Dodge County Finance Committee on 2/9, 2016.

David Frohling  
David Frohling, Chairman  
Dodge County Finance Committee

ADOPTED  
BY DODGE COUNTY BOARD

FEB 17 2016

AYES 29 NOES 0  
ABSENT 3  
ABSTAIN 0

Raren J. Silson  
County Clerk

## Requests To Carry Over Funds from Budget Year 2015 to Budget Year 2016

1. Human Services and Health				
Business Unit	Original Amount	Carryover Amount	Project/Specific Purpose	Justification
A. 4855	\$ 194,212	100,962	Netsmart Technologies myEvolv software	County Board resolution 15-29 allocated this funding. We are in the midst of software implementation to be completed in 2016

2. Information Technology				
Business Unit	Original Amount	Carryover Amount	Project/Specific Purpose	Justification
A. 1811	\$ 40,000	\$ 30,000	F5 Load Balancer	Project was started late in the year and is not completed.
B. 1811	\$138,200	\$27,000	Ironport / Firewall replacement	Devices are installed and paid for but engineering fees were withheld until a bug is fixed. Fix is expected April 2016.

3. Land Resources and Parks				
Business Unit	Original Amount	Carryover Amount	Project/Specific Purpose	Justification
A. 7863	\$ 6,000	\$ 6,000	Harnischfeger Park - North Pavilion Concrete	Pavilion needs to be moved to better soils/higher ground for increased longevity and use. Working around park reservations, activities & contractor schedule prevented work from getting done.
B. 7865	\$79,509	\$ 57,476	Astico Park - Danville Camping Area Rehab	Permitting and scheduling delays were further disrupted with the wind storm damage and clean up. Some of the work was started prior to snowfall in December by Hwy Dept.
C. 7866	\$2,000	\$ 2,000	Derge Park - Replace a collapsing culvert	Water regulation permitting delayed the project and then lack of sufficient ground freeze before the snow cover prevented work at end of the year
D. 811	\$180,000	\$ 60,000	Land Information Management System Software (LIMS)	Implementation of new land information management system to integrate land records (tax, assessment, public access, permits) was not completed in 2015 as anticipated; will be completed in 2016

4.

<b>Sheriff</b>				
Business Unit	Original Amount	Carryover Amount	Project/Specific Purpose	Justification
A. 2032	\$ 89,206	\$ 89,206	Radio Communication dispatch console	Delivery and installation changed to the early months of 2016

5.

<b>County Building/Maintenance</b>				
Business Unit	Original Amount	Carryover Amount	Project/Specific Purpose	Justification
A. 1901	\$10,000	\$10,000	Boulevards on the Hwy 26 side of the Administration Building	Numerous options are being considered to make sure it's done right and acceptable to the City of Juneau
B. 1905	\$11,000	\$4,745	Henry Dodge Office Building Thermostats	Purchased the amount that our staff had time to do last year, sent some of the old ones in for repairs for cost savings. Will need to purchase more this year.
C. 1905	\$375,000	\$173,620	Henry Dodge Office Building Air Conditioner Replacement	Project started last fall not finished will be working to finish for 2016 cooling season
D. 1906	\$1,000	\$1,000	Motorola Radio	Replaced non- functioning radio's in 2015. Budgeted for 9 in 2016 but can get a discount if we purchase quantity of 10 because of special promotion.
E. 2901	\$22,000	\$22,000	Courthouse Flooring	Had other projects going on didn't have staff to commit to do this project in the Courthouse last year.
F. 2902	\$10,000	\$6,810	Jail Counter Top Replacement	Do to Security Electronics' Project starting in 2016 the counter tops could not be repaired until all new equipment is installed on them.
G. 2902	\$6,000	\$5,415	Jail Counter Top Replacement	Do to Security Electronics' Project starting in 2016 the counter tops could not be repaired until all new equipment is installed on them.

**Total Amount of Funds Requested to be Carried Over:**

**\$ 596,234**

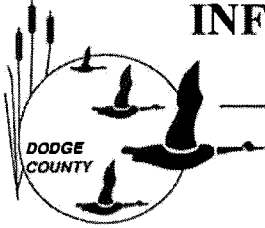

# INFORMATION TECHNOLOGY DEPARTMENT

Ruth M. Otto, Director

127 East Oak Street, Juneau, WI 53039 • (920) 383 – 3940

## MEMORANDUM

Date: January 27, 2016

To: Finance Committee

From: Ruth M. Otto, Director of Information Technology *AMO*

Re: Carry over of funds from 2015 to 2016 budget years

### **Load Balancer project**

A 2015 project for the network is a load balancer, a device that supports the service of two Internet Service Providers to ensure service is available at all times as well as handling the balancing of email servers to provide redundancy. The project was started but is not at completion. A balance of \$30,000 is remaining on the project.

### **Firewall and Web Security project**

A 2015 project for the network was installing new firewalls and web security appliances to replace end-of-life units. The physical devices were installed and paid for but a substantial portion of the engineering fees have been held until a fix is applied to the devices to fix a known bug. This fix was originally expected in December but has since been rescheduled for availability for April. The engineering fees total \$27,000.

Both projects will be completed in 2016. It is requested to carry over a total of \$57,000 to cover the expenses of these two projects. \$30,000 from 1811.5818 and \$27,000 from 1811.5249.

Dodge County Land Information Committee  
Dodge County Planning, Development and Parks Committee

Administration Building  
127 East Oak Street Juneau, WI 53039

---

DATE: December 9, 2015  
TO: Finance Committee  
Julie Kolp, Finance Director  
FROM: Joyce Fiacco, Director, Land Resources and Parks Department  
RE: Request for 2015 Carry Forward Requests

---

Several Land Resources and Parks Department projects planned and budgeted for in 2015 are not anticipated to be completed by year end. Completion of these projects in 2016 will require Finance Committee approval for these funds from the 2015 budget to be carried forward. The projects, Business Units, accounts, and requested carryover amounts are:

**Harnischfeger Park: (7863.5823): \$6,000** for the north pavilion concrete work. We have determined that replacement of the concrete floor in the current location is not recommended due to poor, wet soil conditions. The plan now is to move the pavilion about 100 feet to the south to higher ground (volleyball court area) with a new concrete floor. Working around park reservations, events and contractor schedules delayed the project and we are unlikely to get it complete before the end of the year.

**Astico Park: (7865.5823): \$75,744** for the Danville camping area rehab project (Sales Tax funded project): This amount includes \$15,744 of carryover funds from 2014. Some unanticipated floodplain issues postponed the project into 2015. The windstorm of July delayed efforts on this project further. The road reconstruction work above the floodplain elevation is scheduled for next week utilizing Hwy Department crews, pending weather conditions. Completion of the remaining portion of the project in the area of the floodplain is unlikely to get cleared for construction this year. It is likely we will have to do a full Floodplain study before getting clearance. My best guess is that we will expend \$10,000 - \$15,000 this year and need the balance carried over.

**Derge Park (7866.5233): \$2,000** to replace a collapsing culvert. A Conditional Use Permit hearing is scheduled for December 7<sup>th</sup> and a Hwy Department crew is waiting in the wings to do the work – weather dependent. Carryover may or may not be necessary.

**Land Information Office (811.5818- Computer Equipment): \$60,000** for Software and Implementation Services for an integrated Land Information Management System. It has been determined that completion of all phases of this project will not be accomplished in 2015 due to delays resulting from initial data conversion and testing, and system integration with several critical third party/agency applications (TriMin, File Director, ADC-GIS Web Mapping Tool, and Department of Revenue transfer return form). It is anticipated that funds will be needed for additional professional services and custom programming.

These requests were presented to and recommendations of support were received from the Land Information Committee Friday, November 13<sup>th</sup>, 2015 and the Planning, Development & Parks Committee Monday, December 7<sup>th</sup>.

Thank you for your consideration of this request from the Land Resources and Parks Department.



# DODGE COUNTY SHERIFF'S OFFICE

Dale J Schmidt Sheriff   Scott Smith Chief Deputy

November 19, 2015

## MEMORANDUM

**TO:** Law Enforcement Committee, Finance Committee, Dodge County Board of Supervisors, County Administrator James Mielke, Finance Director Julie Kolp

**From:** Scott Smith, Chief Deputy

**RE: 2015 Budget Carry Over Request**

---

The October, 2015 session of the Dodge County Board of Supervisors approved Resolution 15-47 authorizing payment of invoices in a total amount not to exceed \$89,205.85, and representing the costs of the purchase of a new radio communications dispatch console from Communications Service Wisconsin, LLC.

The approved cost associated with this purchase was contingent upon purchase of this system by November 21, 2015; the order for this equipment has been finalized and the discount applied based upon that timely order prior to November 21, 2015.

Any payment of these approved funds is considered contingent upon receipt and installation of that radio system by the vendor (Communications Service Wisconsin, LLC). At this time, the vendor has not been able to establish a delivery and installation time; informal feedback indicates that delivery and installation may not occur until early months of 2016.

Therefore, I request carry-over of these budgeted funds (\$89,205.85) to FY2016 with anticipated date of any invoice in first quarter of 2016.

Respectfully,

A handwritten signature in black ink, appearing to read "SS", written over a faint horizontal line.

Scott Smith, Chief Deputy

Cc: Sheriff D Schmidt



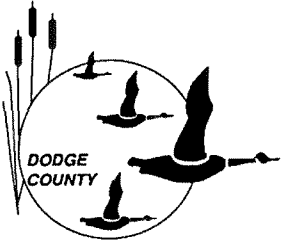

## Dodge County Maintenance Dept.

Physical Facilities  
127 E. Oak Street  
Juneau, WI 53039-1329  
(920) 386-3665 FAX: (920) 386-3264

Russ Freber  
Director

**DATE: January 27, 2016**

**TO: Dodge County Finance Committee**

**From: Russell Freber**

**RE Re-appropriate and carry over funds from budget 2015 to budget 2016**

The Dodge County Physical Facilities Department is respectfully requesting a re-appropriation and carry over funds from budget year 2015 to budget year 2016. Below is a list of re-appropriations and carry over fund requests.

**Re-appropriate** funds from Business Unit 2901 in the amount of \$25,000 from saving of Air Conditioner Project in room BO10 in the Dodge County Courthouse to Business Unit 2903.5829 Other Capital Improvements for the installation of new air conditioning units located in the IT server rooms at the Dodge County Legal Service Building.

**Re-appropriate** funds from Business Unit 1901.5822 Buildings \$7,810.00 for pipe insulation to Business Unit 2901.5929 Other Capital Improvements for new counter tops in Branch 1 Courtroom.

**Carry over** funds from Business Unit 1901.5821 Land \$10,000 for work on Boulevards at the Dodge County Administration Building

**Carry over** funds from Business Unit 1905. 5822 Buildings \$4,745.00 for purchase of thermostats at the Dodge County Henry Dodge Office Building.

**Carry over** funds from Business Unit 1905.5829 Other Capital Improvements \$173,620.00 for the Dodge County Henry Dodge Office Building Air Conditioner Replacement Project.

**Carry over** funds from Business Unit 1906.5819 Other Capital Equipment \$1,000.00 for purchase of a Motorola radio.

**Carry over** funds from Business Unit 2901. 5829 \$22,000.00 Other Capital Improvements for replacement of flooring at the Dodge County Courthouse.

**Carry over** funds from Business Unit 2902.5822 Buildings \$6,810.00 for counter top replacement in the Dodge County Detention Facility.

**Carry over** funds from Business Unit 2902.5929 Other Capital Improvements \$5,415.00 for counter top replacement in the Dodge County Detention Facility.

Free to contact me with any questions regarding these requests.

Sincerely,

Russell Freber  
Dodge County Physical Facilities Director

RESOLUTION NO. 15-84

TO THE HONORABLE BOARD OF SUPERVISORS OF DODGE COUNTY, WISCONSIN MEMBERS:

**WHEREAS**, the Dodge County Building Committee has considered the equipment needs of Dodge County and has determined that it is necessary to purchase a new Gehl R135 skid loader with accessories, and a snow brush, snow blower, forks, and bucket; and,

**WHEREAS**, the Building Committee has obtained a quotation for the purchase of these items of equipment from Waupun Equipment Co., Inc., N9695 Frohling Lane, Watertown, Wisconsin (Waupun Equipment Co., Inc.), in the amount of \$32,500, less a trade-in allowance of \$16,000, for a 2005 Model Year 4410 John Deere tractor with attachments (mower deck, snow brush, snow blower, and loader with bucket and forks), and a quotation for the purchase of these items of equipment from Farmers' Implement, LLC, 1200 Maple Avenue, Columbus, Wisconsin (Farmers' Implement, LLC), in the amount of \$38,875, less a trade-in allowance of \$15,000, for a 2005 Model Year 4410 John Deere tractor with attachments (mower deck, snow brush, snow blower, and loader with bucket and forks); and,

**WHEREAS**, a copy of the quotation submitted by Waupun Equipment Co., Inc., has been marked for identification as Exhibit "A", and has been attached hereto; and,

**WHEREAS**, a copy of the quotation submitted by Farmers' Implement, LLC, has been marked for identification as Exhibit "B", and has been attached hereto; and,

**WHEREAS**, the quotation for these items of equipment most advantageous to Dodge County is the quotation received from Waupun Equipment Co., Inc., in the amount of \$32,500, less a trade-in allowance of \$16,000, for a 2005 Model Year 4410 John Deere tractor with attachments as set forth above; and,

**WHEREAS**, monies sufficient for the purchase of these items of equipment are included in the 2016 Budget for the Dodge County Physical Facilities Department, in Business Unit 1901, County Buildings, Account No. .5819, Other Capital Equipment;

**SO, NOW, THEREFORE, BE IT RESOLVED**, that the Dodge County Board of Supervisors hereby approves and accepts the quotation from Waupun Equipment Co., Inc., N9695 Frohling Lane, Watertown, Wisconsin (Waupun Equipment Co., Inc.), in the amount of \$32,500, less a trade-in allowance of \$16,000, for a 2005 Model Year 4410 John Deere tractor with attachments (mower deck, snow brush, snow blower, and loader with bucket and forks), for the purchase of a new Gehl R135 skid loader with accessories, and a snow brush, snow blower, forks, and bucket, and hereby authorizes and directs the Dodge County Physical Facilities Director, on behalf of the Dodge County Building Committee, to purchase these items of equipment; and,

**BE IT FINALLY RESOLVED**, that upon presentation to the Dodge County Clerk of an invoice properly approved by the Dodge County Physical Facilities Director, in the amount of \$16,500 (\$32,500 purchase price less trade-in allowance of \$16,000 equals \$16,500), representing the purchase of a new Gehl R135 skid loader with accessories, and a snow brush, snow blower, forks, and bucket, from Waupun Equipment Co., Inc., the County Clerk is hereby authorized and directed to issue an order on the Dodge County Treasurer for payment for such invoice, and that funds for payment for such invoice shall come from Business Unit 1901, County Buildings, Account No. .5819, Other Capital Equipment.

All of which is respectfully submitted this 17th day of February, 2016.

**Dodge County Building Committee:**

Rodger Mattson  
Rodger Mattson

Mark Roesch  
Mark Roesch

Chester Caine

Thomas Nickel  
Thomas Nickel

Dennis Schmidt  
Dennis Schmidt

<p><b>FISCAL NOTE:</b> Is the referenced expenditure included in the adopted 2016 Budget? <input checked="" type="checkbox"/> Yes or <input type="checkbox"/> No</p> <p>Fiscal Impact on the adopted 2016 Budget: \$ <u>0</u></p> <p>Fiscal Impact reviewed by the Dodge County Finance Committee on <u>2/9</u>, 2016.</p> <p><u>David Frohling</u> David Frohling, Chairman Dodge County Finance Committee</p>
---

ADOPTED BY THE BOARD OF SUPERVISORS

FEB 17 2016

AYES	<u>29</u>	NOES	<u>0</u>
ABSENT	<u>3</u>		
ABSTAIN	<u>0</u>		

Raren J. Silson  
County Clerk



November 18, 2015

Dodge County

\$40,314<sup>00</sup>

Gehl R135 Skid loader  
 T-Bar / Cab w/Heat  
 Power Tach / Air suspension seat  
 Counter weight / Self leveling  
 Block Heater / 27.5 x 10 x 15 Tires  
 Back up Alarm / Radio / Rotating  
 Beacon / 60" Bucket. Berlow

Sell @ \$23,100<sup>00</sup>

CE Attachment's  
 Broom 40 inch w/ Hydraulic Angle

\$5,000<sup>00</sup>

CE Attachment  
 Snowblower 40 inch

\$1925<sup>00</sup>

Berlow  
 48 inch Pallet Forks

\$650<sup>00</sup>

Total Price \$32,500<sup>00</sup>  
 16,000.00 Trade-in  
 \$16,500<sup>00</sup> Sell w/Trade's

Will do lease of Power Box Every Year  
 AFTER 1<sup>st</sup> Buy For \$1000<sup>00</sup> a year!  
 You Keep Attachments + Tires.

Salesman  
 Jerry Quinto

**SALES QUOTATION**  
**FARMERS' IMPLEMENT, LLC**  
**1200 MAPLE AVE. COLUMBUS, WI 53925**  
**(262) 629-4104 (800) 729-0199 FAX: (262) 629-4030**

Date: **3/31/2015**

Customer Name: **DODGE COUNTY PHYSICAL FACILITIES** Quote Valid for: \_\_\_\_\_ Days

Address: **127 EAST OAK STREET** Customer Phone: **920-386-3665 (RUSS)**

City: **JUNEAU** State: **WI** Zip Code: **54009**

Salesman: **John Raemisch** CELL (608)-220-6169

DESCRIPTION		PRICE (\$)
R135 GEHL SKID STEER		
CAB HEAT AIR RIDE SEAT POWER A TACH SWITCHABLE SELF LEVELING		
REAR COUNTER WEIGHT BACK UP ALARM ENGINE BLOCK HEATER		
AM-FW-WB RADIO ROTATING BEACON SOUND REDUCTION PACKAGE		
10.00 X 16.5 8-PLY TITAN HD TIRES SEAT BELT DOOR SAFETY SWITCH		
Pallet Forks MANUFACTURE LOFTLAN		
BUCKET 60in MANUFACTURE VIRNIG		
SNOW BLOWER 60in MANUFACTURE IS FFC/SWEEPSTER		
BROOM W/HYD ANGLE KIT 60in MANUFACTURE IS SWEEPSTER <i>SB 72 50 poly/50</i>		<i>71.15h</i>
<i>Broom - hydraulic angle complete harness</i>		<i>AB 60 poly/50</i>
TOTAL LIST PRICE		\$56,463.00
MUN. DISCOUNT		\$17,563.00
We will trade the base machine for \$7.00 per hour on a yearly schedule.		
We will not be able to trade if the machine is ordered with hand and foot controls		
because of the resale ability of the controls.		
<b>TOTAL SELLING PRICE</b>		<b>\$ 38,875.00</b>
TRADE-IN		TRADE ALLOWANCE
JOHN DEERE 4410 W/ COZY CAB		
PALLET FORKS 60" BROOM 59" SNOW BLOWER		
72" BUCKET GRILL GUARD 72" MOWER DECK		
WEIGHT BOX 430 LOADER		
<b>TRADE ALLOWANCE</b>		<b>\$ 15,000.00</b>
<b>TOTAL DIFFERENCE</b>		<b>\$ 23,875.00</b>

RESOLUTION NO. 15-85AUTHORITY TO PURCHASE EQUIPMENT

TO THE HONORABLE BOARD OF SUPERVISORS OF DODGE COUNTY, WISCONSIN

Members:

WHEREAS, the following quotations were received for an equipment package consisting of one new 2016 rubber tire skid steer loader, one new 2016 rubber track skid steer loader, and one new 2016 rubber track mini excavator with annual exchange and buyback options to be considered:

<u>VENDOR</u>	<u>PACKAGE PRICE</u>	
Aring Equipment Company	\$154,500.00	Does not meet specs
Bobcat Plus	No Quotation	
Fabick CAT	\$200,500.00	
Farmers' Implement, LLC	\$155,600.00	Does not meet specs
L. F. George, Inc.	\$181,581.00	Does not meet specs
Mid-State Equipment	\$148,264.13	Does not meet specs
Mid-State Equipment	\$135,881.83	Does not meet specs
Miller-Bradford & Risberg	\$184,020.00	Does not meet specs
Service Motor Company	\$182,158.00	Does not meet specs
Service Motor Company	\$175,687.00	Does not meet specs
St. Lawrence Equipment, Inc.	\$145,000.00	Does not meet specs

WHEREAS, the quotation received from Fabick CAT meets the specifications and is in the best interest of Dodge County, and

WHEREAS, such authority to purchase must be granted by the County Board of Supervisors in accordance with Resolution No. 14-17 adopted at the May 20, 2014 County Board Session, and

WHEREAS, funds for the purchase of this equipment package are included in the 2016 Highway Department Budget.

THEREFORE BE IT RESOLVED, that the Highway Committee is hereby authorized to purchase one equipment package consisting of one new 2016 rubber tire skid steer loader, one

new 2016 rubber track skid steer loader, and one new 2016 rubber track mini excavator from Fabick CAT in the amount of \$200,500.00.

THEREFORE BE IT FURTHER RESOLVED, that the purchase cost is to be charged to Acquisition of Capital Assets, Account Number 3281.

All of which is respectfully submitted this 17<sup>th</sup> day of February, 2016.

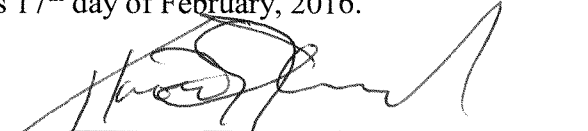
  
Harold J. Johnson - Chairman

Vote on Foregoing Resolution

Ayes 29 Noes 0 Absent 3

Adopted 2-17-16  
RESOLUTION

  
COUNTY CLERK

Chester Caine, Vice Chairman

  
Randy Grebel - Secretary

  
Jeff Berres

  
William T. Muche

DODGE COUNTY HIGHWAY  
COMMITTEE

**FISCAL NOTE:**

Is the referenced expenditure included in the adopted 2016 Budget? X Yes or \_\_\_\_\_ No

Fiscal Impact on the adopted 2016 Budget:  
\$ 0

Fiscal Impact reviewed by the Dodge County Finance Committee on 2/9, 2016.

  
David Frohling, Chairman  
Dodge County Finance Committee

RESOLUTION NO. 15-86

AUTHORITY TO PURCHASE ONE

TWIN PUMP CRACKFILLING MELTER/APPLICATOR

TO THE HONORABLE BOARD OF SUPERVISORS OF DODGE COUNTY, WISCONSIN

Members:

WHEREAS, it is the opinion of the Highway Committee that the Highway Department pavement maintenance fleet should be upgraded through the replacement of one new twin pump crackfilling melter/applicator to better meet the demands of the Department, and

WHEREAS, the Highway Department received a quotation for one twin pump crackfilling melter/applicator Crafc Model #1500 from Sherwin Industries, and

WHEREAS, Crafc is the only vendor that makes a twin pump crackfilling melter/applicator, and

WHEREAS, the Highway Committee has determined the quotation from Sherwin Industries is in the best interest of Dodge County, and

WHEREAS, this unit will replace a 17-year-old Crafc melter/applicator that will be sold at auction when the replacement unit is put into service, and

WHEREAS, such authority to purchase must be granted by the County Board of Supervisors in accordance with Resolution No. 14-17 adopted at the May 20, 2014 County Board Session, and

WHEREAS, funds for the purchase of this unit are included in the 2016 Highway Department Budget.



THEREFORE BE IT RESOLVED, the Dodge County Board of Supervisors does hereby approve the purchase of one 2016 Crafc0 Model #1500 twin pump melter/applicator from Sherwin Industries in the amount of \$90,569.59.

THEREFORE BE IT FURTHER RESOLVED, that the purchase cost of this twin pump melter/applicator shall be charged to Business Unit 3281, Capital Asset Acquisition.

All of which is respectfully submitted this 17th day of February, 2016,

  
Harold J. Johnson - Chairman

Vote on Foregoing Resolution

Ayes 29 Noes 0 Absent 3

Adopted 2-17-16  
RESOLUTION

Karen J. Gibson  
COUNTY CLERK

Chester Caine - Vice Chairman

  
Randy Grebel - Secretary

  
Jeff Berres

William T. Muche  
William T. Muche

DODGE COUNTY HIGHWAY  
COMMITTEE

**FISCAL NOTE:**

Is the referenced expenditure included in the adopted 2016 Budget? X Yes or \_\_\_\_\_ No

Fiscal Impact on the adopted 2016 Budget:  
\$ 0

Fiscal Impact reviewed by the Dodge County Finance Committee on 2/19, 2016.

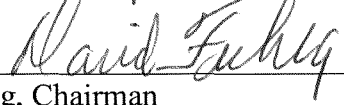
  
David Frohling, Chairman  
Dodge County Finance Committee

REPORT 1

TO THE HONORABLE DODGE COUNTY BOARD OF SUPERVISORS

We, the Dodge County Planning, Development and Parks Committee, hereby report favorably on the petition of Patrick and Shelley Tighe requesting amendment of the Land Use Code, Dodge County, Wisconsin, to rezone approximately 60-acres of land from an A-1 Prime Agricultural Zoning District to an A-2 General Agricultural Zoning District in part of the NE ¼, SE ¼, and part of the SE ¼, NE ¼, Section 17, Town of Lomira for the purpose of creating three lots at this location and recommend adoption of the attached ordinance.

The committee has reviewed and considered the facts presented in the application and received at the public hearing and finds that the criteria listed in Section 2.3.4.1 of the Dodge County Land Use Code can be met for this proposal. The committee finds that the proposal is substantially consistent with the Dodge County Comprehensive and Farmland Preservation Plans and is consistent with the stated purposes of the Dodge County Land Use Code. The committee finds that the proposal will not result in significant adverse impacts upon the surrounding properties or the natural environment and further finds that the land proposed for rezoning is suitable for development and will not cause unreasonable soil erosion or have an unreasonable adverse effect on rare or irreplaceable natural areas. The committee finds that the proposal will not significantly impair or limit current or future agricultural use of the adjacent properties. The committee finds that the proposal will not be used to legitimize or spot zone a nonconforming use or structure and finds that the rezoning is the minimum action necessary to accomplish the intent of the petition.

Respectfully submitted this 18<sup>th</sup> day of January, 2016.

RESOLVED BY THE DODGE COUNTY BOARD

FEB 11 2016  
AYES 29  
ABSENT 3  
ABSTAIN 0

adopted - 2-17-16  
Karen J. Gibson  
County Clerk

Tom Schaefer  
Tom Schaefer

Allen Behl  
Allen Behl

Randy Grebel  
Randy Grebel

Joseph Marsik  
Joseph Marsik

Janice Bobholz  
Janice Bobholz

Planning, Development and Parks Committee

Ordinance No. 948

An ordinance amending the Land Use Code, Dodge County, Wisconsin by placing certain lands in Section 17, T13N, R17E, Town of Lomira, in the A-2 General Agricultural zoning district.

Whereas the subject matter of this ordinance has been duly referred to and considered by the Dodge County Planning, Development and Parks Committee and a public hearing having been held, after the giving of requisite notice of said hearing and a recommendation thereon having been reported to the Board of Supervisors, Dodge County, Wisconsin as required by Section 59.69 of the Wisconsin Statutes.

Whereas the Dodge County Planning, Development and Parks Committee has reviewed and considered the facts presented in the application and received at the public hearing relating to the subject matter of this ordinance for compliance with the criteria listed in Section 2.3.4.1 of the Dodge County Land Use Code.

Whereas the Dodge County Planning, Development and Parks Committee has found that the criteria listed in Section 2.3.4.1 of the Dodge County Land Use Code can be met for this proposal and has further found that the proposal is substantially consistent with the Dodge County Comprehensive and Farmland Preservation Plan and the stated purposes of the Dodge County Land Use Code. Furthermore, this Committee has found that the proposal will not result in significant adverse impacts upon the surrounding properties or the natural environment, that the land proposed for rezoning is suitable for development and will not have an unreasonable effect on rare or irreplaceable natural resources, that the proposal will not significantly impair or limit current or future agricultural use of the adjacent properties, be used to legitimize or spot zone a nonconforming use or structure and that the rezoning petition is the minimum action necessary to accomplish the intent of the petition.

The County Board of Supervisors of the County of Dodge do ordain as follows:

Section 1. The "official zoning map" adopted with the Land Use Code, Dodge County, Wisconsin on March 21, 2000 is hereby amended as shown on the map attached hereto and made part of this ordinance.

Section 2. This ordinance shall be effective upon passage.

Section 3. All ordinances or parts of ordinances inconsistent with or in contradiction of the provisions of this ordinance are hereby repealed.

Adopted and Approved this 17th day of February, 2016.

Russell Kottke  
Russell Kottke  
Chairman

Karen J. Gibson  
Karen J. Gibson  
County Clerk

# Patrick & Shelley Tighe Town of Lomira, Sec. 17

The data used to create this map is a compilation of records, information, and data from various city, county and state offices, and other sources. This map is only advisory, does not replace a survey, and may not be used for any legal purpose. Dodge County assumes no liability for any use or misuse of this information.

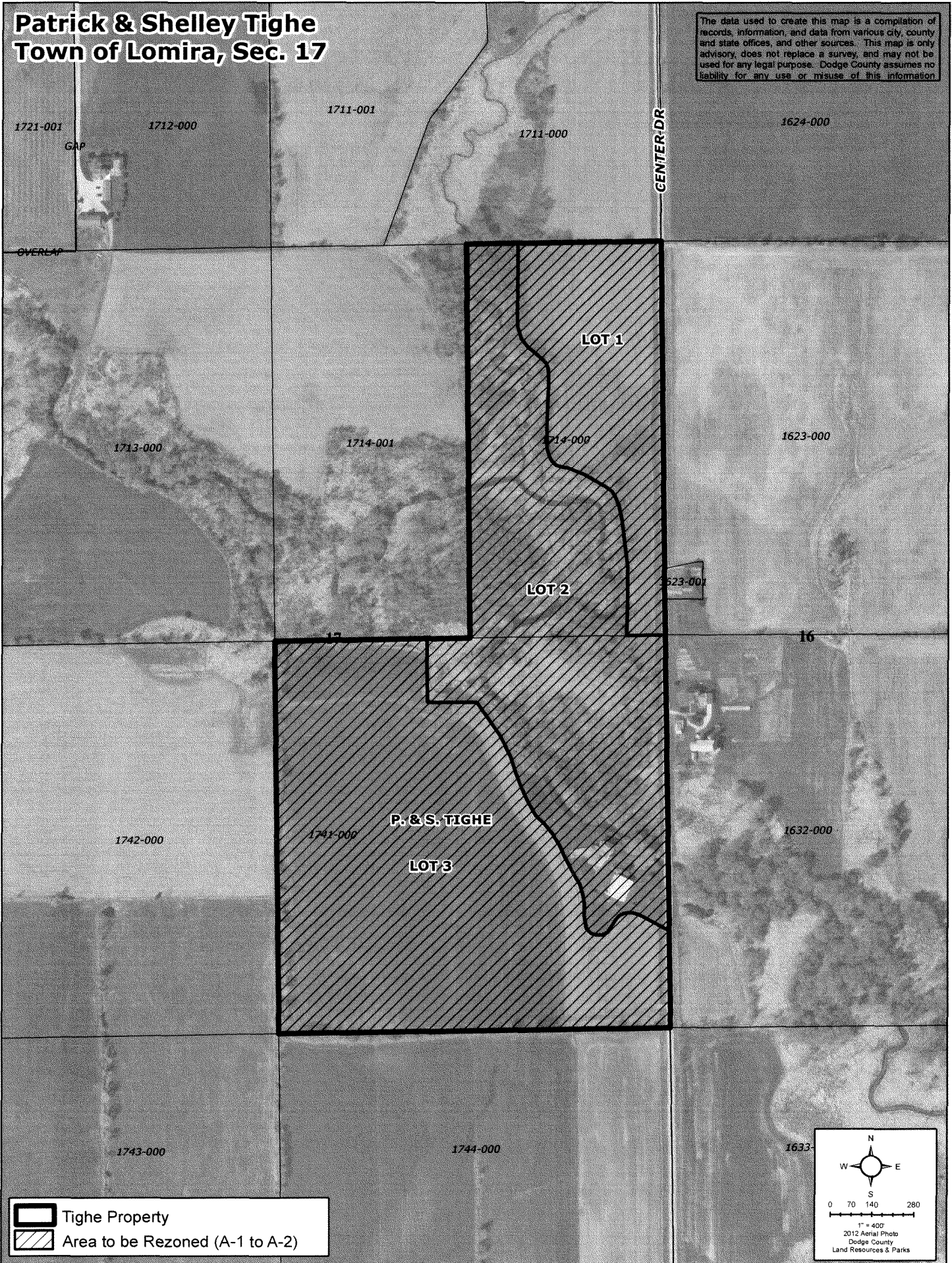

ORDINANCE NO. 949

AN ORDINANCE TO AUTHORIZE THE DODGE COUNTY TAXATION COMMITTEE TO WAIVE THE 0.5% PER MONTH PENALTY ON DELINQUENT GENERAL PROPERTY TAXES, SPECIAL ASSESSMENTS, SPECIAL CHARGES AND SPECIAL TAXES INCLUDED IN THE TAX ROLL

**WHEREAS**, the Dodge County Board of Supervisors (County Board) has delegated to the Dodge County Taxation Committee (Taxation Committee) many of its duties and responsibilities and much of its authority as set forth in Section 75.521, of the *Wisconsin Statutes*, entitled *Foreclosure of tax lien by action in rem*, and as set forth in Section 75.69, of the *Wisconsin Statutes*, entitled *Sale of tax delinquent real estate*; and,

**WHEREAS**, the Taxation Committee has formed the considered conclusion that it will be helpful to the Taxation Committee in carrying out its duties and responsibilities, and in exercising its authority, in connection with the foreclosure of tax liens by actions in rem and in connection with the sale of tax delinquent real estate, and, in the best interests of Dodge County, to be authorized by the County Board, to, in the exercise of the sole discretion of the Taxation Committee, waive payment to the Dodge County Treasurer, by the owner or owners of real property, of the accrued penalty, in the amount of 0.5% per month, or fraction of a month, on any delinquent general property taxes, special assessments, special charges and special taxes included in the tax roll, and owed to Dodge County; and,

**WHEREAS**, the Taxation Committee has formed the considered conclusion that, occasionally, under unique circumstances, in dealing with real property that is either included in a proceeding in rem to foreclose tax liens, or is likely to later become included in a proceeding in rem to foreclose tax liens, it would be in the best interests of Dodge County for the Taxation Committee to waive payment to the Dodge County Treasurer, by the owner or owners of real property, of the accrued penalty, in the amount of 0.5% per month, or fraction of a month, on any delinquent general property taxes, special assessments, special charges and special taxes included in the tax roll, and owed to Dodge County; and,

**WHEREAS**, therefore, the Taxation Committee requests the County Board to authorize the Taxation Committee, in the exercise of the sole discretion of the Taxation Committee, to waive payment to the Dodge County Treasurer, by the owner or owners of real property, of the accrued penalty, in the amount of 0.5% per month, or fraction of a month, on any delinquent general property taxes, special assessments, special charges and special taxes included in the tax roll, and owed to Dodge County;

**SO, NOW, THEREFORE,**

THE COUNTY BOARD OF SUPERVISORS OF THE COUNTY OF DODGE DOES ORDAIN AS FOLLOWS:

Section 1. Effective immediately, the Dodge County Board of Supervisors hereby authorizes the Dodge County Taxation Committee, in the exercise of the sole discretion of the Taxation Committee, to waive payment to the Dodge County Treasurer, by the owner or owners of real property, of the accrued penalty, in the amount of 0.5% per month, or fraction of a month, on any delinquent general property taxes, special assessments, special charges and special taxes included in the tax roll, and owed to Dodge County.

Section 2. This Ordinance shall be in full force and effect upon enactment and publication as required by law.

Respectfully submitted this 17th day of February, 2016.

**Dodge County Taxation Committee:**

Jeff Berres  
Jeff Berres

Dennis Schmidt  
Dennis Schmidt

Ed Nelson  
Ed Nelson

Allen Behl  
Allen Behl

Rodger Mattson  
Rodger Mattson

Approved and enacted this 17th day of February, 2016.

Russell Kottke  
Russell Kottke, Chairman  
Dodge County Board of Supervisors

Karen J. Gibson  
Karen J. Gibson, Dodge County Clerk

ADOPTED  
BY DODGE COUNTY BOARD

FEB 17 2016

AYES 29 NOES 0  
ABSENT 3  
ABSTAIN 0

Karen J. Gibson  
County Clerk